

RECORD OF FUNERAL

Woodham

Funeral Records

Compiled by

Robert Earl Woodham

Woodham Family Historian

Founder & President,

Woodham Family Association

Woodham Funeral Records

Holman Funeral Home

Ozark, Alabama

Compiled by

Robert Earl Woodham

Woodham Family Historian

Founder & President,

Woodham Family Association

RECORD OF FUNERAL

Total No. 8 Yearly No. 12 Date of Entry FEBRUARY 12
 Name of Deceased AMBER MACHELLE WOODHAM WHITE
(What Race)
 Married Single Widowed Divorced Husband Wife Widow
 Residence RT. 2, OZARK, AL or _____ of _____ Age of Husband or Wife (If living) _____

Charge to MR. LARRY WOODHAM
 Address RT. 2 BOX OZARK, AL
 Order given by FATHER
 (or informant)

How Secured _____
 If Veteran, Name of War _____
 Occupation _____ (Social Security Number) _____
 Employer and Address _____

Date of Birth _____ Age _____
 (Mo.) (Day) (Yr.) (Yrs.) (Mos.) (Days)
 Birthplace _____
 Date of Death FEB 12 1984
 (Mo.) (Day) (Yr.) (Hour)
 Place of Death DALE COUNTY HOSPITAL

Name of Father LARRY EUGENE WOODHAM
 His Birthplace _____
 Maiden Name of Mother JESSIE DELORES PHILLIPS
 Her Birthplace _____

Date of Funeral FEB 14 TUES 11 A. M.
 (Date) (Day of Week) (Hour)
 Services at GRAVESIDE
 Clergyman G. L. WYNN
 (Address)

Religion of the Deceased _____
 Resided in the State _____ (or U.S. or City or County) (Years) (Months)
 Cause of Death UNKNOWN
 Contributory Causes _____

Certifying Physician B. D. PETREY, MD
 (or Coroner)
 His Address OZARK, AL
 Truck } Remains to _____
 Ship }

Size of Casket 2 1/2 LT. BLUE FULL COUCH METAL
 (State Color and Number)
 Manufactured by COVINGTON
 Cemetery } EWELL
 Crematory }

Lot No. _____
 Grave No. _____
 Section No. _____
 Block No. _____
 Owner _____

Misc. _____



Diagram of Lot or Vault

Complete Funeral (except outlays)	\$
Casket	
Burial Vault or Box	(State Kind)
Embalming Body	(Name of Embalmer)
Misc.	
Dressing Body, \$	Underwear, \$
Suit or Dress	(State Kind and Color)
Slippers, \$	Hose, \$
Folding Chairs, \$	Tarpaulin, \$
Candelabrum, \$	Candles, \$
Door Spray, \$	Gloves, \$
Funeral Car, \$	Ambulance, \$
Limousines to Cemetery @ \$	
Extra Limousines @ \$	
Flower Car @ \$	
Autos to R.R. or Air @ \$	
Getting Remains from	
Taking Remains to	
Trip to Coroner's Inquest	
Misc.	
Removal Charges	
Procuring Burial Permit	(State Number and District)
..... Certif. Copies of Death Certificates No.	(State Physician's or Coroner's)
Pall Bearer Service, \$	Use of Chapel, \$
Gross Total for Sales Tax	\$
Outlay for Lot	
Cremation	
Flowers, \$	Palms, \$
Matting, \$	
Rental of Tent, \$	of Temporary Vault, \$
Opening of Grave or Tomb	
Lining Grave, \$	Lowering Device, \$
Outlay for Shipping Charges	
Clergymen, \$	Singers, \$
Organist, \$	
Railroad } Tickets, \$	Air Service, \$
or Truck }	
Telegr., Phone, Cable or Radio Charges	
Cash Advanced	
Out of town Funeral Director's Charges	
Personal Service	
..... line Death Notices in	Papers
(Names of Newspapers)	
Sales Tax	
Totaling Footing of Bill	\$
Less	\$
Balance	\$
Entered into Ledger, page	or below.

Misc. _____

RECORD OF FUNERAL

Total No. 1573..... Yearly No. 21..... Date Feb. 3..... 1940

Name of Deceased Barton E. Woodham..... W State CO
(Single — Married — Divorced) (What Race) (Where Born)

Residence of Deceased Midland City, Rt 1, Box 8..... Husband—Wife—Widow—
or Widow 49

Charge to.....
 Address.....

Order given by.....
(or informant)

How Secured.....

Occupation of Deceased Farmer.....
(Name of Embalmer)

Name of Employer.....
 Address.....

Date of Death Feb. 3 - 1940..... 9:04 AM
(Date) (Hour)

Date of Birth.....
 Age 56 7 29
(Years) (Months) (Days)

Date of Funeral Feb. 4 - 1940..... 2:30 P. M.
(Date) (Day of Week) (Hour)

Services at Mt. Carmel.....

Clergyman.....
 His Address.....

Religion of the Deceased.....

Resided in the State.....
(U. S. or City or County) (Years) (Months)

Place of Death at home.....

Cause of Death.....

Contributory Causes.....

Certifying Physician Dr. Parrish.....
(or Coroner)

His Address Midland City.....

Name of Father Daniel Woodham.....

His Birthplace State CO.....

Maiden Name of Mother Martha Dwyer.....

Her Birthplace State CO.....

Motor } Remains to
Ship } Size and Style of Casket.....
(State Color)

Manufactured by.....

Interment at Mt. Carmel..... { Cemetery
 Crematory

Lot No.....

Grave No.....

Section No.....

Owner.....



Diagram of Lot or Vault

Complete Funeral.....	\$
Casket.....	
Outside Box.....	
Burial Vault.....	(State Kind)
Embalming Body.....	(State Kind)
Lady Attendant.....	(Name of Embalmer)
Barber, \$.....	Hair Dressing, \$.....
Dressing Body, \$.....	Underwear, \$.....
Suit or Dress \$.....	Slippers \$..... Hose \$.....
Folding Chairs, \$.....	Tarpaulin, \$.....
Candelabrum, \$.....	Candles, \$.....
Door Spray, \$.....	Gloves, \$.....
Funeral Car, \$.....	Ambulance, \$.....
Limousines to Cemetery.....	@ \$.....
Autos to R. R. Station.....	@ \$.....
Getting Remains from.....	
Taking Remains to.....	
Trip to Coroner's Inquest.....	
Delivering Box to.....	
Deliver Flowers to.....	
Removal Charges.....	
Procuring Burial Permit.....	
___ Certif. Copies of Death Certificates No.....	(State Number and District)
Pall Bearer Service, \$.....	Use of Chapel, \$.....
Personal Service.....	
Gross Total for Sales Tax.....	\$
Outlay for Lot.....	
Cremation.....	
..... line Death Notices in..... Papers	
Flowers, \$.....	(Names of Newspapers) Palms, \$..... Matting, \$.....
Rental of Tent, \$.....	of Temporary Vault, \$.....
Opening of Grave or Tomb.....	
Lining Grave, \$.....	Lowering Device, \$.....
Outlay for Shipping Charges.....	
Clergyman, \$.....	Singers, \$..... Organist, \$.....
Railroad } Tickets, \$.....	Aero-plane Service, \$.....
or Motor }	
Telegr., Phone, Cable or Radio Charges.....	
Cash Advanced.....	
Out of town Undertaker's Charges.....	
Sales Tax.....	
Total Footing of Bill.....	\$
Less.....	\$
Balance.....	\$
Entered into Ledger, page.....	or below.

RECORD OF FUNERAL

Total No. Yearly No. 32 Date of Entry Feb. 22 - Sat.
 Name of Deceased Buna Elizabeth Woodham White
 Married Single Widowed Divorced (What Race)
 Residence: Enfanta St. Oak, Ala. Husband Wife Widow }
 or of } Age of Husband or Wife (if living)

Charge to:
 Address:
 Order given by Mrs. R. V. Knight
 (or informant)
 How Secured:
 If Veteran, Name of War:
 Occupation Housewife 433-50-3881
 (Social Security Number)
 Employer and Address:
 Date of Death Feb. 22 - Sat. 1958
 (Mo.) (Day) (Yr.) (Hour)
 Date of Birth Jan. 17, 1894 Age 64
 (Mo.) (Day) (Yr.) (Mos.) (Days)
 Services at Oak Baptist Church
 Clergyman S. Don Miley (address)
 Religion of the Deceased Baptist
 Birthplace Dale Co. Alabama
 Resided in the State Dale Co. 64
 (of U. S. or City or County) (Years) (Months)
 Place of Death Dale Co.
 Cause of Death:
 Contributory Causes:

225-57
 Certifying Physician G. R. Smith
 (or Coroner)
 His Address: Oak, Alabama
 Name of Father Westley Warr
 His Birthplace:
 Maiden Name of Mother Frances Paramore
 Her Birthplace:
 Date of Funeral Feb. 24 - Mon 11 A. M.
 (Date) (Day of Week) (Hour)
 Motor } Remains to
 Ship }
 Size of Casket Calhoun 1/2 c. By + coputon
 (State Color and Number)

Manufactured by:
 Cemetery } Morning View
 Crematory }
 Lot No.
 Grave No.
 Section No.
 Block No.
 Owner J. D. ...

Miscellaneous 36-58 Helen Grace

Complete Funeral (except outlays)	\$
Casket	
Burial Vault or Box	
Embalming Body <u>J. H. D.</u> (Name of Embalmer)	
Barber, \$	Hair Dressing, \$
Dressing Body, \$	Underwear, \$
Suit or Dress	(State Kind and Color)
Slippers, \$	Hose, \$
Folding Chairs, \$	Tarpaulin, \$
Candelabrum, \$	Candles, \$
Door Spray, \$	Gloves, \$
Funeral Car, \$	Ambulance, \$
Limousines to Cemetery	@ \$
Extra Limousines	@ \$
Autos to R. R. Station	@ \$
Getting Remains from	
Taking Remains to	
Trip to Coroner's Inquest	
Delivering Box to	
Deliver Flowers to	
Removal Charges	
Procuring Burial Permit	(State Number and District)
Certif. Copies of Death Certificates No.	(State Physician's or Coroner's)
Pall Bearer Service, \$	Use of Chapel, \$
Gross Total for Sales Tax	\$
Outlay for Lot	
Cremation	
Flowers, \$	Palms, \$
Rental of Tent, \$	of Temporary Vault, \$
Opening of Grave or Tomb	
Lining Grave, \$	Lowering Device, \$
Outlay for Shipping Charges	
Clergyman, \$	Singers, \$
Organist, \$	
Railroad } Tickets, \$	Aero-plane Service, \$
or Motor }	
Telegr., Phone, Cable or Radio Charges	
Cash Advanced	
Out of town Funeral Director's Charges	
Personal Service	
line Death Notices in	Papers
(Names of Newspapers)	
Sales Tax	
Total Footing of Bill	\$
Less	\$
Balance	\$
Entered into Ledger, page	or below.
Miscellaneous	

RECORD OF FUNERAL

Total No. _____ Yearly No. 176 Date of Entry Oct 7 Thursday
 Name of Deceased Cammie Lee Woodham W
(What Sex)
 Married Single Widowed Divorced
 Husband Wife Widow }
 Residence Midland City, Ala. Rt 1 or _____ of _____ Age of Husband or Wife (if living) _____

Charge to Myrtle Woodham - wife
 Address M. C. Rt 1
 Order given by wife (or Informant)

How secured _____
 If Veteran, Name of War no
 Occupation Printer 424-14-4522
 (Social Security Number)

Employer and Address _____
 Date of Death Oct 7 1971
 Date of Birth April 28 1913 Age 58
 Name of Father Maurice Woodham

His Birthplace _____
 Maiden Name of Mother Mollie Marshall
 Her Birthplace _____

Date of Funeral 10-9-71 Sat 3P. M.
 Services at Mt. Carmel
 Clergyman Crutchfield & Armstrong
 Religion of the Deceased Methodist

Birthplace Dale County
 Resided in the State Dale County
 Place of Death Dale County Hospital

Cause of Death _____
 Contributory Causes _____
 Certifying Physician Holman & Gunstien
 (or Coroner)

His Address _____
 Motor } Remains to _____
 Ship }
 Size of Casket Calhoun Silver & C
 (State Color and Number)

Manufactured by Brown Sewice
 Cemetery } Mt. Carmel
 Crematory }

Lot No. _____
 Grave No. _____
 Section No. _____
 Block No. _____
 Owner _____

Misc. Augusta Reeves
10-26-71

Complete Funeral (except outlays) \$ _____
 Casket _____
 Burial Vault or Box _____ (State Kind)
 Embalming Body C. S. (Name of Embalmer)
 Barber, \$ _____ Hair Dressing, \$ _____
 Dressing Body, \$ _____ Underwear, \$ _____
 Suit or Dress _____ (State Kind and Color)
 Slippers, \$ _____ Hose, \$ _____
 Folding Chairs, \$ _____ Tarpaulin, \$ _____
 Candelabrum, \$ _____ Candles, \$ _____
 Door Spray, \$ _____ Gloves, \$ _____
 Funeral Car, \$ _____ Ambulance, \$ _____
 Limousines to Cemetery @ \$ _____
 Extra Limousines @ \$ _____
 Autos to R. R. Station @ \$ _____
 Getting Remains from _____
 Taking Remains to _____
 Trip to Coroner's Inquest _____
 Delivering Box to _____
 Deliver Flowers to _____
 Removal Charges _____
 Procuring Burial Permit _____ (State Number and District)
 Certif. Copies of Death Certificates No. _____ (State Physician's or Coroner's)
 Pall Bearer Service, \$ _____ Use of Chapel, \$ _____
 Gross Total for Sales Tax \$ _____
 Outlay for Lot _____
 Cremation _____
 Flowers, \$ _____ Palms, \$ _____ Matting, \$ _____
 Rental of Tent, \$ _____ of Temporary Vault, \$ _____
 Opening of Grave _____ Tomb _____
 Lining Grave, \$ _____
 Outlay for Shroud _____
 Clergymen, \$ _____
 Railroad }
 or Motor }
 Telegr., Phon _____
 Cash Adv _____
 Out of tow _____
 Personal S _____
 _____ line _____
 (Names of)
 Sales _____
 Total _____
 Less _____
 En _____
 Misc. _____

C. L. WOODHAM
MIDLAND CITY - Cammie
Lee Woodham, 58, of Midland
City, Route One, died at his
home Thursday afternoon, Oc-
tober 7 from an apparent heart

Funeral services were held
 at 3:00 p.m. Saturday, October
 9 from the Mt. Carmel
 Methodist Church, with the
 Revs. W. R. Crutchfield and
 Harvey Hartzog officiating.
 Interment followed in the
 church cemetery with Holman
 Funeral Home directing.
 Survivors include his wife,
 Mrs. Myrtle Woodham, of Mid-
 land City; two sons, Jerry and
 Olen Woodham, both of Mid-
 land City; three brothers, Per-
 ry and Ovie Woodham, both
 of Midland City, and James
 Woodham, Route Three, Ozark.

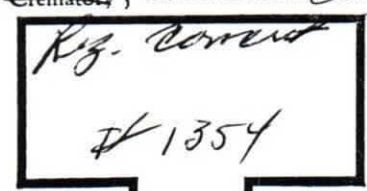

Diagram of Lot or Vault

RECORD OF FUNERAL

Total No. _____ Yearly No. 190

Date of Entry 20 December 1966

Name of Deceased Carl Woodburn
 Married Single Widowed Divorced

Husband Wife Widow } _____
 or _____ of } Age of Husband or Wife (if living) _____

Residence Opelika, Ala.

Charge to Funeral Home

Address Opelika, Ala.

Order given by Lucas Stiles
(or informant)

How secured _____

If Veteran, Name of War NA

Occupation Financial Director 430-12-625
(Social Security Number)

Employer and Address Self

Date of Death Jan 10, 1966

Date of Birth Feb 4, 1887 Age 79
(Mo.) (Day) (Yr.) (Hour) (Mo.) (Day) (Yr.) (Yrs.) (Mos.) (Days)

Name of Father John Woodburn

His Birthplace Ala.

Maiden Name of Mother Anna Hill

Her Birthplace _____

Date of Funeral Jan 12, 1966 2 P.M.
(Date) (Day of Week) (Hour)

Services at Chapel Hill Baptist

Clergyman Paul Williams
(Address)

Religion of the Deceased Baptist

Birthplace Wheeler County

Resided in the State Alabama
(or U.S. or City or County) (Years) (Months)

Place of Death Bethel, Ala.

Cause of Death _____

Contributory Causes _____

Certifying Physician Dr. James L. King
(or Coroner)

His Address _____

Motor } Remains to
 Ship } _____

Size of Casket Standard
(State Color and Number)

Manufactured by Standard

Cemetery } Chapel Hill
 Crematory }



Lot No. _____

Grave No. _____

Section No. _____

Block No. _____

Owner _____

Misc. Lines - 12-24-66

Complete Funeral (except outlays)	\$ _____
Casket	
Burial Vault of Box	
Embalming Body <u>M. J. ...</u> <small>(State Kind) (Name of Embalmer)</small>	
Barber, \$ _____ Hair Dressing, \$ <u>Bill</u>	
Dressing Body, \$ _____ Underwear, \$ _____	
Suit or Dress <u>State Kind and Color</u>	
Slippers, \$ _____ Hose, \$ _____	
Folding Chairs, \$ _____ Tarpaulin, \$ _____	
Candelabrum, \$ _____ Candles, \$ _____	
Door Spray, \$ _____ Gloves, \$ _____	
Funeral Car, \$ _____ Ambulance, \$ _____	
Limousines to Cemetery @ \$ _____	
Extra Limousines @ \$ _____	
Autos to R. R. Station @ \$ _____	
Getting Remains from _____	
Taking Remains to _____	
Trip to Coroner's Inquest _____	
Delivering Box to _____	
Deliver Flowers to _____	
Removal Charges _____	
Procuring Burial Permit _____	
Certif. Copies of Death Certificates No. _____ <small>(State Number and District) (State Physician's or Coroner's)</small>	
Pall Bearer Service, \$ _____ Use of Chapel, \$ _____	
Gross Total for Sales Tax _____	\$ _____
Outlay for Lot _____	
Cremation _____	
Flowers, \$ _____ Palms, \$ _____ Matting, \$ _____	
Rental of Tent, \$ _____ of Temporary Vault, \$ _____	
Opening of Grave or Tomb _____	
Lining Grave, \$ _____ Lowering Device, \$ _____	
Outlay for Shipping Charges _____	
Clergymen, \$ _____ Singers, \$ _____ Organist, \$ _____	
Railroad } Tickets, \$ _____ Aero- or Motor } plane Service, \$ _____	
Telegr., Phone, Cable or Radio Charges _____	
Cash Advanced _____	
Out of town Funeral Director's Charges _____	
Personal Service _____	
_____ line Death Notices in _____ Papers	
<small>(Names of Newspapers)</small>	
Sales Tax _____	
Total Footing of Bill _____	\$ _____
Less _____	\$ _____
Balance _____	\$ _____
Entered into Ledger, page _____ or below.	
Misc. _____	

RECORD OF FUNERAL

Total No. _____ Yearly No. 155 Date of Entry Oct. 6 Thurs 1966
 Name of Deceased Cora Bartlett Woodham W
 Married Single Widowed Divorced Husband Wife Widow } (What Race)
 Residence Ozark, Ala. or _____ of _____ Age of Husband or Wife (if living) _____

Charge to _____
 Address _____
 Order given by Dellia Stubbs
 (or informant)
 How Secured _____
 If Veteran, Name of War no
 Occupation Housewife (Social Security Number) _____
 Employer and Address _____
 Date of Death Oct 6 Thurs 1966
 Date of Birth Oct 6 - 1891 Age 75
 Name of Father John Bartlett
 His Birthplace _____
 Maiden Name of Mother Dellia Potts
 Her Birthplace _____
 Date of Funeral Oct 7 Fri 3 P.M.
 Services at Chalk Head Baptist
 Clergyman Fred Williams - RR Nabersville
 Religion of the Deceased Baptist (Address) _____
 Birthplace Dale Co. Alabama
 Resided in the State Ozark, Ala.
 Place of Death Dale Co. Hospital
 Cause of Death Cancer
 Contributory Causes metastasis of chest fracture pelvis of left hip.
 Certifying Physician D. J. Felton
 (or Coroner)
 His Address Ozark, Ala.
 Motor Ship } Remains to _____
 Size of Casket Cathem 1/2 C - Silver
 (State Color and Number)
 Manufactured by _____
 Cemetery } Chalk Head
 Crematory }

Complete Funeral (except outlays) \$ _____
 Casket _____
 Burial Vault or Box _____
 Embalming Body _____ (State Kind) AD
 (Name of Embalmer)
 Barber, \$ _____ Hair Dressing, \$ _____
 Dressing Body, \$ _____ Underwear, \$ _____
 Suit or Dress _____ (State Kind and Color)
 Slippers, \$ _____ Hose, \$ _____
 Folding Chairs, \$ _____ Tarpaulin, \$ _____
 Candelabrum, \$ _____ Candles, \$ _____
 Door Spray, \$ _____ Gloves, \$ _____
 Funeral Car, \$ _____ Ambulance, \$ _____
 Limousines to Cemetery @ \$ _____
 Extra Limousines @ \$ _____
 Autos to R. R. Station @ \$ _____
 Getting Remains from _____
 Taking Remains to _____
 Trip to Coroner's Inquest _____
 Delivering Box to _____
 Deliver Flowers to _____
 Removal Charges _____
 Procuring Burial Permit _____ (State Number and District)
 _____ Certif. Copies of Death Certificates No. _____
 (State Physician's or Coroner's)
 Pall Bearer Service, \$ _____ Use of Chapel, \$ _____
 Gross Total for Sales Tax \$ _____
 Outlay for Lot _____
 Cremation _____
 Flowers, \$ _____ Palms, \$ _____ Matting, \$ _____
 Rental of Tent, \$ _____ of Temporary Vault, \$ _____
 Opening of Grave or Tomb _____
 Lining Grave, \$ _____ Lowering Device, \$ _____
 Outlay for Shipping Charges _____
 Clergymen, \$ _____ Singers, \$ _____ Organist, \$ _____
 Railroad { Tickets, \$ _____ Aero-
 or Motor { plane Service, \$ _____
 Telegr., Phone, Cable or Radio Charges _____
 Cash Advanced _____
 Out of town Funeral Director's Charges _____
 Personal Service _____
 _____ line Death Notices in _____ Papers _____
 (Names of Newspapers)

Lot No. _____
 Grave No. _____
 Section No. _____

Sales Tax _____
 Total Fee _____
MRS. CORA BARTLETT WOODHAM \$ _____

10-6-62

Date of Death Oct 6, 1966
 Date of Birth Oct 6, 1891 Age 75
 Name of Father John Bartlett
 His Birthplace _____
 Maiden Name of Mother Della Potts
 Her Birthplace _____
 Date of Funeral Oct 7 Fri
 Services at Chalk Head Baptist
 Clergyman Fred Williams - H.R. Naberhuis
 Religion of the Deceased Baptist
 Birthplace Dale Co. Alabama
 Resided in the State Ozark, Mo.
 Place of Death Dale Co. Hospital
 Cause of Death Cancer
 Contributory Causes nerve tention of chest
fracture of pelvis of left hip.
 Certifying Physician Dr. Felber
 His Address Ozark, Ala.
 Motor Ship } Remains to _____
 Size of Casket Cathman 1/2 C - Silver
 Manufactured by _____
 Cemetery } Chalk Head
 Crematory }

Lot No. _____
 Grave No. _____
 Section No. _____
 Block No. _____
 Owner _____
 Misc. Filed 10-18-66

Date	Amount Paid	Balance	Date
	To Above Balance	\$	
	By Payment	\$	
	" "	\$	
	" "	\$	
	" "	\$	
	" "	\$	

Insurance \$ _____ Names of Lodges _____
 I hereby authorize the above Funeral, and I hereby represent that I have sufficient resources for the payment of aforesaid sum, and I hereby covenant and agree to pay the same within maturity at the rate of _____ % per annum.
 Witness _____ Signed _____
 Address _____

Folding Chairs, \$ _____ I arpaum, \$ _____
 Candelabrum, \$ _____ Candles, \$ _____
 Door Spray, \$ _____ Gloves, \$ _____
 Funeral Car, \$ _____ Ambulance, \$ _____
 Limousines to Cemetery @ \$ _____
 Extra Limousines @ \$ _____
 Autos to R. R. Station @ \$ _____
 Getting Remains from _____
 Taking Remains to _____
 Trip to Coroner's Inquest _____
 Delivering Box to _____
 Deliver Flowers to _____
 Removal Charges _____
 Procuring Burial Permit _____
 Certif. Copies of Death Certificates No. _____
 Pall Bearer Service, \$ _____ Use of Chapel, \$ _____
 Gross Total for Sales Tax \$ _____
 Outlay for Lot _____
 Cremation _____
 Flowers, \$ _____ Palms, \$ _____ Matting, \$ _____
 Rental of Tent, \$ _____ of Temporary Vault, \$ _____
 Opening of Grave or Tomb _____
 Lining Grave, \$ _____ Lowering Device, \$ _____
 Outlay for Shipping Charges _____
 Clergymen, \$ _____ Singers, \$ _____ Organist, \$ _____
 Railroad or Motor Tickets, \$ _____ Aero-plane Service, \$ _____
 Telegr., Phone, Cable or Radio Charges _____
 Cash Advanced _____
 Out of town Funeral Director's Charges _____
 Personal Service _____

_____ line Death Notices in _____ Papers
 (Names of Newspapers) _____
 Sales Tax _____
 Total Fee _____
 Less _____
 Entered in _____
 Misc. _____

MRS. CORA BARTLETT WOODHAM
 OZARK - Mrs. Cora Bartlett Woodham, 75, died Thursday, Oct. 6, in Dale County Hospital following a long illness.

Funeral services were held at 3:00 Friday afternoon at Chalk Head Baptist Church with Rev. Fred Williams and Rev. H. R. Naberhuis officiating.

Interment in the church cemetery was directed by Holman Funeral Home.

Survivors are her husband, Carl Woodham, Ozark; three daughters, Mrs. Loamus Stubbs, Ozark, Mrs. Elon Summerlin and Mrs. Lottie Broome, both of South Bay, Fla.; three sons, J. D. Woodham, Headland, Burman Woodham and Howard Woodham, both of South Bay, Fla.; one brother, Dewey Bartlett, Dothan; several grandchildren.

Paid	Balance
\$	
\$	
\$	
\$	
\$	
\$	

RECORD OF FUNERAL

Total No. _____ Yearly No. 190 Date of Entry 20 December 1966

Name of Deceased Carl Otis Woodham (What Race) _____
 Married Single Widowed Divorced
 Husband Wife Widow }
 Residence Ozark, Ala or _____ of } Age of Husband or Wife (if living) _____ Yea

Charge to Romanus Stubbs
 Address Ozark Ala
 Order given by Romanus Stubbs (or informant)
 How secured _____
 If Veteran, Name of War NA
 Occupation Farmhand Retired 420-12-6335 (Social Security Number)
 Employer and Address Self
 Date of Death Dec 18 - 1966 (Mo.) (Day) (Yr.) (Hour)
 Date of Birth Feb 4 1887 Age 78 (Mo.) (Day) (Yr.) (Yrs.) (Mos.) (Days)
 Name of Father John Wesley Woodham
 His Birthplace Dale Co
 Maiden Name of Mother Almeda Holbe
 Her Birthplace _____
 Date of Funeral 21 Wed 2 P.M. (Date) (Day of Week) (Hour)
 Services at Chalkhead Baptist
 Clergyman Fred Williams (Address)
 Religion of the Deceased Baptist
 Birthplace Dale county
 Resided in the State Alabama (or U.S. or City or County) (Years) (Months)
 Place of Death Belle Glade Fla
 Cause of Death _____
 Contributory Causes _____

Certifying Physician Dr James Gray (or Coroner)
 His Address _____

Motor } Remains to
 Ship }
 Size of Casket Size H S C (State Color and Number)
 Manufactured by Standard
 Cemetery } Chalkhead
 Crematory }



Lot No. _____
 Grave No. _____
 Section No. _____
 Block No. _____
 Owner _____

Misc. Filed - 12-24-66

Complete Funeral (except outlays).....	\$ _____
Casket.....	
Burial Vault of Box.....	
Embalming Body <u>Mix son</u> (State Kind) <u>Funeral Home</u> (Name of Embalmer)	
Barber, \$..... Hair Dressing, \$..... <u>Belle Glade</u>	
Dressing Body, \$..... Underwear, \$..... <u>Flora</u>	
Suit or Dress..... (State Kind and Color)	
Slippers, \$..... Hose, \$.....	
Folding Chairs, \$..... Tarpaulin, \$.....	
Candelabrum, \$..... Candles, \$.....	
Door Spray, \$..... Gloves, \$.....	
Funeral Car, \$..... Ambulance, \$.....	
Limousines to Cemetery @ \$.....	
Extra Limousines @ \$.....	
Autos to R. R. Station @ \$.....	
Getting Remains from.....	
Taking Remains to.....	
Trip to Coroner's Inquest.....	
Delivering Box to.....	
Deliver Flowers to.....	
Removal Charges.....	
Procuring Burial Permit..... (State Number and District)	
..... Certif. Copies of Death Certificates No. (State Physician's or Coroner's)	
Pall Bearer Service, \$..... Use of Chapel, \$.....	
Gross Total for Sales Tax.....	\$ _____
Outlay for Lot.....	
Cremation.....	
Flowers, \$..... Palms, \$..... Matting, \$.....	
Rental of Tent, \$..... of Temporary Vault, \$.....	
Opening of Grave or Tomb.....	
Lining Grave, \$..... Lowering Device, \$.....	
Outlay for Shipping Charges.....	
Clergymen, \$..... Singers, \$..... Organist, \$.....	
Railroad } Tickets, \$..... Aero- plane Service, \$..... or Motor }	
Telegr., Phone, Cable or Radio Charges.....	
Cash Advanced.....	
Out of town Funeral Director's Charges.....	
Personal Service.....	
..... line Death Notices in Papers (Names of Newspapers)	
Sales Tax.....	
Total Footing of Bill.....	\$ _____
Less.....	\$ _____
Balance.....	\$ _____
Entered into Ledger, page..... or below.	
Misc.....	

RECORD OF FUNERAL

Total No. 2 Yearly No. 51 Date of Entry NOVEMBER 11 19 83

Name of Deceased CHARLIE LUTHER WOODHAM WHITE
(What Race)

Residence ROUTE 3, OZARK, AL Husband Wife Widow } JULIE DELL BAGWELL
or of } Age of Husband or Wife (If living) _____ Years

Charge to MRS. JULIE WOODHAM

Address SAME AS ABOVE

Order given by WIFE
(or informant)

How Secured _____

If Veteran, Name of War _____

Occupation RET. FARMER 411-36-3111
(Social Security Number)

Employer and Address _____

Date of Birth MAY 17, 1898 Age 85
(Mo.) (Day) (Yrs.) (Mos.) (Days)

Birthplace DALE COUNTY

Date of Death NOV. 11, 1983 P.M.
(Mo.) (Day) (Yr.) (Hour)

Place of Death BROOKWOOD MED. CENTER, EUFALA

Name of Father GILLIAM DAVID WOODHAM

His Birthplace _____

Maiden Name of Mother ANNIE LENORA PEACOCK

Her Birthplace _____

Date of Funeral NOV. 13 SUN. 2 P. M.
(Date) (Day of Week) (Hour)

Services at MT. CARMEL UNITED METHODIST

Clergyman REV. RON JACKSON
(Address)

Religion of the Deceased _____

Resided in the State _____
(or U.S. or City or County) (Years) (Months)

Cause of Death _____

Contributory Causes _____

Certifying Physician DR. OAKLEY
(or Coroner)

His Address EUFALA, AL

Truck } Remains to _____
Ship }

Size of Casket 120 P.H.C COPPERTONE 2 P.G.A
(State Color and Number)

Manufactured by COVINGTON # 8601

Cemetery } MT. CARMEL
Crematory }

Misc. _____

Complete Funeral (except outlays)	\$
Casket	
Burial Vault or Box	
Embalming Body <u>LES</u> (State Kind)	
Misc. (Name of Embalmer)	
Dressing Body, \$	Underwear, \$
Suit or Dress	
Slippers, \$	Hose, \$
Folding Chairs, \$	Tarpaulin, \$
Candelabrum, \$	Candles, \$
Door Spray, \$	Gloves, \$
Funeral Car, \$	Ambulance, \$
Limousines to Cemetery @ \$	
Extra Limousines @ \$	
Flower Car @ \$	
Autos to R.R. or Air @ \$	
Getting Remains from	
Taking Remains to	
Trip to Coroner's Inquest	
Misc.	
Removal Charges	
Procuring Burial Permit	
_____ Certif. Copies of Death (Stat)	
Pall Bearer Service, \$	
Gross Total for Sales Tax	
Outlay for Lot	
Cremation	
Flowers, \$	Palms, \$
Rental of Tent, \$	of Ten
Opening of Grave or Tomb	
Lining Grave, \$	Lower
Outlay for Shipping Charges	
Clergymen, \$	Singers, \$
Railroad } Tickets, \$	
or Truck }	
Telegr., Phone, Cable or Radio	
Cash Advanced	
Out of town Funeral Director's	
Personal Service	
_____ line Death Notices in	
(Names of Newspapers)	
Sales Tax	
Totaling Footing of Bill	\$
Less	\$
Balance	\$
Entered into Ledger, page	or below.

CHARLIE L. WOODHAM
OZARK—Charlie L. Woodham, 85, of Rt. 3, Ozark, died Friday afternoon, Nov. 11 in a Eufaula hospital following an extended illness.

Funeral services were held at 2 p.m. Sunday from the Mt. Carmel United Methodist Church with the Rev. Ron Jackson officiating. Burial followed in the church cemetery with Holman Funeral Home of Ozark directing.

Mr. Woodham was a native of Dale County and a retired farmer. He is survived by his wife, Mrs. Julie Dell Woodham of Rt. 3, Ozark; two sisters, Mrs. Priscilla Griggs and Mrs. Mary Morott, both of Ozark; three brothers, Joseph Woodham, Rt. 3, Ozark Perry Woodham, Tuskegee and John Woodham, Montgomery; several nieces and nephews also survive.



Diagram of Lot or Vault

Lot No. _____

Grave No. _____

Section No. _____

Block No. _____

Owner _____

Misc. _____

Misc. _____

RECORD OF FUNERAL

7c

Form fields for funeral record including: Total No., Yearly No., Date of Entry, Name of Deceased, Residence, Charge to, Address, Order given by, How Secured, If Veteran, Name of War, Occupation, Employer and Address, Date of Death, Date of Birth, Services at, Clergyman, Religion of the Deceased, Birthplace, Resided in the State, Place of Death, Cause of Death, Contributory Causes, Certifying Physician, His Address, Name of Father, His Birthplace, Maiden Name of Mother, Her Birthplace, Date of Funeral, Motor or Ship, Size of Casket, Manufactured by, Cemetery/Crematory, Lot No., Grave No., Section No., Block No., Owner, Miscellaneous.

Table for funeral expenses including: Complete Funeral (except outlays), Casket, Burial Vault or Box, Embalming Body, Barber, Dressing Body, Suit or Dress, Slippers, Folding Chairs, Candelabrum, Door Spray, Funeral Car, Limousines to Cemetery, Extra Limousines, Autos to R. R. Station, Getting Remains from, Taking Remains to, Trip to Coroner's Inquest, Delivering Box to, Deliver Flowers to, Removal Charges, Procuring Burial Permit, Certif. Copies of Death Certificates, Pall Bearer Service, Gross Total for Sales Tax, Outlay for Lot, Cremation, Flowers, Palms, Matting, Rental of Tent, Opening of Grave or Tomb, Lining Grave, Lowering Device, Outlay for Shipping Charges, Clergyman, Singers, Organist, Railroad or Motor Tickets, Aero-plane Service, Telegr., Phone, Cable or Radio Charges, Cash Advanced, Out of town Funeral Director's Charges, Personal Service, line Death Notices in Papers, Sales Tax, Total Footing of Bill, Less, Balance, Entered into Ledger, page or below, Miscellaneous.

RECORD OF FUNERAL

Form No. 13 Yearly No. 30 Date of Entry Mon. 18 Feb. 1974

Name of Deceased Dolphus Wilkerson Woodham (What Race) W

Married Single Widowed Divorced
 Husband Wife Widow }
or _____ of _____ Age of Husband or Wife (If living) _____

Residence Midland city, Ala. Rt 1

Charge to Ida Woodham

Address Midland city, Ala. Rt 1

Order given by Ida Woodham (or informant)

How Secured _____

If Veteran, Name of War WW2

Occupation Construction 417-22-3479 (Social Security Number)

Employer and Address _____

Date of Birth Dec 18 1916 Age 57

Birthplace Dale Co., Ala.

Date of Death Feb 15 Mon 1974

Place of Death Dale Co. Hospital (Hour) _____

Name of Father Barton Woodham

His Birthplace _____

Maiden Name of Mother Eva Pistor

Her Birthplace _____

Date of Funeral Feb 20 Wed. 3:30 P.M.

Services at Mt. Carmel Meth. Church

Clergyman _____

Religion of the Deceased Methodist (Address) _____

Resided in the State Dale Co. (or U.S. or City or County) (Years) (Months)

Cause of Death _____

Contributory Causes _____

Certifying Physician N. W. Hoffman (or Coroner)

His Address Ozark, Ala.

Truck } Remains to _____
Ship }

Size of Casket M. W. M. Senior (State Color and Number)

Manufactured by Major Cashley Co

Cemetery } Mt. Carmel
Crematory }

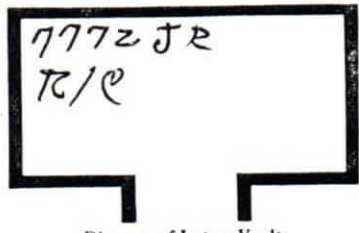

Diagram of Lot or Vault

Lot No. _____
Grave No. _____
Section No. _____
Block No. _____
Owner _____

Misc. _____

Complete Funeral (except outlays)	\$
Casket	
Burial Vault or Box	
Embalming Body	(State Kind) <u>East L. C.</u> (Name of Embalmer)
Misc.	
Dressing Body, \$	Underwear, \$
Suit or Dress	(State Kind and Color)
Slippers, \$	Hose, \$
Folding Chairs, \$	Tarpaulin, \$
Candelabrum, \$	Candles, \$
Door Spray, \$	Gloves, \$
Funeral Car, \$	Ambulance, \$
Limousines to Cemetery	@ \$
Extra Limousines	@ \$
Flower Car	@ \$
Autos to R.R. or Air	@ \$
Getting Remains f:	
Taking Remains to	
Trip to Coroner's l	
Misc.	
Removal Charges	
Procuring Burial Pl	
..... Certif. Copie	
Pall Bearer Service,	
Gross Total for Sab	\$
Outlay for Lot	
Cremation	
Flowers, \$	Pa
Rental of Tent, \$	
Opening of Grave o	
Lining Grave, \$	
Outlay for Shipping	
Clergymen, \$	
Railroad } Ticket	
or Truck }	
Telegr., Phone, Cabl	
Cash Advanced	
Out of town Funer	
Personal Service	
..... line Death No	
(Names of Newspapers)	
Sales Tax	
Totaling Footing of Bill	\$
Less	\$
Balance	\$
Entered into Ledger, page	or below.
Misc.	

DOLPHUS W. WOODHAM
MIDLAND CITY — Dol-
phus W. Woodham, 56, of
Midland City, Rt. 1, died in
the Dale County Hospital
Monday night following an
apparent heart attack.

Funeral services will be
held at 3:30 p.m. Wednesday
from Mt. Carmel Methodist
Church. Interment in the
church cemetery with Hol-
man Funeral Home in
charge.

Mr. Woodham was a life
long resident of Dale County
and a veteran of World War.

Survivors include his wife,
Mrs. Ida Woodham of Mid-
land City, Rt. 1; one daugh-
ter, Mrs. Linda Jenkins of f
Midland City, Rt. 1; one son,
David Woodham of Clio; two
brothers, Lewis Woodham of
Ozark, Davis Woodham of
Dothan; one sister, Mrs.
Ruth Balkcom of Rt. 1, Mid-
land City. Two grandchildren
also survive.

RECORD OF FUNERAL

No. 235

Total No. MONTH 11 Yearly No. 101 Date of Entry June 14 1977

Name of Deceased Ella Nancy Woodham
 Married Single Widowed Divorced

Residence 21 Chalker Dr., Ozark, Al.
 Husband Wife Widow Hillary Hopewell Wood (What Race)
 or _____ of _____ Age of Husband or Wife (If living) _____ Years

Charge to Mr. L. B. Woodham
 Address 404 N. Alice Dothan, Al.

Order given by above
 How Secured _____ (or informant)

If Veteran, Name of War _____

Occupation Housewife 424-24-0195
 (Social Security Number)

Employer and Address _____

Date of Birth Oct 21 1885 Age 91
 (Mo.) (Day) (Yr.) (Yrs.) (Mos.) (Days)

Birthplace Henry County, Alabama

Date of Death June 14 1977
 (Mo.) (Day) (Yr.) (Hour)

Place of Death Dale County Hospital

Name of Father William Wesley Peebles
 His Birthplace _____

Maiden Name of Mother Alicie Wilkinson
 Her Birthplace _____

Date of Funeral June 15 Wed 4:00 P.M.
 (Date) (Day of Week) (Hour)

Services at Holman Chapel
 Clergyman Rev. G. L. Wynn, Ira Jones
 (Address)

Religion of the Deceased _____

Resided in the State _____ (or U.S. or City or County) (Years) (Months)

Cause of Death _____

Contributory Causes _____

Certifying Physician R. Q. McLaughlin, M.D.
 (or Coroner)

His Address _____
 Truck } Remains to _____
 Ship }

Size of Casket Solid Copper
 (State Color and Number)

Manufactured by National Casket Co.
 Cemetery } Old Center, Henry Co.
 Crematory }



Diagram of Lot or Vault

Lot No. _____
 Grave No. _____
 Section No. _____
 Block No. _____
 Owner _____

Misc. _____

Complete Funeral (except outlays)	\$	
Casket		
Burial Vault or Box	(State Kind)	
Embalming Body	(Name of Embalmer) <u>T.S.</u>	
Misc. _____		
Dressing Body, Suit or Dress	Mrs. Ella Woodham	
Slippers, \$	Mrs. Ella Woodham, 91,	
Folding Chairs	of Chalker Dr., Ozark, died	
Candelabrum,	in the Dale County Hospital	
Door Spray, \$	Tuesday morning following	
Funeral Car, \$	an extended illness.	
Limousines to	Funeral services will be	
Extra Limousine	held Wednesday at 4 p.m.	
Flower Car	from the Holman Funeral	
Autos to R.R.	Home Chapel with the Rev.	
Getting Remains	G. L. Wynn officiating.	
Taking Remains	Interment will follow in the	
Trip to Coroners	Old Center United Metho-	
Misc. _____	dist Cemetery with Holman	
Removal Charge	Funeral Home of Ozark in	
Procuring Burial	charge.	
_____ Certif. C. _____	Mrs. Woodham's body	
	will lie in state at the	
	Funeral Home until Funer-	
	al services this afternoon.	
Pall Bearer Service	Survivors include three	
Gross Total for	daughters, Mrs. Alice Tew,	\$
Outlay for Lot	Louisville, Mrs. Pauline	
Cremation	Henderson, Hollywood,	
Flowers, \$	Fla., and Mrs. Irene	
Rental of Tent,	Armstrong, Stonemoun-	
Opening of Grave	tain, Ga.; three sons, Leslie	
Lining Grave, \$	B. Woodham, Dothan,	
Outlay for Ship	Gerald W. (Bud) Woodham	
Clergymen, \$	of Brooksville, Fla., and	
Railroad } _____	Jack H. Woodham, Hia-	
or Truck } _____	leah, Fla.; 13 grandchild-	
Telegr., Phone, _____	ren, 25 great grandchildren	
Cash Advanced	and several great great	
Out of town Funerals	grandchildren, several nie-	
Personal Service	ces and nephews also	
_____ line Death _____	survive.	
(Names of Newspapers)		
Sales Tax		
Totaling Footing of Bill	\$	
Less	\$	
	Balance	\$
Entered into Ledger, page	or below.	

Misc. OPR/6-16-77

RECORD OF FUNERAL

Total No. Yearly No. 15 Date of Entry Tues. Jan. 31 1961

Name of Deceased Annie L. Woodham
 Married Single Widowed Divorced (What Race)

Residence Rt. 3 Ozark, Ala.
 Husband Wife Widow }
 or of } Age of Husband or Wife (if living) Years

Charge to Wgt. Woodham
 Address Rt. 3 Ozark, Ala.
 Order given by Wgt. Woodham
 (or informant)

How Secured
 If Veteran, Name of War
 Occupation Housewife
 (Social Security Number)

Employer and Address

Date of Death Jan. 31 - Tue 1961
 (Mo.) (Day) (Yr.) (Hour)

Date of Birth Jan. 25 - 1874 Age 87
 (Mo.) (Day) (Yr.) (Mo.) (Days)

Services at Mt. Carmel Methodist Church
 Clergyman Rev. W. R. Mitchell, Shofar, Sald...
 (Address)

Religion of the Deceased Methodist
 (Address)

Birthplace Houston Co. Ala.

Resided in the State Ala. Co. 70
 (or U. S. or City or County) (Years) (Months)

Place of Death Home

Cause of Death

Contributory Causes

Certifying Physician W. W. Johnson
 (Address) (Coroner)

His Address Ozark, Ala.

Name of Father John Richard Procock

His Birthplace

Maiden Name of Mother Jennett Cain

Her Birthplace

Date of Funeral Feb. 1 - Wed. 2:30 P.M.
 (Date) (Day of Week) (Hour)

Motor } Remains to
 Ship }
 Size of Casket 150 MA Blue
 (State Color and Number)

Manufactured by Wm Lee
 Cemetery } Mt. Carmel
 Crematory }

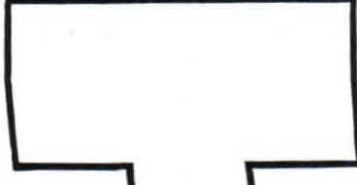

Lot No.
 Grave No.
 Section No.
 Block No.
 Owner

Complete Funeral (except outlays)	\$
Casket	
Burial Vault or Box	
Embalming Body <u>W. W. P.</u> <small>(State Kind)</small> <small>(Name of Embalmer)</small>	
Barber, \$..... Hair Dressing, \$.....	
Dressing Body, \$..... Underwear, \$.....	
Suit or Dress	
<small>(State Kind and Color)</small>	
Slippers, \$..... Hose, \$.....	
Folding Chairs, \$..... Tarpaulin, \$.....	
Candelabrum, \$..... Candles, \$.....	
Door Spray, \$..... Gloves, \$.....	
Funeral Car, \$..... Ambulance, \$.....	
Limousines to Cemetery @ \$.....	
Extra Limousines @ \$.....	
Autos to R. R. Station @ \$.....	
Getting Remains from	
Taking Remains to	
Trip to Coroner's Inquest	
Delivering Box to	
Deliver Flowers to	
Removal Charges	
Procuring Burial Permit	
____ Certif. Copies of Death Certificates No. <small>(State Number and District)</small> <small>(State Physician's or Coroner's)</small>	
Pall Bearer Service, \$..... Use of Chapel, \$.....	
Gross Total for Sales Tax	\$
Outlay for Lot	
Cremation	
Flowers, \$..... Palms, \$..... Matting, \$.....	
Rental of Tent, \$..... of Temporary Vault, \$.....	
Opening of Grave or Tomb	
Lining Grave, \$..... Lowering Device, \$.....	
Outlay for Shipping Charges	
Clergyman, \$..... Singers, \$..... Organist, \$.....	
Railroad } Tickets, \$..... Aero-Service, \$..... or Motor } plane	
Telegr., Phone, Cable or Radio Charges	
Cash Advanced	
Out of town Funeral Director's Charges	
Personal Service	
..... line Death Notices in Papers	
<small>(Names of Newspapers)</small>	

Sales Tax
 Total Footing of 11
MRS. ANNIE L. WOODHAM
 Mrs. Annie L. Woodham, 87,
 died Tuesday morning at her
 home following a long illness.
 Funeral services will be held
 from the Mt. Carmel Methodist
 Church with the Rev. W. R.

Diagram of Lot or Vault

RECORD OF FUNERAL

No. 26

Total No. 11 Yearly No. 35 Date of Entry 13 March 1976

Name of Deceased Guy Tell Woodham (What Race) W

Married Single Widowed Divorced Husband Wife Widow

Residence Rt 3 Ozark or of W Age of Husband or Wife (If living) Y

Charge to Evie Woodham

Address Rt 3 Ozark, Ala.

Order given by Evie Woodham
(or informant)

How Secured _____

If Veteran, Name of War WW1

Occupation Farmer 264-07-6796
(Social Security Number)

Employer and Address _____

Date of Birth Aug 15 1894 Age 81

Birthplace Ozark, Ala.

Date of Death Mar. 13 Sat 1976

Place of Death Home

Name of Father William Woodham

His Birthplace _____

Maiden Name of Mother Amie Peacock

Her Birthplace _____

Date of Funeral Mar 15 Mon 2 P.M.

Services at Chalk Head, Dept.

Clergyman Wiley Shipful - James Head

Religion of the Deceased Baptist

Resided in the State Ala. 51
(or U.S. or City or County) (Years) (Months)

Cause of Death _____

Contributory Causes _____

Certifying Physician W. H. Holman
(or Coroner)

His Address Ozark, Ala.

Truck } Remains to _____
Ship }

Size of Casket 45 in H. W
(State Color and Number)

Manufactured by Chalk Head

Cemetery } _____
Crematory }

Lot No. _____

Grave No. _____

Section No. _____

Block No. _____

Owner _____

Misc. _____

Complete Funeral (except outlays) _____	\$ _____
Casket _____	
Burial Vault or Box _____	
Embalming Body _____ (State Kind)	
Misc. _____ (Name of Embalmer)	
Dressing Body, \$ _____	Underwear, \$ _____
Suit or Dress _____ (State Kind and Color)	
Slippers, \$ _____	Hose, \$ _____
Folding Chairs, \$ _____	Tarpaulin, \$ _____
Candelabrum, \$ _____	Candles, \$ _____
Door Spray, \$ _____	Gloves, \$ _____
Funeral Car, \$ _____	Ambulance, \$ _____
Limousines to Cemetery @ \$ _____	
Extra Limousines @ \$ _____	
Flower Car @ \$ _____	
Autos to R.R. or Air @ \$ _____	
Getting Remains from _____	
Taking Remains to _____	
Trip to Coroner's Inquest _____	
Misc. _____	
Removal Charg _____	
Procuring Buria _____	
Certif. Co _____	
Full Bearer Serv _____	
Gross Total for _____	
Outlay for Lot _____	
Cremation _____	
Flowers, \$ _____	
Rental of Tent _____	
Opening of Gr _____	
Lining Grave, _____	
Outlay for Shi _____	
Clergymen, \$ _____	
Railroad } Tickets, \$ _____	Air Service, \$ _____
or Truck }	
Telegr., Phone, Cable or Radio Charges _____	
Cash Advanced _____	
Out of town Funeral Director's Charges _____	
Personal Service _____	
_____ line Death Notices in _____ Papers	
(Names of Newspapers)	
Sales Tax _____	
Totaling Footing of Bill _____	\$ _____
Less _____	\$ _____
Balance _____	\$ _____
Entered into Ledger, page _____ or below.	

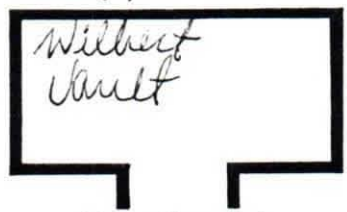

Diagram of Lot or Vault

GUY T. WOODHAM
OZARK — Guy T. Woodham, 82, Ozark Rt. 3, died yesterday at his home after a short illness. Funeral arrangements will be announced later by Holman Funeral Home. Survivors include his wife, Mrs. Evie Woodham, Ozark; three sisters, Mrs. C. C. Baker, Skipperville, Mrs. J. J. Morrott, Mrs. P. W. Griggs, Ozark; seven brothers, Joseph, Hoyt, Pryor, Charlie, John and Perry Woodham, Ozark, J. W. Woodham, Bristol, Fla.

Misc. Evie Woodham

RECORD OF FUNERAL

No. 271

Total No. 17 Yearly No. 41 Date of Entry March 22 1976

Name of Deceased Hoyt Woodham
 Married Single Widowed Divorced Husband Wife Widow } Can (What Race)

Residence Rt 3 Ozark Ala or of Hettie Woodham Age of Husband or Wife (If living) Years

Charge to Mrs Hettie Woodham

Address same

Order given by _____ (or informant)

How Secured _____

If Veteran, Name of War _____

Occupation farmer 420-12-1330 (Social Security Number)

Employer and Address _____

Date of Birth 2-16-57 Age 18
 (Mo.) (Day) (Yr.) (Yrs.) (Mos.) (Days)

Birthplace Dale County

Date of Death 3-22-76
 (Mo.) (Day) (Yr.) (Hour)

Place of Death Dale County Hosp

Name of Father William Woodham

His Birthplace _____

Maiden Name of Mother Annie Peacock

Her Birthplace _____

Date of Funeral 3-24-76 Wed 2:00 P.M.
 (Date) (Day of Week) (Hour)

Services at Mt Carmel

Clergyman James Harbart (Address)

Religion of the Deceased _____

Resided in the State Alabama (or U.S. or City or County) (Years) (Months)

Cause of Death _____

Contributory Causes _____

Certifying Physician _____ (or Coroner)

His Address _____

Truck } Remains to
 Ship }
 Size of Casket 45" wood (State Color and Number)

Manufactured by BIS

Cemetery } Mt Carmel
 Crematory }

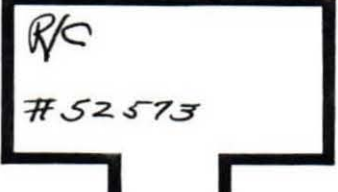

Diagram of Lot or Vault

Lot No. _____

Grave No. _____

Section No. _____

Block No. _____

Owner _____

Misc. _____

Complete Funeral (except outlays)	\$	
Casket		
Burial Vault or Box	(State Kind)	
Embalming Body	(Name of Embalmer)	
Misc.		
Dressing Body, \$	Underwear, \$	
Suit or Dress	(State Kind and Color)	
Slippers, \$	Hose, \$	
Folding Chairs, \$	Taraulin, \$	
Candelabrum, \$	Hoyt Clayton Woodham	
Door Spray, \$	OZARK— Hoyt Clayton	
Funeral Car, \$	Woodham, 69, of Ozark	
Limousines to Cer	died Monday, March 22, at	
Extra Limousines	the Dale County Hospital.	
Flower Car	Funeral services will be	
Autos to R.R. or	held Wednesday, March 24	
Getting Remains f	at 2:00 p.m. from Mt.	
Taking Remains to	Carmel with Rev. James	
Trip to Coroner's	Harbart officiating. Burial	
Misc.	will be at the Mt. Carmel	
Removal Charges	Cemetery with Holman	
Procuring Burial P	Funeral Home directing.	
..... Certif. Copi	Survivors include his	
Pall Bearer Servic	wife, Mrs. Hettie Wood-	
Gross Total for S	ham of Ozark; one	\$
Outlay for Lot	daughter, Mrs. Martha	
Cremation	Griggs and one son, Mr.	
Flowers, \$	Edwin Woodham, both of	
Rental of Tent, \$	Ozark; three sisters, Mrs.	
Opening of Grave	C.C. Baker, Skipperville,	
Lining Grave, \$	Mrs. Priscilla Griggs and	
Outlay for Shipp	Mrs. Mary Morratt, both of	
Clergymen, \$	Ozark; six brothers, Jose-	
Railroad } Ticl	ph, Pryor, Charlie, John	
or Truck }	and Perry Woodham, all of	
Telegr., Phone, C	Ozark and J.W. Woodham,	
Cash Advanced	Bristol, Florida.	
Out of town Funeral Director's Charges		
Personal Service		
..... line Death Notices in	Papers	
(Names of Newspapers)		
Sales Tax		
Totaling Footing of Bill	\$	
Less	\$	
Balance	\$	
Entered into Ledger, page	or below.	

Misc. Average CR 41

RECORD OF FUNERAL

Total No. _____ Yearly No. 97 Date of Entry Thurs. 25 July 1965

Name of Deceased Herman Woodham
 Married Single Widowed Divorced
(What Runs)

Residence Rt. 3 Ozark, Ala.
or _____ of _____ Age of Husband or Wife (if living) _____

Charge to Billie Woodham

Address Rt. 3 - Ozark

Order given by Billy Woodham
(or informant)

How Secured _____

If Veteran, Name of War no

Occupation Farmer 422-22-2246
(Social Security Number)

Employer and Address self

Date of Death July 25 Thu 1965
(Mo.) (Day) (Yr.) (Hour)

Date of Birth Oct. 17 1900 Age 62
(Mo.) (Day) (Yr.) (Mos.) (Days)

Name of Father John Wesley Woodham

His Birthplace _____

Maiden Name of Mother Media Hobbs

Her Birthplace _____

Date of Funeral July 27 Sat. 3 P. M.
(Date) (Day of Week) (Hour)

Services at Chalkhead Baptist

Clergyman Wm. Snellgrove - Ozark
(Address)

Religion of the Deceased Baptist

Birthplace State Co.

Resided in the State Ala. Co. 62
(or U.S. or City or County) (Years) (Months)

Place of Death University Hospital

Cause of Death leak of abdominal

Contributory Causes none

Certifying Physician Chump Lyons
(or Coroner)

His Address B'ham, Ala.

Motor Ship { Remains to _____

Size of Casket Standard Hearse
(State Color and Number)

Manufactured by Standard Casket Co.

Cemetery { Chalkhead

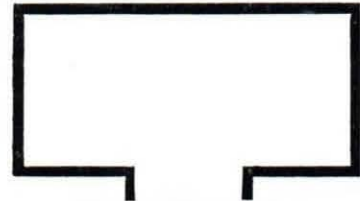

Lot No. _____
 Grave No. _____
 Section No. _____
 Block No. _____
 Owner _____

Misc. To be filed in B'ham.

Complete Funeral (except outlays)	\$ _____
Casket	_____
Burial Vault or Box	_____
Embalming Body	_____ (State Kind) (Name of Embalmer)
Barber, \$	_____ Hair Dressing, \$ _____
Dressing Body, \$	_____ Underwear, \$ _____
Suit or Dress	_____ (State Kind and Color)
Slippers, \$	_____ Hose, \$ _____
Folding Chairs, \$	_____ Tarpaulin, \$ _____
Candelabrum, \$	_____ Candles, \$ _____
Door Spray, \$	_____ Gloves, \$ _____
Funeral Car, \$	_____ Ambulance, \$ _____
Limousines to Cemetery	@ \$ _____
Extra Limousines	@ \$ _____
Autos to R. R. Station	@ \$ _____
Getting Remains from	_____
Taking Remains to	_____
Trip to Coroner's Inquest	<u>Standard Seal 5-</u>
Delivering Box to	<u>Sil 85.00 3x1 Plated</u>
Deliver Flowers to	_____
Removal Charges	<u>#18 Irving</u>
Procuring Burial Permit	_____ <u>22</u>
Certif. Copies of Death Certificates No.	_____ (State Number and District) (State Physician's or Coroner's)
Pall Bearer Service, \$	_____ Use of Chapel, \$ _____
Gross Total for Sales Tax	\$ _____
Outlay for Lot	_____
Cremation	_____
Flowers, \$	_____ Palms, \$ _____ Matting, \$ _____
Rental of Tent, \$	_____ of Temporary Vault, \$ _____
Opening of Grave or Tomb	_____
Lining Grave, \$	_____ Lowering Device, \$ _____
Outlay for Shipping Charges	_____
Clergymen, \$	_____ Singers, \$ _____ Organist, \$ _____
Railroad or Motor	{ Tickets, \$ _____ Aero-plane Service, \$ _____
Telegr., Phone, Cable or Radio Charges	_____
Cash Advanced	_____
Out of town Funeral Director's Charges	_____
Personal Service	_____

_____ line Death Notice
(Names of Newspapers)

Sales Tax _____
 Total Footing of Bill _____
 Less _____

Entered into Ledger, page _____

Misc. _____

Herman Woodham
 OZARK — Herman Woodham, 62, a retired farmer of Ozark, died in a Birmingham hospital last night.
 The funeral will be held at 3 p.m. Saturday at the Chalkhead Baptist Church with the Rev. William Snellgrove officiating. Burial will be in the church cemetery with Holman of Ozark directing. The body will be taken to the Woodham residence at 11 a.m. tomorrow where it will remain until funeral time.
 He was a native of Dale County and was a member of Chalk-

RECORD OF FUNERAL

No. _____

Total No. 7 Yearly No. 7 Date of Entry JANUARY 20 195

Name of Deceased JAMES WOODHAM WHITE
(What Race)

Residence RT. 2 BOX 126 CLAYTON, AL Husband Wife Widow Divorced } MAUDIE WALKER
or of } Age of Husband or Wife (If living) _____ Year

Charge to MRS. MAUDIE WOODHAM
Address SAME AS ABOVE

Order given by WIFE
(or informant)

If Veteran, Name of War _____
Occupation FARMER 419-44-2127
(Social Security Number)

Employer and Address _____
Date of Birth MARCH 29, 1905 Age 77
(Mo.) (Day) (Yr.) (Yrs.) (Mos.) (Days)

Birthplace HENRY COUNTY
Date of Death JAN. 20, 1982 7 A.M.
(Mo.) (Day) (Yr.) (Hour)

Place of Death HOME
Name of Father JOSEPH HILERY WOODHAM

His Birthplace _____
Maiden Name of Mother IRA OWENS

Her Birthplace _____
Date of Funeral JAN. 22 FRI. 11 A.M.
(Date) (Day of Week) (Hour)

Services at SPRING HILL BAPTIST
Clergyman JOHNNIE WALKER, FRED AVERY
(Address)

Religion of the Deceased MICHAEL TIER
Resided in the State _____
(or U.S. or City or County) (Years) (Months)

Cause of Death _____
Contributory Causes _____

Certifying Physician LAMAR CHAPMAN
(or Coroner)

His Address EUFULA, AL
Truck } Remains to _____
Ship }

Size of Casket 1423 20 GA
(State Color and Number)

Manufactured by AURORA II 8258
Cemetery } BETHEL, BLUE SPRINGS
Crematory }

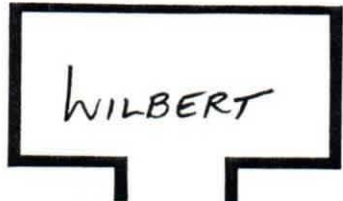

Diagram of Lot or Vault

Lot No. _____
Grave No. _____
Section No. _____
Block No. _____
Owner _____

Misc. _____

Complete Funeral (except outlays)	\$
Casket	
Burial Vault or Box	
Embalming Body <u>EB</u>	(State Kind) (Name of Embalmer)
Misc.	
Dressing Body, \$	Underwear, \$
Suit or Dress <u>259-BROWN</u>	(State Kind and Color)
Slippers, \$	Hose, \$
Folding Chairs, \$	Tarpaulin, \$
Candelabrum, \$	Candles, \$
Door Spray, \$	Gloves, \$
Funeral Car, \$	Ambulance, \$
Limousines to Cemetery	@ \$
Extra Limousines	@ \$
Flower Car	James Woodham
Autos to R.R. or Air	CLAYTON— James
Getting Remains from	Woodham, 77, of Rt. 2
Taking Remains to	Clayton, died Wednesday
Trip to Coroner's Inqu	morning, Jan. 20 at his
Misc.	home following a brief
Removal Charges	illness.
Procuring Burial Permi	Funeral services were
..... Certif. Copies of	held at 11 a.m. Friday,
Pall Bearer Service, \$	Jan. 22 at the Spring Hill
Gross Total for Sales T	Baptist Church with the
Outlay for Lot	Rev. Johnny Wauzer,
Cremation	Fred Avery and Michael
Flowers, \$	Tier officiating. Burial
Rental of Tent, \$	followed in the Bethel at
Opening of Grave or T	Blue Springs Cemetery
Lining Grave, \$	with Holman Funeral
Outlay for Shipping Ch	Home of Ozark directing.
Clergymen, \$	Survivors include his
Railroad } Tickets, \$	wife, Maudie B. Wood-
or Truck }	ham, Clayton; one daugh-
Telegr., Phone, Cable or	ter, Mrs. Jimmie Sue
Cash Advanced	Farmer, Clayton; one son,
Out of town Funeral Di	Billy Woodham, Dothan;
Personal Service	one brother, John Doug-
..... line Death Notice	las Woodham, Anniston;
(Names of Newspapers)	four grandchildren, John
Sales Tax	Michael Woodham, Pen-
Totaling Footing of Bill	sacola, Fla., Beverly
Less	Woodham, Tuscaloosa,
Balance	Al., Patti Ann Woodham,
Entered into Ledger, page	Dothan and Robin Melissa
or below.	Farmer, Clayton.

Misc. _____

RECORD OF FUNERAL

Total No. Yearly No. 168 Quinn Date of Entry Nov. 10, Thursday

Name of Deceased James Erwin Woodham W.
 Married Single Widowed Divorced (What Race)

Residence Midland City - Rt. 1 Husband Wife Widow }
 or of } Age of Husband or Wife (if living)

Charge to James Woodham

Address Midland City

Order given by James Woodham
 (or informant)

How Secured

If Veteran, Name of War WW 2nd Lt

Occupation Painter (Charles) 547-60-5778
 (Social Security Number)

Employer and Address

Date of Death Nov. 10, Thur. 1960 3:30 P.M.
 (Mo.) (Day) (Yr.) (Hour)

Date of Birth Nov. 6, 1942 Age 18
 (Mo.) (Day) (Yr.) (Mos.) (Days)

Services at Corinth Free Will Baptist

Clergyman Will Hutto - H. Waters - Ralph Bell
 (Address)

Religion of the Deceased Baptist

Birthplace Houston Co. Duthan, Ala.

Resided in the State Ala. Co. 18-
 (or U. S. or City or County) (Years) (Months)

Place of Death Ala. Co. Hospital

Cause of Death

Contributory Causes Auto Accident

Certifying Physician N.W. Holman

His Address Ozark, Ala.

Name of Father James Woodham

His Birthplace

Maiden Name of Mother Jessie Andrews

Her Birthplace Deceased

Date of Funeral Nov. 12 - Sat. 3:30 P.M.
 (Date) (Day of Week) (Hour)

Motor } Remains to
 Ship }

Size of Casket Camp Hummetal Hinge
 (State Color and Number)

Manufactured by

Cemetery } Corinth
 Crematory }

Miscellaneous Helen Grace
11-17-60

Complete Funeral (except outlays) \$
 Casket
 Burial Vault or Box
 Embalming Body (State Kind) Full V.P.
 (Name of Embalmer)
 Barber, \$ Hair Dressing, \$
 Dressing Body, \$ Underwear, \$
 Suit or Dress (State Kind and Color)
 Slippers, \$ Hose, \$
 Folding Chairs, \$ Tarpaulin, \$
 Candelabrum, \$ Candles, \$
 Door Spray, \$ Gloves, \$
 Funeral Car, \$ Ambulance, \$
 Limousines to Cemetery @ \$
 Extra Limousines @ \$
 Autos to R. R. Station @ \$
 Getting Remains from
 Taking Remains to
 Trip to Coroner's Inquest
 Delivering Box to
 Deliver Flowers to
 Removal Charges
 Procuring Burial Permit
 _____ Certif. Copies of Death Certificates No.
 (State Number and District) (State Physician's or Coroner's)
 Pall Bearer Service, \$ Use of Chapel, \$
 Gross Total for Sales Tax
 Outlay for Lot
 Cremation
 Flowers, \$ Palms, \$ Matting, \$
 Rental of Tent, \$ of Temporary Vault, \$
 Opening of Grave or Tomb
 Lining Grave, \$ Lowering Device, \$
 Outlay for Shipping Charges
 Clergyman, \$ Singers, \$ Organist, \$
 Railroad } Tickets, \$ Aero-
 or Motor } plane Service, \$
 Telegr., Phone, Cable or Radio Charges
 Cash Advanced
 Out of town Funeral Director's Charges
 Personal Service
 line Death Notices in
 (Names of) **James E. Woodham Dies Of Work Injuries**
 James Erwin Woodham died in the Dale Co. Jail on Thursday afternoon just retained in an ambulance near Eber on the State Highway Section 100. Funeral arrangements announced for the funeral home at Midland City.

11/11/60

11/11/60



Diagram of Lot or Vault

Lot No.
 Grave No.
 Section No.
 Block No.
 Owner

Miscellaneous Helen Grace
11-17-60

RECORD OF FUNERAL

Total No. MONTH 4 Yearly No. 39 Date of Entry March 10 1973

Name of Deceased James O. Woodham
 Married Single Widowed Divorced (What Race)
 Husband Wife Widow }
 or.....of } Age of Husband or Wife (if living).....Years

Residence Rt. 3 Ozark

Charge to Jeanette Woodham
 Address same

Order given by wife (or informant)
 How secured.....

If Veteran, Name of War WW II
 Occupation 421-16-0875 (Social Security Number)

Employer and Address.....

Date of Death March 10, 1973

Date of Birth 22 Sept 1922 Age 50
 (Mo.) (Day) (Yr.) (Hour) (Mo.) (Days)

Name of Father Marvin Woodham

His Birthplace.....

Maiden Name of Mother Molly Marshall

Her Birthplace.....

Date of Funeral 3-11-73 Sun. 4 P. M.
 (Date) (Day of Week) (Hour)

Services at Chalkhead

Clergyman E.A. McGriff (Address)

Religion of the Deceased Bapt.

Birthplace Dale County

Resided in the State Alabama
 (of U.S. or City or County) (Years) (Months)

Place of Death Enterprise Hospital

Cause of Death.....

Contributory Causes.....

Certifying Physician Dr. James Paulk (or Coroner)

His Address Enterprise, Ala.

Motor } Remains to.....
 Ship }

Size of Casket Security Sealer (Gunmetal) (State Color and Number)

Manufactured by Davis Casket Company

Cemetery } Chalkhead
 Crematory }

Complete Funeral (except outlays).....	\$	
Casket.....		
Burial Vault or Box.....		
Embalming Body <u>H.P.</u> (State Kind) (Name of Embalmer)		
Barber, \$..... Hair Dressing, \$.....		
Dressing Body, \$..... Underwear, \$.....		
Suit or Dress..... (State Kind and Color)		
Slippers, \$..... Hose, \$.....		
Folding Chairs, \$..... Tarpaulin, \$.....		
Candelabrum, \$..... Candles, \$.....		
Door Spray, \$.....		
Funeral Car, \$.....		
Limousines to Cem.....		
Extra Limousines.....		
Autos to R. R. Stat.....		
Getting Remains fr.....		
Taking Remains to.....		
Trip to Coroner's I.....		
Delivering Box to.....		
Deliver Flowers to.....		
Removal Charges.....		
Procuring Burial Per.....		
..... Certif. Copies of.....		
Pall Bearer Service, \$.....		
Gross Total for Sales.....		
Outlay for Lot.....		
Cremation.....		
Flowers, \$..... Palms, \$.....		
Rental of Tent, \$.....		
Opening of Grave or T.....		
Lining Grave, \$.....		
Outlay for Shipping Ch.....		
Clergymen, \$..... Singe.....		
Railroad } Tickets, \$..... or Motor }		
Telegr., Phone, Cable or Radio Charges.....		
Cash Advanced.....		
Out of town Funeral Director's Charges.....		
Personal Service.....		
..... line Death Notices in..... Papers.....		
(Names of Newspapers)		
Sales Tax.....		
Total Footing of Bill.....	\$	
Less.....	\$	
Balance.....	\$	
Entered into Ledger, page..... or below.		

JAMES O. WOODHAM
 James O. Woodham of Ozark, Rt. 3, died Saturday morning in an Enterprise hospital following a short illness at the age of 50. Funeral services were held at 4 p.m. Sunday from the Chalkhead Baptist Church with Dr. E. A. McGriff and Rev. Fred Williams officiating. Interment followed in the church cemetery with Holman Funeral Home directing.
 Mr. Woodham was a life long resident of Dale County, a member of the Chalkhead Baptist Church and a veteran of World War II.
 Survivors include his wife, Mrs. Jeanette Woodham; two daughters, Gail and Janis Woodham; two sons, Wayne and Reggie Woodham, all of Rt. 3, Ozark; two brothers, Ovie and Perry Woodham, both of Midland City.

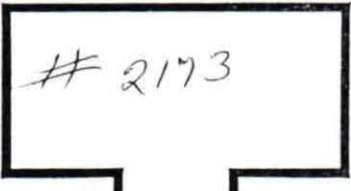

Lot No.....
 Grave No.....
 Section No.....
 Block No.....
 Owner.....

Misc.....

RECORD OF FUNERAL

Total No. 231..... Yearly No. 36..... Date April 23..... 1932

Name of Deceased Laura Woodham - White - Dale
(What Race) (Where Born)

~~Husband~~
~~Wife - Widow~~
~~Son - Daughter of~~ } J. R. Woodham

Charge to Service Ins. Co

Address.....

Order Given by.....

How Secured.....

Date of Funeral April 23, 1932

Residence.....

Place of Death Home

Funeral Services at Evell Church

Time of Funeral Service 3:30

Clergyman.....

His Address.....

Certifying Physician Dr. W. A. Parish

His Residence Midland City

Cause of Death.....
(Primary)

Cause of Death.....
(Secondary)

Date of Death April 23, 1932

Occupation of the Deceased retired

Employed.....

Single or Married married Religion.....

Date of Birth.....

Age 63..... Years..... Months..... Days

Name of Father Ed Woodham

His Birthplace Dale Co.

Name of Mother Secamer Pate
(Maiden Name)

Her Birthplace Pa.

Body to be Shipped to.....

Size and Style of Casket.....

Manufactured by.....

Interment at Evell..... Cemetery



Diagram of Lot or Vault

Lot No.....

Grave No.....

Section No.....

Casket <u>7-910</u> <u>White</u> <u>250</u>	
Metallic Lining.....	<small>(State Kind)</small>
Outside Box.....	<small>(State Kind)</small>
Grave Vault.....	<small>(State Kind)</small>
Suit or Dress, \$ <u>35</u> Hose, \$ <u>1</u> Slippers, \$ <u>36</u>	
Embalming Body (with..... Fluid)	
Dressing Body, \$..... Hair Dressing, \$.....	
Folding Chairs.....	
Candelabrum, \$..... Candles, \$.....	
Door Badge, \$..... Gloves, \$.....	
Hearse.....	<u>50</u>
Auto Limousines to Cemetery @ \$.....	
Autos to R. R. Station..... @ \$.....	
Aeroplane Service.....	
Getting Remains from.....	
Taking Body to Inquest.....	
Delivering Box to.....	
Delivering Remains to.....	
Death Notices in..... Newspapers.....	<small>(Names of Newspapers)</small>
Flowers.....	
Rental of Plants, \$..... Tent Rental, \$.....	
Outlay for Lot.....	
Opening Grave Vault, \$.....	
Lining Grave, \$..... Matting, \$.....	
Lowering Device, \$..... Rental of Vault.....	
Outlay for Shipping Charges.....	
Removal Charges, \$..... Incineration, \$.....	
Getting Burial Permit.....	
Certified Copies of Death Certificate.....	
Personal Charges, \$..... Singers, \$.....	
Church Charges, \$..... Ministers, \$.....	
Pall Bearer Service.....	
Telegr., Telephone, Cable or Radio Charges.....	
Railroad Tickets.....	
Cash Advanced.....	

Total Footing of Bill..... \$

By Amount Paid in Advance..... \$

Balance..... \$

Entered into Ledger, page..... or below

To Funeral Charges... Total, \$

By Cash..... \$

RECORD OF FUNERAL

Total No. 48 Yearly No. 48 Date of Entry April 10
 Name of Deceased Jessie Alex Woodham
 Married Single Widowed Divorced (What Race)
 Residence: Chark Rt 3 Husband Wife Widow }
 Charge to: BT 14 or of } Age of Husband or Wife (if living)

Address
 Order given by Ms J. A. Woodham (or informant)
 How Secured :
 If Veteran, State War
 Occupation Farming (Social Security Number)
 Employer and Address
 Date of Death April 10, 1948 (Date) (Hour)
 Date of Birth Feb 2, 1882 (Date) (Hour)
 Age 66 (Years) (Months) (Days)
 Date of Funeral April 12 (Date) (Day of Week) (Hour) M.
 Services at: Chalk Head (Address)
 Clergyman :
 Religion of the Deceased
 Birthplace Dale Co - Ala
 Resided in the State (or U. S. or City or County) (Years) (Months)
 Place of Death Chark Rt # 3
 Cause of Death: shot gun wound
 Contributory Causes: in heart

Certifying Physician (or Coroner)
 His Address:
 Name of Father John Wesley Woodham
 His Birthplace Dale Co - Ala
 Maiden Name of Mother Neadie Hobbs
 Her Birthplace Dale Co - Ala
 Motor } Remains to
 Ship }
 Size of Casket (State Color and Number)
 Manufactured by:
 Cemetery } Chalk Head
 Crematory }



Lot No.
 Grave No.
 Section No.
 Block No.
 Owner

Complete Funeral (except outlays)	\$	
Casket		250
Burial Vault or Box		65
Embalming Body		35
Barber, \$.....		
Hair Dressing, \$.....		
Dressing Body, \$.....		
Underwear, \$.....		15
Suit or Dress		
Slippers, \$.....		
Hose, \$.....		
Folding Chairs, \$.....		
Tarpaulin, \$.....		
Candelabrum, \$.....		
Candles, \$.....		
Door Spray, \$: :		
Gloves, \$.....		
Funeral Car, \$.....		
Ambulance, \$.....		
Limousines to Cemetery	@ \$	
Extra Limousines	@ \$	
Autos to R. R. Station	@ \$	
Getting Remains from :		
Taking Remains to		
Trip to Coroner's Inquest		
Delivering Box to		
Deliver Flowers to		
Removal Charges		
Procuring Burial Permit		
Certif. Copies of Death Certificates No.		
Pall Bearer Service, \$.....		
Use of Chapel, \$.....		
Gross Total for Sales Tax	\$	
Outlay for Lot:		
Cremation		
Flowers, \$.....		
Palms, \$: :		
Matting, \$.....		
Rental of Tent, \$.....		
of Temporary Vault, \$.....		
Opening of Grave or Tomb		
Lining Grave, \$.....		
Lowering Device, \$.....		
Outlay for Shipping Charges		
Clergyman, \$.....		
Singers, \$.....		
Organist, \$.....		
Railroad } Tickets, \$.....		
or Motor } Aero-plane Service, \$.....		
Telegr., Phone, Cable or Radio Charges		
Cash Advanced		
Out of town Undertaker's Charges		
Personal Service		
..... line Death Notices in Papers		
(Names of Newspapers)		
Sales Tax		60
Total Footing of Bill	\$	370
Less	\$	
Balance	\$	
Entered into Ledger, page or below.		

Date	Amount Paid	Balance	Date	Amount Paid	Balance
To Above Balance					

RECORD OF FUNERAL

Total No. 48 Yearly No. 48 Date of Entry April 10
 Name of Deceased Jessie Alex Woodham (What Race) _____
 Married Single Widowed Divorced
 Residence: Ozark Rt 3 Husband Wife Widow }
 or of } Age of Husband or Wife (if living)
 Charge to: BT 14
 Address:
 Order given by: me J. A. Woodham (or informant)
 How Secured:
 If Veteran, State War
 Occupation Farming (Social Security Number)
 Employer and Address
 Date of Death April 10, 1948 (Date) (Hour)
 Date of Birth Feb 2, 1882 (Date) (Hour)
 Age 66 (Years) (Months) (Days)
 Date of Funeral April 12 (Date) (Day of Week) (Hour)
 Services at: Chalk Head (Address)
 Clergyman:
 Religion of the Deceased
 Birthplace Dale Co - Ala
 Resided in the State
 Place of Death Ozark Rt # 3 (or U. S. or City or County) (Years) (Months)
 Cause of Death: shot gun wound (State Physician's or Coroner's)
 Contributory Causes: in heart
 Certifying Physician: (or Coroner)
 His Address:
 Name of Father: John Wesley Woodham
 His Birthplace: Dale Co - Ala
 Maiden Name of Mother: Meddie Hobbs
 Her Birthplace: Dale Co - Ala
 Motor } Remains to
 Ship }
 Size of Casket: (State Color and Number)
 Manufactured by:
 Cemetery } Chalk Head
 Crematory }
 Lot No.
 Grave No.
 Section No.
 Block No.
 Owner:

Complete Funeral (except outlays)	\$
Casket	250
Burial Vault or Box	65
Embalming Body	35
Barber, \$.....	Hair Dressing, \$.....
Dressing Body, \$.....	Underwear, \$.....
Suit or Dress	15
Slippers, \$.....	Hose, \$.....
Folding Chairs, \$.....	Tarpaulin, \$.....
Candelabrum, \$.....	Candles, \$.....
Door Spray, \$.....	Gloves, \$.....
Funeral Car, \$.....	Ambulance, \$.....
Limousines to Cemetery	@ \$.....
Extra Limousines	@ \$.....
Autos to R. R. Station	@ \$.....
Getting Remains from:	
Taking Remains to	
Trip to Coroner's Inquest	
Delivering Box to	
Deliver Flowers to	
Removal Charges	
Procuring Burial Permit	
_____ Certif. Copies of Death Certificates No. _____	
_____ Pall Bearer Service, \$.....	Use of Chapel, \$.....
Gross Total for Sales Tax	\$
Outlay for Lot:	
Cremation	
Flowers, \$.....	Palms, \$.....
Rental of Tent, \$.....	of Temporary Vault, \$.....
Opening of Grave or Tomb	
Lining Grave, \$.....	Lowering Device, \$.....
Outlay for Shipping Charges	
Clergyman, \$.....	Singers, \$.....
Railroad } Tickets, \$.....	Aero-plane Service, \$.....
or Motor }	
Telegr., Phone, Cable or Radio Charges	
Cash Advanced	
Out of town Undertaker's Charges	
Personal Service	
..... line Death Notices in	Papers
.....	(Names of Newspapers)
Sales Tax	66
Total Footing of Bill	\$ 371
Less	\$
Balance	\$

46/10

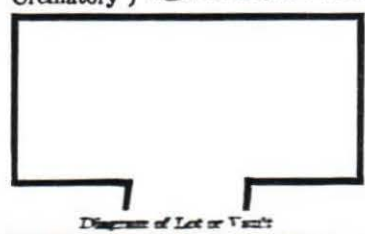

Date	Amount Paid	Balance	Date	Amount Paid	Balance

Entered into Ledger, page _____ or below.

RECORD OF FUNERAL

Total No. 1 Yearly No. 8 Date of Entry FEBRUARY 14 1985

Name of Deceased JOHN DAVID WOODHAM WHITE

Married Single Widowed Divorced
 Residence 605 BERMUDA ST. OZARK, AL Husband Wife Widow } MATTIE PEARL WOODHAM (What Name?)
 or of } Age of Husband or Wife (if living)

Charge to MRS. MATTIE WOODHAM

Address SAME AS ABOVE

Order given by WIFE
 (or informant)

How Secured _____
 If Veteran, Name of War VIET NAM

Occupation HOUSE PAINTER 421-52-8914
 (Social Security Number)

Employer and Address _____
 Date of Birth OCT. 20, 1941 Age 43
 (Mo.) (Day) (Yr.) (Mos.) (Days)

Birthplace HOUSTON COUNTY

Date of Death FEB. 14, 1985
 (Mo.) (Day) (Yr.) (Hour)

Place of Death DOTHAN

Name of Father JOHN HENRY WOODHAM

His Birthplace _____

Maiden Name of Mother MARY LUCILE KIRKLAND

Her Birthplace _____

Date of Funeral FEB 18 MON. 10A. M.
 (Date) (Day of Week) (Hour)

Services at HOLMAN CHAPEL

Clergyman REV. ROY SMITH
 (Address)

Religion of the Deceased _____

Resided in the State _____
 (or U.S. or City or County) (Years) (Months)

Cause of Death _____

Contributory Causes _____

Certifying Physician BUCKY STOKES
 (or Coroner)

His Address DOTHAN, AL

Truck } Remains to _____
 Ship }

Size of Casket 700
 (State Color and Number)

Manufactured by B-S NO. 804

Cemetery } OZARK CITY
 Crematory }

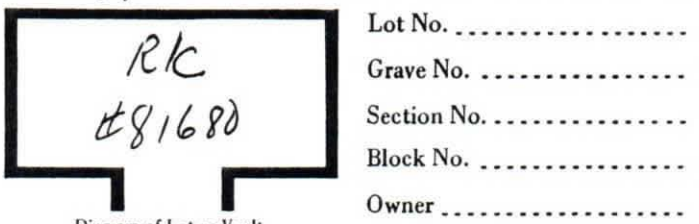

Lot No. _____
 Grave No. _____
 Section No. _____
 Block No. _____
 Owner _____

Misc. _____

Complete Funeral (except outlays)	\$
Casket	
Burial Vault or Box	(State Kind)
Embalming Body	(Name of Embalmer)
Misc.	
Dressing Body, \$	Underwear, \$
Suit or Dress	(State Kind and Color)
Slippers, \$	Hose, \$
Folding Chairs, \$	Tarpaulin, \$
Candelabrum, \$	Candles, \$
Door Spray, \$	Gloves, \$
Funeral Car, \$	Ambulance, \$
Limousines to Cemetery	@ \$
Extra Limousines	@ \$
Flower Car	@ \$
Autos to R.R. or Air	@ \$

Getting Remains from _____
 Taking Remains to **JOHN DAVID WOODHAM**
 Trip to Coroner's Inquest **OZARK—John David Wood-**
 Misc. **ham, 43, of Bermuda Street,**
 Removal Charges **Ozark, passed away Thursday**
 Procuring Burial Permit **evening, February 14, in a**
Dothan hospital following an
apparent heart attack.

_____ Certif. Copies of De	
Pall Bearer Service, \$	
Gross Total for Sales Tax	
Outlay for Lot	
Cremation	
Flowers, \$	Palms, \$
Rental of Tent, \$	of
Opening of Grave or Tomb	
Lining Grave, \$	Lo
Outlay for Shipping Charge	
Clergymen, \$	Singer
Railroad } Tickets, \$	
or Truck }	
Telegr., Phone, Cable or Ra	
Cash Advanced	
Out of town Funeral Direct	
Personal Service	

Funeral services were held a
 10 a.m. Monday from the Chapel
 of Holman Funeral Home with
 Rev. Roy Smith officiating. Bur
 ial followed in the Ozark Cit
 Cemetery with Holman Funera
 Home of Ozark directing.

He is survived by his wife
 Mrs. Mattie Pearl Woodham o
 Ozark; three sons, Lennie and
 Bradley Woodham, Dothan and
 William Woodham, Indiana; his
 mother, Mrs. Lucile Woodham;
 Dothan; one sister, Mrs. Betty
 Baxley, Slocomb; one brother
 Pete Woodham, Monticello, Ill

_____ line Death Notices in _____ papers
 (Names of Newspapers)

Sales Tax	
Totaling Footing of Bill	\$
Less	\$
Balance	\$

Entered into Ledger, page _____ or below.

Misc. _____

RECORD OF FUNERAL

Total No. 1143 Yearly No. 102 Date Sept 8
 Name of Deceased Mollie Woodham (Single — Married — Divorced) W (What Race) (Where Born)

Residence of Deceased Husband—Wife—Widow—
 Charge to Brown Service or of }

Address

Order given by (or informant)

How Secured

Occupation of Deceased

Name of Employer

Address

Date of Death Sept 8, 1937 (Date) (Hour)

Date of Birth

Age 51 (Years) (Months) (Days)

Date of Funeral Sept 9, 1937 (Date) (Day of Week) (Hour) M.

Services at

Clergyman

His Address

Religion of the Deceased

Resided in the State (or U. S. or City or County) (Years) (Months)

Place of Death at home

Cause of Death

Contributory Causes

Certifying Physician Dr. W. P. Parrish (or Coroner)

His Address Milland City

Name of Father Bill Bull

His Birthplace unk

Maiden Name of Mother Sadie Palmer

Her Birthplace unk

Motor } Remains to
Ship }

Size and Style of Casket (State Color)

Manufactured by

Interment at { Cemetery
Crematory

Lot No.

Grave No.

Complete Funeral \$
Casket
Metallic Lining (State Kind)
Outside Box (State Kind)
Burial Vault (State Kind)
Embalming Body with Fluid
Barber, \$ Hair Dressing, \$
Dressing Body
Suit or Dress, \$ (State Color) Hose, \$
Underwear, \$ Slippers, \$
Folding Chairs, \$ Tarpaulin, \$
Candelabrum, \$ Candles, \$
Door Badge, \$ Gloves, \$
Hearse, \$ Ambulance, \$
Limousines to Cemetery @ \$
Autos to R. R. Station @ \$
Getting Remains from
Taking Remains to
Trip to Coroner's Inquest
Delivering Box to
Flowers to
Removal Charges
Procuring Burial Permit (State Number and District)
_____ Certif. Copies of Death Certificates No. _____ (State Physician's or Coroner's)
Pall Bearer Service, \$ Use of Chapel, \$
Personal Service
Outlay for Lot
Cremation
..... line Death Notices in Papers
Flowers, \$ (Names of Newspapers) Palms, \$
Rental of Tent, \$ of Temporary Vault, \$
Opening of Grave or Tomb
Lining Grave, \$ Lowering Device, \$
Outlay for Shipping Charges
Clergyman, \$ Singers, \$
..... Organist, \$
Railroad } Tickets, \$ Aero-
or Motor } plane Service, \$
Telegr., Phone, Cable or Radio Charges
Cash Advanced
Out of town Undertaker's Charges
Total Footing of Bill \$
Less \$

RECORD OF FUNERAL

Total No. 872 Yearly No. 6 Date Jan. 14 1935
 Name of Deceased John Wesley Woodham (Single - Married - Divorced) White (What Race) Dec (Where Born)

Residence of Deceased Oak, Rtz Husband—Wife—Widow—
 Charge to: Brown Service or..... of }

Address.....
 Order given by..... (or informant)
 How Secured.....
 Occupation of Deceased Farmer
 Name of Employer.....
 Date of Death 1/14/35 (Date) (Hour)
 Date of Birth.....
 Age 78 (Years) (Months) (Days)
 Date of Funeral..... M.
 Services at.....
 Clergyman.....
 His Address.....
 Religion of the Deceased.....
 Resided in the State..... (of U. S. or City or County) (Years) (Months)
 Place of Death at Home
 Cause of Death.....
 Contributory Causes.....
 Certifying Physician Dr. Cotter (or Coroner)
 His Address.....
 Name of Father Moses Woodham
 His Birthplace Ala
 Maiden Name of Mother Mandy Halloway
 Her Birthplace Ala
 Motor } Remains to.....
 Ship }
 Size and Style of Casket 1/2 100 L KH- (State Color)
 Manufactured by.....
 Interment at Chalkhead { Cemetery
 Crematory

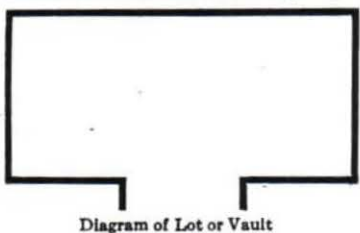

Lot No.....
 Grave No.....
 Section No.....
 Owner.....

Complete Funeral \$
 Casket.....
 Metallic Lining..... (State Kind)
 Outside Box..... (State Kind)
 Burial Vault..... (State Kind)
 Embalming Body..... with..... Fluid
 Barber, \$..... Hair Dressing, \$.....
 Dressing Body.....
 Suit or Dress, \$..... 5.9 Black Hose, \$..... (State Color)
 Underwear, \$..... Slippers, \$.....
 Folding Chairs, \$..... Tarpaulin, \$.....
 Candelabrum, \$..... Candles, \$.....
 Door Badge, \$..... Gloves, \$.....
 Hearse, \$..... Ambulance, \$.....
 Limousines to Cemetery..... @ \$.....
 Autos to R. R. Station..... @ \$.....
 Getting Remains from.....
 Taking Remains to.....
 Delivering Box to.....
 Flowers to.....
 Removal Charges.....
 Procuring Burial Permit..... (State Number and District)
 Certif. Copies of Death Certificates No..... (State Physician's or Coroner's)
 Pall Bearer Service.....
 Personal Service.....
 Use of Chapel.....
 Outlay for Lot.....
 Death Notices in..... Newspapers..... (Names of Newspapers)
 Flowers, \$..... Rental of Palms, \$.....
 Rental of Tent, \$..... of Temporary Tomb, \$.....
 Lowering Device, \$..... Cremation, \$.....
 Opening of Grave or Tomb.....
 Lining Grave, \$..... Matting, \$.....
 Outlay for Shipping Charges.....
 Clergyman, \$..... Singers, \$..... Organist, \$.....
 Railroad } Tickets, \$..... Aero-
 or Motor } plane Service, \$.....
 Telegr., Phone, Cable or Radio Charges.....
 Cash Advanced.....
 Out of town Undertaker's Charges.....
 Total Footing of Bill..... \$
 Less..... \$
 Balance..... \$
 Entered into Ledger, page..... or below.

To Funeral Charges... Total, \$..... By Cash.....

Pvt. Rufus Woodham

-Date of actual death: 18 Sep 1944, Date listed on tablet of missing at The Florence American Cemetery: 13 Oct 1945¹

-Unit: 351st Infantry Battalion, 88th Infantry Division (Company & Platoon unknown)

-Place of death: South of Scarperia, Italy (see map)

-Other facts: Cause of death was direct hit from an artillery shell. Remains never recovered. Death witnessed by Leon E. Williams.

351st Activities in September, 1944:

On 9 Sep 1944 the 351st Infantry Regiment moved to a forward area in the vicinity of Galluzzo, several miles southwest of Florence. Several days were spent arranging camp in the new area. On the night of 15 Sep 1944 night training was conducted.

Shortly after 15 September the 88th Division began moving north to assembly areas to take part in the Gothic Line assault. Fifth Army began the assault on September 15th. The main attack was concentrated north of Florence. The attack began with the greatest artillery barrage ever fired in Italy.

The 351st reached the area in the vicinity of Scarperia (the town of Firenzuola is 3 km SE) on the 20th of September 1944. This places the location of Pvt Woodham's death on the 20 mile route between Galluzzo and Scarperia, probably nearer Scarperia. It should be noted that they must have moved through, or very near, the main attack area.

Note: I have added information to Pvt Woodham's listing at FindAGrave.com. You can see it at <http://www.findagrave.com/cgi-bin/fg.cgi?page=gr&GRid=9638780>

¹The reason why we find two dates of death for Pvt Woodham is that, without confirmed information to the contrary, a War Department Administrative Review Board established the official date of death of those missing as one year and a day from the date on which the individual was placed in Missing in Action status. You can find detailed information on the cemetery, and watch a short video tour at: <http://www.abmc.gov/cemeteries/cemeteries/fl.php>

Richard & Bonnie Cooper
(his father was in this military unit)

FIND A GRAVE**Actions**[Begin New Search](#)[Refine Last Search](#)[Cemetery Lookup](#)[Add Burial Records](#)[FAQ](#)[Top Contributors](#)[Success Stories](#)[Discussion forums](#)[Find A Grave Store](#)[Support Find A Grave](#)[Log In](#)**Flowers left for Rufus Woodham**

Pvt Woodham was born on 29 Jan 1920 in Georgia. He served with the 351st Infantry Regiment, 88th Infantry Division. He actually died on 18 Sep 1944 but was listed as missing. His death was witnessed by good friend and fellow soldier, Leon

Williams. Pvt Woodham died when the shell hole he had taken cover in took another direct hit from an artillery shell. The exact location of his death is unknown, but it was on the 20 mile route between Galluzzo and Scarperia Italy, probably nearer Scarperia. The 351st was moving north as part of the assault on the Gothic Line. His remains were never recovered. The date shown on the Tablet of the Missing at the cemetery is the date his status was changed from MIA to KIA. He left behind a wife and son.

- Bonnie Cooper

Added: 11/18/2007

[Accuracy and Copyright Disclaimer](#)

RECORD OF FUNERAL

Total No. 6158 Yearly No. 128 Date of Entry Oct 29
 Name of Deceased Joseph Earl Woodham
 Married Single Widowed Divorced (What Race)
 Residence: Clopton Bl 10 Husband Wife Widow }
 or of } Age of Husband or Wife (if living).....

Charge to:
 Address:
 Order given by Horace Woodham
 (or informant)
 How Secured:
 If Veteran, State War
 Occupation Truck Driver
 (Social Security Number)
 Employer and Address

Date of Death Oct 29 - 48 (7:00 PM)
 (Date) (Hour)
 Date of Birth Oct 10 - 1927
 Age 21 19
 (Years) (Months) (Days)
 Date of Funeral Oct 31 BA
 (Date) (Day of Week) (Hour)

Services at: Clopton M.E.
 Clergyman: Rev. M. E. Duffey
 (Address)
 Religion of the Deceased
 Birthplace Dale Co. Ala.
 Resided in the State
 (or U. S. or City or County) (Years) (Months)

Place of Death Highway
 Cause of Death Truck Accident
 Contributory Causes Broken Wheel

Certifying Physician Tom Hoff
 (or Coroner)
 His Address: Coroner
 Name of Father Horace Woodham
 His Birthplace Henry Co. Ala.
 Maiden Name of Mother Ozie Walker
 Her Birthplace Barbour Co. Ala.

Motor } Remains to
 Ship }
 Size of Casket
 (State Color and Number)
 Manufactured by:
 Cemetery } Clopton
 Crematory }
 10 CHURCH

Complete Funeral (except outlays)	\$
Casket	
Burial Vault or Box	(State Kind)
Embalming Body	(Name of Embalmer)
Barber, \$	Hair Dressing, \$
Dressing Body, \$	Underwear, \$
Suit or Dress	(State Kind and Color)
Slippers, \$	Hose, \$
Folding Chairs, \$	Tarpaulin, \$
Candelabrum, \$	Candles, \$
Door Spray, \$	Gloves, \$
Funeral Car, \$	Ambulance, \$
Limousines to Cemetery	@ \$
Extra Limousines	@ \$
Autos to R. R. Station	@ \$
Getting Remains from	
Taking Remains to	
Trip to Coroner's Inquest	
Delivering Box to	
Deliver Flowers to	
Removal Charges	
Procuring Burial Permit	(State Number and District)
_____ Certif. Copies of Death Certificates No. _____	(State Physician's or Coroner's)
Pall Bearer Service, \$	Use of Chapel, \$
Gross Total for Sales Tax	\$
Outlay for Lot:	
Cremation	
Flowers, \$	Palms, \$
Rental of Tent, \$	of Temporary Vault, \$
Opening of Grave or Tomb	
Lining Grave, \$	Lowering Device, \$
Outlay for Shipping Charges	
Clergyman, \$	Singers, \$
Road } Tickets, \$	Aero- plane Service, \$
or Motor }	
Telegr., Phone, Cable or Radio Charges	
Cash Advanced	
Out of town Undertaker's Charges	
Personal Service	
..... line Death Notices in	Papers
.....	(Names of Newspapers)
Sales Tax	
Total Footing of Bill	

See # 5
 10/31/48

Clopton Man Killed

Lot No.
 Grave No.

Total No. 6138 Yearly No. 128 Date of Entry Oct 29
 Name of Deceased Joseph Earl Woodham
 Married Single Widowed Divorced (What Race)
 Residence: Clopton Bt 10 Husband Wife Widow }
 or of } Age of Husband or Wife (if living).....
 Charge to:
 Address:
 Order given by: Harace Woodham (or informant)
 How Secured:
 If Veteran, State War
 Occupation: Truck Driver (Social Security Number)
 Employer and Address
 Date of Death: Oct 29 - 4 8 (70M) (Date) (Hour)
 Date of Birth: Oct 10 - 1927 (Date) (Hour)
 Age: 21 (Years) 19 (Months) (Days)
 Date of Funeral: Oct 31 (Date) 8 AM (Hour) (Day of Week)
 Services at: Clopton M.E.
 Clergyman: Rev. M. L. Duffey (Address)
 Religion of the Deceased
 Birthplace: Dale Co. Ala
 Resided in the State: (or U. S. or City or County) (Years) (Months)
 Place of Death: Hiway
 Cause of Death: Truck Accident
 Contributory Causes: Broken Wheel
 Certifying Physician: Tom Goff (or Coroner)
 His Address: Coroner
 Name of Father: Harace Woodham
 His Birthplace: Henry Co. Ala
 Maiden Name of Mother: Ozie Walker
 Her Birthplace: Barham Co. Ala
 Motor } Remains to
 Ship }
 Size of Casket: (State Color and Number)
 Manufactured by:
 Cemetery }
 Crematory }

Complete Funeral (except outlays) \$
 Casket
 Burial Vault or Box (State Kind)
 Embalming Body (Name of Embalmer)
 Barber, \$ Hair Dressing, \$
 Dressing Body, \$ Underwear, \$
 Suit or Dress (State Kind and Color)
 Slippers, \$ Hose, \$
 Folding Chairs, \$ Tarpaulin, \$
 Candelabrum, \$ Candles, \$
 Door Spray, \$ Gloves, \$
 Funeral Car, \$ Ambulance, \$
 Limousines to Cemetery @ \$
 Extra Limousines @ \$
 Autos to R. R. Station @ \$
 Getting Remains from
 Taking Remains to
 Trip to Coroner's Inquest
 Delivering Box to
 Deliver Flowers to
 Removal Charges
 Procuring Burial Permit (State Number and District)
 Certif. Copies of Death Certificates No. (State Physician's or Coroner's)
 Pall Bearer Service, \$ Use of Chapel, \$
 Gross Total for Sales Tax \$
 Outlay for Lot:
 Cremation
 Flowers, \$ Palms, \$ Matting, \$
 Rental of Tent, \$ of Temporary Vault, \$
 Opening of Grave or Tomb
 Lining Grave, \$ Lowering Device, \$
 Outlay for Shipping Charges
 Clergyman, \$ Singers, \$ Organist, \$
 Railroad } Tickets, \$ Aero-
 or Motor } plane Service, \$
 Telegr., Phone, Cable or Radio Charges
 Cash Advanced
 Out of town Undertaker's Charges
 Personal Service
 line Death Notices in Papers
 (Names of Newspapers)
 Sales Tax
 Total Footing of Bill \$
 Less \$
 Balance \$
 Entered into Ledger, page or below.

See #5

Clopton Man Killed As Truck Overturns

OZARK (Special) — Joseph Earl Woodham, 21, of Clopton, was instantly killed Friday night when a truck he was driving overturned in Clopton.

Investigating highway patrolmen said Woodham was alone in the truck and that no other vehicle was involved in the accident. Woodham was hauling a load of peanuts, they said, and apparently the lights went out on his truck. The vehicle slowed across the

Amount Paid	Balance	Date	Amount Paid	Balance
			To Balance Forward	\$
			By Payment	\$
				\$

RECORD OF FUNERAL

Total No. _____ Yearly No. 44-1557 Date of Entry Monday - SEPT 17 1962

Name of Deceased GLADYS THARPE WOODHAM
 Married Single Widowed Divorced W (What Race)

Residence OZARK, ALA.
or _____ of _____ } Age of Husband or Wife (if living) _____

Charge to JOSEPH WOODHAM

Address OZARK

Order given by SAME (or informant)

How Secured _____

If Veteran, Name of War _____ 258-22-5870

Occupation WATER TREATMENT - EMPLOYEE (Social Security Number) _____

Employer and Address OZARK, ALA.

Date of Death SEPT. 17 - MON. 1962 ARX 7A
(Mo.) (Day) (Yr.) (Hour)

Date of Birth July 8 1919 Age 43
(Mo.) (Day) (Yr.) (Yrs.) (Mos.) (Days)

Name of Father Edward Sharpe

His Birthplace _____

Maiden Name of Mother Maggie Herring

Her Birthplace _____

Date of Funeral SEPT. 19 - TUESDAY - 4:30 P.M.
(Date) (Day of Week) (Hour)

Services at MT. CARMEL METH

Clergyman Rev. J. H. Jems - Rev. Wm Snellgrove (Address) _____

Religion of the Deceased Methodist

Birthplace Dale Co. Ala.

Resided in the State ALA - DALE Co
(or U.S. or City or County) (Years) (Months)

Place of Death Highway 27 - KUMH ROAD

Cause of Death AUTO. ACCIDENT - HEAD ON

Contributory Causes SEVERE LACERATIONS

BROKEN NECK - BONES - Crushed Chest

Certifying Physician Harold Dick (or Coroner) _____

His Address Ozark, Ala.

Motor Ship } Remains to _____
Size of Casket CALHOUN - SILVER - NEGLEGEE VERA LEE
(State Color and Number)

Manufactured by BROWN SERVICE

Cemetery } MT. CARMEL



Diagram of Lot or Vault

Lot No. _____
Grave No. _____
Section No. _____
Block No. _____
Owner _____

Misc. Shelley

Complete Funeral (except outlays)	\$ _____
Casket	_____
Burial Vault or Box	_____
Embalming Body <u>PAUL HAROLD VEAL</u> (Name of Embalmer)	_____
Barber, \$ _____ Hair Dressing, \$ _____	_____
Dressing Body, \$ _____ Underwear, \$ _____	_____
Suit or Dress _____	_____
Slippers, \$ _____ (State Kind and Color) _____	_____
Folding Chairs, \$ _____ Tarpaulin, \$ _____	_____
Candelabrum, \$ _____ Candles, \$ _____	_____
Door Spray, \$ _____ Gloves, \$ _____	_____
Funeral Car, \$ _____ Ambulance, \$ _____	_____
Limousines to Cemetery @ \$ _____	_____
Extra Limousines @ \$ _____	_____
Autos to R. R. Station @ \$ _____	_____
Getting Remains from _____	_____
Taking Remains to _____	_____
Trip to Coroner's Inquest _____	_____
Delivering Box to _____	_____
Deliver Flowers to _____	_____
Removal Charges _____	_____
Procuring Burial Permit _____	_____
_____ Certif. Copies of Death Certificates No. _____ (State Number and District)	_____
_____ (State Physician's or Coroner's)	_____
Pall Bearer Service, \$ _____ Use of Chapel, \$ _____	_____
Gross Total for Sales Tax _____ \$ _____	_____
Outlay for Lot _____	_____
Cremation _____	_____
Flowers, \$ _____ Palms, \$ _____ Matting, \$ _____	_____
Rental of Tent, \$ _____ of Temporary Vault, \$ _____	_____
Opening of Grave or Tomb _____	_____
Lining Grave, \$ _____ Lowering Device, \$ _____	_____
Outlay for Shipping Charges _____	_____
Clergymen, \$ _____ Singers, \$ _____ Organist, \$ _____	_____
Railroad { Tickets, \$ _____ Aero- _____ plane Service, \$ _____	_____
or Motor { _____	_____
Telegr., Phone, Cable or Radio Charges _____	_____
Cash Advanced _____	_____
Out of town Funeral Director's Charges _____	_____
Personal Service _____	_____
_____ line Death Notices in _____ Papers _____	_____
(Names of Newspapers) _____	_____
Sales Tax _____	_____
Total Footing of Bill _____ \$ _____	_____
Less _____ \$ _____	_____
Balance _____ \$ _____	_____
Entered into Ledger, page _____	_____

Mrs. Gladys T. Woodham
OZARK - Funeral services for
Mrs. Gladys Tharpe Woodham,
will be held today at 4:30
Methodist.



HOLMAN'S BROWN SERVICE FUNERAL HOME

Modern Funeral Service

309 WEST REYNOLDS STREET

TELEPHONE 774-5348

OZARK, ALABAMA

Oct. 1962

A. KENNETH HOLMAN

24 HOUR SERVICE

TO WHOM IT MAY CONCERN:

THIS IS TO CERTIFY THAT I, JOSEPH WOODHAM AUTHORIZED AND EMPLOYED
HOLMAN FUNERAL HOME TO MOVE THE REMAINS OF MY WIFE, MRS GLADYS
EMARPE WOODHAM FROM MT. CARMEL CEMETERY TO CHALK HEAD CEMETERY.

SIGNED:

Joseph Woodham

WITNESS:

Harold Dick



HOLMAN'S BROWN SERVICE FUNERAL HOME

Modern Funeral Service

309 WEST REYNOLDS STREET

TELEPHONE 774-5348

OZARK, ALABAMA

Oct. 1962

A. KENNETH HOLMAN

24 HOUR SERVICE

TO WHOM IT MAY CONCERN:

THIS IS TO CERTIFY THAT I, JOSEPH WOODHAM AUTHORIZE AND EMPLOYE
HOLMAN FUNERAL HOME TO MOVE THE REMAINS OF MY WIFE, MRS GLADYS
THARPE WOODHAM FROM MT. CARMEL CEMETERY TO CHALK HEAD CEMETERY.

SIGNED:

Joseph Woodham

WITNESS:

Fred Dick

No. 290

RECORD OF FUNERAL

Total No. 21

Yearly No. 158

Date of Entry OCTOBER 28 1979

Name of Deceased LOUIS S. WOODHAM

Married Single Widowed Divorced

Residence RT. 3 Box 241-OZARK Husband Wife Widow

CAU
(What Race)
PEARL HARRIS
Age of Husband or Wife (If living) Yes

Charge to MRS. PEARL HARRIS WOODHAM

Address SAME AS ABOVE

Order given by WIFE
(or informant)

How Secured _____
If Veteran, Name of War WW I

Occupation FARMER 424-54-4496
(Social Security Number)

Employer and Address _____

Date of Birth FEB. 12, 1893 Age 86
(M.) (Day) (Yr.) (Mos.) (Days)

Birthplace DALE COUNTY

Date of Death OCT. 28, 1979
(Mo.) (Day) (Yr.) (Hour)

Place of Death DALE COUNTY HOSPITAL

Name of Father JASPER WOODHAM

His Birthplace _____

Maiden Name of Mother LAURA WOODHAM

Her Birthplace _____

Date of Funeral OCT. 29 MON 3P. M.
(Date) (Day of Week) (Hour)

Services at EWELL BIBLE CHURCH

Clergyman G.L. WYNN & RON JACKSON
(Address)

Religion of the Deceased _____

Resided in the State _____
(or U.S. or City or County) (Years) (Months)

Cause of Death MYOCARDIAL INFARCTION

Contributory Causes _____

Certifying Physician R. J. McLAUGHLIN, MD
(or Coroner)

His Address OZARK, AL

Truck } Remains to
Ship } 18 GA SPARTAN GUNMETAL #10779

Size of Casket _____
(State Color and Number)

Manufactured by AURORA

Cemetery } EWELL CEMETERY
(Crematory) }



Diagram of Lot or Vault

Lot No. _____
Grave No. _____
Section No. _____
Block No. _____
Owner _____

Misc. _____

Complete Funeral (except outlays) _____ \$

Casket _____

Burial Vault or Box _____

Embalming Body EARL (State Kind)
(Name of Embalmer)

Misc. _____

Dressing Body, \$ 210 Underwear, \$ _____

Suit or Dress _____
(State Kind and Color)

Slippers, \$ _____ Hose, \$ _____

Folding Chairs, \$ _____ Tarpaulin, \$ _____

Candelabrum, \$ _____ Candles, \$ _____

Door Spray, \$ _____ Gloves, \$ _____

Funeral Car, \$ _____ Ambulance, \$ _____

Limousines to Cemetery @ \$ _____

Extra Limousines @ \$ _____

Flower Car @ \$ _____

Autos to R.R. or Air @ \$ _____

Getting Remains from _____

Taking Remains to _____

Trip to Coroner's Inquest _____

Misc. _____

Removal Charges _____

Procuring Burial Permit _____
(State No.)

Church with the Rev. G.I. Wynn and Ron Jackson officiating. Burial was in the Ewell Cemetery with Holman Funeral Home in charge.

Louis S. Woodham
Pa OZARK— Louis S. Woodham, 87 of the Ewell Community died in the Dale County Hospital Sunday afternoon following an extended illness. Funeral services were held at 3:00 p.m. Monday from the Ewell Bible

Survivors include his wife, Mrs. Pearl Harris Woodham of Ozark; two sons, Richard Louis Woodham of Ozark and Robert Jefferson Woodham, Panama City; two brothers Homer and Ray Woodham both of Ozark; four grand children also survive.

or Truck } Tickets, \$ _____ Air _____

Telegr., Phone, Cable or Radio Charge _____

Cash Advanced _____

Out of town Funeral Director's Charges _____

Personal Service _____

_____ line Death Notices in _____ Papers

(Names of Newspapers)

Sales Tax _____

Totaling Footing of Bill _____ \$

Less _____ \$

Balance _____ \$

Entered into Ledger, page _____ or below.

Misc. _____

Misc. OGR/12-4-79

RECORD OF FUNERAL

Total No. 1120 Yearly No. 79 Date July 21 1919
 Name of Deceased Inf son of L. S. Woodhan (Single — Married — Divorced) (What Race) (Where Born)
 Residence of Deceased L. S. Woodhan Husband—Wife—Widow— }
 or of }

Charge to
 Address
 Order given by (or informant)
 How Secured
 Occupation of Deceased
 Name of Employer
 Address
 Date of Death (Date) (Hour)
 Date of Birth
 Age 0 (Years) 0 (Months) 0 (Days)
 Date of Funeral July 21 (Date) (Day of Week) 3 P. M. (Hour)
 Services at
 Clergyman
 His Address
 Religion of the Deceased
 Resided in the State (or U. S. or City or County) (Years) (Months)
 Place of Death
 Cause of Death
 Contributory Causes
 Certifying Physician (or Coroner)
 His Address
 Name of Father L. S. Woodhan
 His Birthplace Sale Co.
 Maiden Name of Mother Lure Moore
 Her Birthplace
 Motor } Remains to
 Ship }
 Size and Style of Casket (State Color)
 Manufactured by
 Interment at Emwell { Cemetery
 Crematory

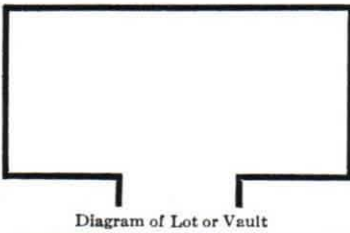

Lot No.
 Grave No.
 Section No.
 Owner

Complete Funeral	\$	100
Casket	\$	Taf
Metallic Lining	(State Kind)	
Outside Box	(State Kind)	
Burial Vault	(State Kind)	
Embalming Body	with	Fluid
Barber, \$	Hair Dressing, \$	
Dressing Body		
Suit or Dress, \$	Hose, \$	
Underwear, \$	Slippers, \$	
Folding Chairs, \$	Tarpaulin, \$	
Candelabrum, \$	Candles, \$	
Door Badge, \$	Gloves, \$	
Hearse, \$	Ambulance, \$	
Limousines to Cemetery	@ \$	
Autos to R. R. Station	@ \$	
Getting Remains from		
Taking Remains to		
Trip to Coroner's Inquest		
Delivering Box to		
Flowers to		
Removal Charges		
Procuring Burial Permit	(State Number and District)	
_____ Certif. Copies of Death Certificates No. _____	(State Physician's or Coroner's)	
Pall Bearer Service, \$	Use of Chapel, \$	
Personal Service		
Outlay for Lot		
Cremation		
..... line Death Notices in	Papers	
Flowers, \$	(Names of Newspapers) Palms, \$	Matting, \$
Rental of Tent, \$	of Temporary Vault, \$	
Opening of Grave or Tomb		
Lining Grave, \$	Lowering Device, \$	
Outlay for Shipping Charges		
Clergyman, \$	Singers, \$	Organist, \$
Railroad } Tickets, \$	Aero-	plane Service, \$
or Motor }		
Telegr., Phone, Cable or Radio Charges		
Cash Advanced		
Out of town Undertaker's Charges		
Total Footing of Bill	\$	
Less	\$	
Balance	\$	
Entered into Ledger, page		or below.

RECORD OF FUNERAL

6

Total No. 1770 Yearly No. 38 Date of Entry March 18 1941
 Name of Deceased Lloyd Powell Woodham White (What Race)
 Married Single Widowed Divorced
 Residence Ozark Pt 3 - B. 14 - Husband Wife Widow } or of } Age of Husband or Wife (if living) Years

Charge to:
 Address:
 Order given by: (or informant)
 How Secured:
 If Veteran, State War:
 Occupation: (Social Security Number)
 Employer and Address:
 Date of Death 3-18-41 (Date) (Hour)
 Date of Birth:
 Age Jan 19 (Years) (Months) (Days)
 Date of Funeral March 19 (Date) (Day of Week) (Hour) M.
 Services at Chatham Church
 Clergyman: (Address)
 Religion of the Deceased:
 Birthplace Dale
 Resided in the State Tenn (or U.S. or City or County) (Years) (Months)
 Place of Death Dothan Army Hospital
 Cause of Death Auto accident
 Contributory Causes:
 Certifying Physician: (or Coroner)
 His Address: Chatham Sta
 Name of Father Carl O. Woodham
 His Birthplace Dale
 Maiden Name of Mother Cora Frances Barlette
 Her Birthplace Dale
 Remains to be placed in Casket:
 Manufactured by: (State Color and Number)
 Burial place: Chalk Head Church

Complete Funeral (except outlays).....	\$	
Casket.....		65 00
Burial Vault or Box..... (State Kind)		25 00
Embalming Body..... (Name of Embalmer)		25 00
Barber, \$.....		
Hair Dressing, \$.....		
Dressing Body, \$.....		
Underwear, \$.....		
Suit or Dress..... (State Kind and Color)		
Slippers, \$.....		
Hose, \$.....		
Folding Chairs, \$.....		
Tarpaulin, \$.....		
Candelabrum, \$.....		
Candles, \$.....		
Door Spray, \$.....		
Gloves, \$.....		
Funeral Car, \$.....		
Ambulance, \$.....		
Limousines to Cemetery..... @ \$		
Extra Limousines..... @ \$		
Autos to R. R. Station..... @ \$		
Getting Remains from.....		
Taking Remains to.....		
Trip to Coroner's Inquest.....		
Delivering Box to.....		
Deliver Flowers to.....		
Removal Charges.....		
Procuring Burial Permit..... (State Number and District)		
Certif. Copies of Death Certificates No..... (State Physician's or Coroner's)		
Pall Bearer Service, \$.....		
Use of Chapel, \$.....		
Gross Total for Sales Tax..... \$		
Outlay for Lot.....		
Cremation.....		
Flowers, \$.....		
Palms, \$.....		
Matting, \$.....		
Rental of Tent, \$.....		
of Temporary Vault, \$.....		
Opening of Grave or Tomb.....		
Lining Grave, \$.....		
Lowering Device, \$.....		
Outlay for Shipping Charges.....		
Clergyman, \$.....		
Singers, \$.....		
Organist, \$.....		
Train or Motor } Tickets, \$.....		
Aero-plane } Service, \$.....		
Telegr., Phone, Cable or Radio Charges.....		
Cash Advanced.....		
Out of town Undertaker's Charges.....		
Personal Service.....		
..... line Death Notices in..... Papers		
(Names of Newspapers)		
Sales Tax.....		
Total Footing of Bill..... \$		
Less..... \$		
Balance..... \$		
Entered into Ledger, page..... or below.		

Lot No. Newils Pt.
 Grave No. Dothan
 Section No. Rt 2
 Block No. South Bay
 Owner Ozark Pt. 3
 Diagram of Lot or Vault See
 Date March 19 1941 Amount Paid 200 00 Balance 0 00
 To Lottie Woodham

RECORD OF FUNERAL

Total No. 1144 Yearly No. 103 Date Sept 9 1937
 Name of Deceased M. B. Woodham (Single — Married — Divorced) W (What Race) (Where Born)

Residence of Deceased
 Charge to Brown Series
 Address
 Order given by (or informant)

How Secured
 Occupation of Deceased
 Name of Employer
 Address

Date of Death Sept 9, 1937 (Date) (Hour)

Date of Birth (Year) (Months) (Days)

Age
 Date of Funeral Sept 10, 1937 (Date) (Day of Week) (Hour) M.

Services at
 Clergyman

His Address

Religion of the Deceased

Resided in the State (or U. S. or City or County) (Years) (Months)

Place of Death at home

Cause of Death

Contributory Causes

Certifying Physician Dr. W. A. Parish (or Coroner)

His Address Midland City

Name of Father Daniel Woodham

His Birthplace unk.

Maiden Name of Mother Sawette

Her Birthplace unk.

Motor } Remains to
 Ship }

Size and Style of Casket (State Color)

Manufactured by

Interment at { Cemetery
 Crematory

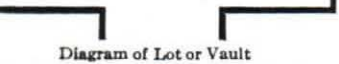

Lot No.
 Grave No.
 Section No.
 Owner

Complete Funeral	\$
Casket	
Metallic Lining	(State Kind)
Outside Box	(State Kind)
Burial Vault	(State Kind)
Embalming Body	with Fluid
Barber, \$	Hair Dressing, \$
Dressing Body	
Suit or Dress, \$	Hose, \$
	(State Color)
Underwear, \$	Slippers, \$
Folding Chairs, \$	Tarpaulin, \$
Candelabrum, \$	Candles, \$
Door Badge, \$	Gloves, \$
Hearse, \$	Ambulance, \$
Limousines to Cemetery	@ \$
Autos to R. R. Station	@ \$
Getting Remains from	
Taking Remains to	
Trip to Coroner's Inquest	
Delivering Box to	
Flowers to	
Removal Charges	
Procuring Burial Permit	
(State Number and District)	
Certif. Copies of Death Certificates No.	
(State Physician's or Coroner's)	
Pall Bearer Service, \$	Use of Chapel, \$
Personal Service	
Outlay for Lot	
Cremation	
line Death Notices in	Papers
(Names of Newspapers)	
Flowers, \$	Palms, \$
Matting, \$	
Rental of Tent, \$	of Temporary Vault, \$
Opening of Grave or Tomb	
Lining Grave, \$	Lowering Device, \$
Outlay for Shipping Charges	
Clergyman, \$	Singers, \$
Organist, \$	
Railroad } Tickets, \$	Aero-
or Motor }	plane Service, \$
Telegr., Phone, Cable or Radio Charges	
Cash Advanced	
Out of town Undertaker's Charges	
Total Footing of Bill	\$
Less	\$
Balance	\$
Entered into Ledger, page	or below.

To Funeral Charges... Total, \$ By Cash \$

RECORD OF FUNERAL

Total No. 840 Yearly No. 162 Date Nov. 12 1919

Name of Deceased Nancy P. Riley (Single — Married — Divorced) White (What Race) Ala. (Where Born)

Residence of Deceased Echo Husband—Wife—Widow— }
or of }

Charge to: Charles Riley
Address: Echo

Order given by (or informant)

How Secured
Occupation of Deceased Housewife

Name of Employer
Date of Death Nov. 12 (Date) 6: P.M. (Hour)

Date of Birth
Age 53 (Years) (Months) (Days)

Date of Funeral Nov. 13 (Date) wed (Day of Week) 2:00 P.M. (Hour)

Services at: Echo
Clergyman

His Address

Religion of the Deceased

Resided in the State (or U. S. or City or County) (Years) (Months)

Place of Death at home

Cause of Death

Contributory Causes

Certifying Physician Dr. Cotter (or Coroner)

His Address Newton Woodham

Name of Father Dale G.

His Birthplace Elyria, Deal

Maiden Name of Mother Ala

Her Birthplace

Motor } Remains to
Ship }
Size and Style of Casket 6 1/2 out. hng. cap. Pluch (State Color)

Manufactured by

Interment at Echo { Cemetery
Crematory

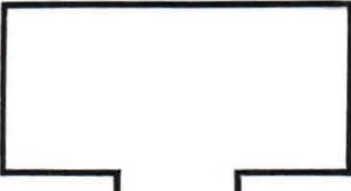

Diagram of Lot or Vault

Lot No.
Grave No.
Section No.
Owner

Complete Funeral	\$ <u>1.25</u>
Casket	
Metallic Lining	
Outside Box	(State Kind)
Burial Vault	<u>Joneston</u> (State Kind)
Embalming Body	with Fluid
Barber, \$	Hair Dressing, \$
Dressing Body	
Suit or Dress, \$	Hose, \$
Underwear, \$	Slippers, \$
Folding Chairs, \$	Tarpaulin, \$
Candelabrum, \$	Candles, \$
Door Badge, \$	Gloves, \$
Hearse, \$	Ambulance, \$
Limousines to Cemetery	@ \$
Autos to R. R. Station	@ \$
Getting Remains from	
Taking Remains to	
Delivering Box to	
Flowers to	
Removal Charges	
Procuring Burial Permit	
..... Certif. Copies of Death Certificates No.	(State Number and District)
.....	(State Physician's or Coroner's)
Pall Bearer Service	
Personal Service	
Use of Chapel	
Outlay for Lot	
Death Notices in	Newspapers
.....	(Names of Newspapers)
Flowers, \$	Rental of Palms, \$
Rental of Tent, \$	of Temporary Tomb, \$
Lowering Device, \$	Cremation, \$
Opening of Grave or Tomb	
Lining Grave, \$	Matting, \$
Outlay for Shipping Charges	
Clergyman, \$	Singers, \$
.....	Organist, \$
Railroad } Tickets, \$	Aero-plane Service, \$
or Motor }	
Telegr., Phone, Cable or Radio Charges	
Cash Advanced	
Out of town Undertaker's Charges	
Total Footing of Bill	\$
Less	\$
.....	\$
Balance	\$
Entered into Ledger, page	or below.

RECORD OF FUNERAL

Total No. 1311 Yearly No. 127 Date Oct 5 19

Name of Deceased Need W Woodham
(Single — Married — Divorced) (What Race) (Where Born)

Residence of Deceased (Midland City Beat 9) Husband—Wife—Widow—
or of }

Charge to

Address

Order given by

(or informant)

How Secured

Occupation of Deceased

Name of Employer

Address

Date of Death Oct 5 8:30 P
(Date) (Hour)

Date of Birth

Age 87
(Years) (Months) (Days)

Date of Funeral Oct 6 2 P M.
(Date) (Day of Week) (Hour)

Services at Echo

Clergyman Mr. Hubs

His Address Echo

Religion of the Deceased

Resided in the State

(or U. S. or City or County) (Years) (Months)

Place of Death

Cause of Death

Contributory Causes

Certifying Physician D. W. A. Lester
(or Coroner)

His Address Ozark

Name of Father J. Woodham

His Birthplace

Maiden Name of Mother Candis Riley

Her Birthplace Iller

Motor } Remains to

Ship } 699 1/2 B.B.H.
(State Color)

Manufactured by

Interment at Echo { Cemetery
 Crematory

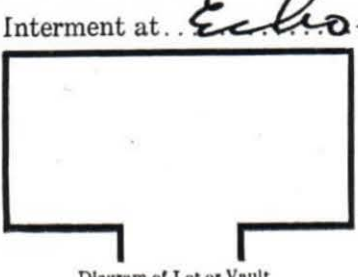

Lot No.

Grave No.

Section No.

Owner

Complete Funeral	\$
Casket	
Metallic Lining <u>Brown Severe</u>	(State Kind)
Outside Box	(State Kind)
Burial Vault	(State Kind)
Embalming Body	with Fluid
Barber, \$	Hair Dressing, \$
Dressing Body	
Suit or Dress, \$	Hose, \$
Underwear, \$	Slippers, \$
Folding Chairs, \$	Tarpaulin, \$
Candelabrum, \$	Candles, \$
Door Badge, \$	Gloves, \$
Hearse, \$	Ambulance, \$
Limousines to Cemetery	@ \$
Autos to R. R. Station	@ \$
Getting Remains from	
Taking Remains to	
Trip to Coroner's Inquest	
Delivering Box to	
Flowers to	
Removal Charges	
Procuring Burial Permit	(State Number and District)
_____ Certif. Copies of Death Certificates No. _____	(State Physician's or Coroner's)
Pall Bearer Service, \$	Use of Chapel, \$
Personal Service	
Outlay for Lot	
Cremation	
..... line Death Notices in	Papers
.....	(Names of Newspapers)
Flowers, \$	Palms, \$
Matting, \$	
Rental of Tent, \$	of Temporary Vault, \$
Opening of Grave or Tomb	
Lining Grave, \$	Lowering Device, \$
Outlay for Shipping Charges	
Clergyman, \$	Singers, \$
Organist, \$	
Railroad } Tickets, \$	Aero-
or Motor }	plane Service, \$
Telegr., Phone, Cable or Radio Charges	
Cash Advanced	
Out of town Undertaker's Charges	

Total Footing of Bill

Less

Balance

Entered into Ledger, page or below.

To Funeral Charges... Total, \$ By Cash \$

RECORD OF FUNERAL

Total No. 6099 / 69 Yearly No. 69 Date of Entry May 31 1948

Name of Deceased Ollie Orvis Woodham (What Race) _____
 Married Single Widowed Divorced

Residence: Milland City St 2 Husband Wife Widow }
 or of } Age of Husband or Wife (if living)

Charge to:
 Address:

Order given by P. O. Woodham
 (or informant)

How Secured:
 If Veteran, State War

Occupation (Social Security Number)

Employer and Address
 Date of Death May 31, 1948
 (Date) (Hour)

Date of Birth Feb 6, 1891
 (Date) (Hour)

Age 57
 (Years) (Months) (Days)

Date of Funeral June 1, 1948 3 P.M.
 (Date) (Day of Week) (Hour)

Services at Sylvan Grove
 Clergyman Baldwin Jordan
 (Address)

Religion of the Deceased
 Birthplace Dale Co. Ala

Resided in the State (or U. S. or City or County) (Years) (Months)

Place of Death

Cause of Death

Contributory Causes

Certifying Physician Dr. Parrish
 (or Coroner)

His Address Milland City

Name of Father Nelson Woodham

His Birthplace

Maiden Name of Mother Edmonia Woodham

Her Birthplace Dale Co. Ala

Motor } Remains to
 Ship }
 Size of Casket (State Color and Number)

Manufactured by
 Cemetery } Sylvan Grove
 Crematory }



Lot No.
 Grave No.
 Section No.
 Block No.
 Owner

Diagram of Lot or Vault

Complete Funeral (except outlays)	\$ <u>250.</u>
Casket	<u>65.</u>
Burial Vault or Box	<u>35.</u>
Embalming Body	<u>15.</u>
Barber, \$.....	Hair Dressing, \$.....
Dressing Body, \$.....	Underwear, \$.....
Suit or Dress
Slippers, \$.....	Hose, \$.....
Folding Chairs, \$.....	Tarpaulin, \$.....
Candelabrum, \$.....	Candles, \$.....
Door Spray, \$.....	Gloves, \$.....
Funeral Car, \$.....	Ambulance, \$.....
Limousines to Cemetery	@ \$.....
Extra Limousines	@ \$.....
Autos to R. R. Station	@ \$.....
Getting Remains from	
Taking Remains to	
Trip to Coroner's Inquest	
Delivering Box to	
Deliver Flowers to	
Removal Charges	
Procuring Burial Permit	
..... Certif. Copies of Death Certificates No.	
Pall Bearer Service, \$.....	Use of Chapel, \$.....
Gross Total for Sales Tax	\$.....
Outlay for Lot	
Cremation	
Flowers, \$.....	Palms, \$.....
Rental of Tent, \$.....	of Temporary Vault, \$.....
Opening of Grave or Tomb	
Lining Grave, \$.....	Lowering Device, \$.....
Outlay for Shipping Charges	
Clergyman, \$.....	Singers, \$.....
Railroad } Tickets, \$.....	Aero-
or Motor } plane Service, \$.....	
Telegr., Phone, Cable or Radio Charges	
Cash Advanced	
Out of town Undertaker's Charges	
Personal Service	
..... line Death Notices in	Papers
.....	(Names of Newspapers)
Sales Tax	<u>66</u>
Total Footing of Bill	\$ <u>271.</u>
Less	\$.....
Balance	\$.....
Entered into Ledger, page or below.	

Date	Amount Paid	Balance	Date	Amount Paid	Balan

RECORD OF FUNERAL

No. 22

MONTH 18 Yearly No. 87 Date of Entry May 26 1977

Name of Deceased Ovie Thomas Woodham CA 4
 Married Single Widowed Divorced
 Residence Rt. 1, Box 230 Midland City, Ala Lucille M. Woodham
 Charge to Mrs. Lucile M. Woodham Age of Husband or Wife (If living).....Years

Address same as above
 Order given by wife (or informant)
 How Secured

If Veteran, Name of War U U I F
 Occupation Civil Service 417-32-4921
 Employer and Address

Date of Birth July 17 1917 Age 59
 Birthplace Dale County

Date of Death May 26 1977
 Place of Death Hwy 27 near Echo

Name of Father Travis Woodham
 His Birthplace

Maiden Name of Mother Mollie Marshall
 Her Birthplace

Date of Funeral May 28 Sat 2:00 P. M.
 Services at Mt. Carmel Methodist
 Clergyman Rev. Harvey Henderson, James L. Harbert

Religion of the Deceased

Resided in the State

Cause of Death Car accident - broken neck
 Contributory Causes

Certifying Physician Harold Dick
 His Address Ozark, Alabama

Size of Casket 20 Ga. Steel
 Manufactured by Tacca Casket Company
 Cemetery Mt. Carmel Cemetery

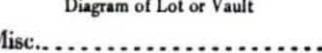

Lot No.
 Grave No.
 Section No.
 Block No.
 Owner

Complete Funeral (except outlays)	\$
Casket	
Burial Vault or Box	
Embalming Body	(State) <u>T.S.</u>
Misc.	(Name of Embalmer)
Dressing Body, \$	Underwear, \$
Suit or Dress	Ovie T. Woodham
Slippers, \$	MIDLAND CITY—Ovie
Folding Chairs, \$	T. Woodham, 59, of
Candelabrum, \$	Midland City, Rt. 1, died
Door Spray, \$	instantly in a car accident
Funeral Car, \$	13 miles east of Ozark on
Limousines to Cem.	Hwy. 27 late Thursday p.m.
Extra Limousines	Funeral services were
Flower Car	held from Mt. Carmel
Autos to R.R. or Ai	Methodist Church with the
Getting Remains fro	Rev. James L. Harbert and
Taking Remains to	Harvey Henderson officiat-
Trip to Coroner's In	ing. Interment followed in
Misc.	the church cemetery with
Removal Charges	Holman Funeral Home in
Procuring Burial Per	charge.
..... Certif. Copies	Mr. Woodham was a
Pall Bearer Service, \$	member of the Mt. Carmel
Gross Total for Sales	Methodist Church and a
Outlay for Lot	veteran of World War II.
Cremation	He was a civil service
Flowers, \$	employee at Ft. Rucker.
Rental of Tent, \$	Palr He is survived by his
Opening of Grave or	wife, Mrs. Lucile M.
Lining Grave, \$	Woodham, Midland City,
Outlay for Shipping	Rt. 1; one daughter, Linda
Clergymen, \$	Woodham, Midland City,
Railroad } Tickets	Rt. 1; one step-daughter,
or Truck }	Mrs. Jackie Merritt, Gulf
Telegr., Phone, Cabl.	Breeze, Fla.; one step-son,
Cash Advanced	Franklin Platt, Philadelphi-
Out of town Funeral	a, Pa.; one brother, Perry
Personal Service	Woodham, Midland City,
..... line Death Not	Rt. 1; three grandchildren
..... (Names of Newspapers)	also survive.
Sales Tax	
Totaling Footing of Bill	\$
Less	\$
..... Balance	\$
Entered into Ledger, page	or below.

Misc. OAR/5-30

PERRY CASWELL WOODHAM Senior

("Cas")

The Funeral Home corrupted Perry Caswell's name to "Harr" Cass Woodham and turned this name into the newspaper and the name was corrupted in the obituary which appeared in the "SOUTHERN STAR" newspaper.

RECORD OF FUNERAL

al No. 331 Yearly No. 136 Date Dec. 30 1932

ne of Deceased Harry Cass Woodhurn W Oak Co.
(Single - Married - Divorced) (What Race) (Where Born)

and—Wife—Widow— of Mandy.

ation Farmer.

ne of Employer

ge to Jess Carroll 25°° Mo W. Road 55°°

ress Ozark

nection

er given by alone

7 Secured

e of Funeral 1-1-33 Sun 2 P.M.
(Date) (Day of Week) (Hour)

ices at Res. Yuille

gyman Rev. Baldwin

Address Pinckard

ifying Physician Dr. N. L. Holman
(or Coroner)

Address Ozark

se of Death

tributory Causes

arks

se of Death 12-30-32 10:15 A.M.

se of Death Rev.

gion

ded in the State Life
(Years) (Months)

se of Birth

66 Years Month Days

ne of Father Moses Woodhurn

Birthplace Ida.

den Name of Mother Don't know

Birthplace

r} Body to

and Style of Casket 3

ufactured by Birmingham Casket Co.

ment at Woodhurn Cemetery
Crematory

Complete Funeral	\$	30	00
Casket			
Metallic Lining			
Outside Box	<small>(State Kind)</small>		
Burial Vault	<small>(State Kind)</small>		
Embalming Body	with	Fluid	
Barber, \$	Hair Dressing, \$		
Dressing Body			
Suit or Dress, \$	Hose, \$		
Underwear, \$	Slippers, \$		
Folding Chairs, \$	Tarpaulin, \$		
Candelabrum, \$	Candles, \$		
Door Badge, \$	Gloves, \$		
Hearse, \$	Ambulance, \$		
Limousines to Cemetery	@ \$		
Autos to R. R. Station	@ \$		
Getting Remains from			
Taking Body to			
Delivering Box to			
Flower Wagons			
Removal Charges			
Getting Burial Permit	<small>(State Number and District)</small>		
Certified Copies of Death Certificates			
Personal Charges			
Pall Bearer Service			
Outlay for Lot			
Death Notices in	Newspapers		
	<small>(Names of Newspapers)</small>		
Flowers, \$	Rental of Palms, \$		
Rental of Tent, \$	of Temporary Tomb, \$		
Lowering Device, \$	Cremation, \$		
Opening of Grave or Tomb			
Lining Grave, \$	Matting, \$		
Outlay for Shipping Charges			
Minister, \$	Singers, \$	Organist, \$	
Railroad Tickets, \$	Aeroplane Service, \$		
Telegr., Phone, Cable or Radio Charges			
Cash Advanced			
Total Footing of Bill	\$		
Less	\$		
Balance			
Entered into Ledger, page			\$

Lot No. _____

Grave No. _____

Section No. _____

Owner _____

Diagram of Lot or Vault

RECORD OF FUNERAL

14
id Dec 11 1948

Total No. 6144 Yearly No. 114 Date of Entry Dec 11 1948 1948

Name of Deceased Pilley O. Woodham
 Married Single Widowed Divorced (What Race) _____

Residence: 1111 N. Main St. Springfield, Mo.
 Husband Wife Widow }
 or of } Age of Husband or Wife (if living) 50 Ye

Charge to: Funeral Home
 Address: 1111 N. Main St. Springfield, Mo.

Order given by: _____
 (or informant)

How Secured: _____
 If Veteran, State War _____

Occupation: Fireman
 (Social Security Number) _____

Employer and Address: _____

Date of Death: Sept 28, 1948
 (Date) (Hour)

Date of Birth: Aug 7, 1898
 (Date) (Hour)

Age: 50
 (Years) (Months) (Days)

Date of Funeral: Sept 30, 1948 M.
 (Date) (Day of Week) (Hour)

Services at: Funeral Home

Clergyman: Rev. J. H. ...
 (Address)

Religion of the Deceased: _____

Birthplace: Springfield, Mo.

Resided in the State: _____
 (or U. S. or City or County) (Years) (Months)

Place of Death: Springfield, Mo.

Cause of Death: Heart Attack

Contributory Causes: _____

Certifying Physician: Dr. J. H. ...
 (or Coroner)

His Address: _____

Name of Father: John Woodham

His Birthplace: _____

Maiden Name of Mother: Elizabeth Woodham

Her Birthplace: _____

Motor } Remains to _____
 Ship }

Size of Casket: _____
 (State Color and Number)

Manufactured by: _____

Cemetery } _____
 Crematory }

Complete Funeral (except outlays)	\$
Casket	
Burial Vault or Box	(State Kind)
Embalming Body	(Name of Embalmer)
Barber, \$	Hair Dressing, \$
Dressing Body, \$	Underwear, \$
Suit or Dress	(State Kind and Color)
Slippers, \$	Hose, \$
Folding Chairs, \$	Tarpaulin, \$
Candelabrum, \$	Candles, \$
Door Spray, \$	Gloves, \$
Funeral Car, \$	Ambulance, \$
Limousines to Cemetery	@ \$
Extra Limousines	@ \$
Autos to R. R. Station	@ \$
Getting Remains from	
Taking Remains to	
Trip to Coroner's Inquest	
Delivering Box to	
Deliver Flowers to	
Removal Charges	
Procuring Burial Permit	(State Number and District)
Certif. Copies of Death Certificates	No. _____ (State Physician's or Coroner's)
Pall Bearer Service, \$	Use of Chapel, \$
Gross Total for Sales Tax	\$
Outlay for Lot	
Cremation	
Flowers, \$	Palms, \$
Matting, \$	
Rental of Tent, \$	of Temporary Vault, \$
Opening of Grave or Tomb	
Lining Grave, \$	Lowering Device, \$
Outlay for Shipping Charges	
Clergyman, \$	Singers, \$
Organist, \$	
Railroad or Motor } Tickets, \$	Aero-plane Service, \$
Telegr., Phone, Cable or Radio Charges	
Cash Advanced	
Out of town Undertaker's Charges	
Personal Service	
line Death Notices in	Papers
(Names of Newspapers)	
Sales Tax	
Total Footing of Bill	\$
Less	\$
Balance	\$
Entered into Ledger, page	or below.

Dale Commissioner Dies Unexpectedly

OZARK (Special) — Pilley O. Woodham, sixty-two, Dale County commissioner of district three, died unexpectedly in a doctor's office at midnight.

Lot No. _____
 Grave No. _____
 Section No. _____
 Block No. _____
 Owner _____

Date of Death (Date) (Hour)
 Date of Birth (Date) (Hour)
 Age (Years) (Months) (Days)
 Date of Funeral (Date) (Day of Week) (Hour) M.
 Services at
 Clergyman (Address)
 Religion of the Deceased
 Birthplace
 Resided in the State (or U. S. or City or County) (Years) (Months)
 Place of Death
 Cause of Death
 Contributory Causes
 Certifying Physician (or Coroner)
 His Address
 Name of Father
 His Birthplace
 Maiden Name of Mother
 Her Birthplace
 Motor Ship } Remains to
 Size of Casket (State Color and Number)
 Manufactured by
 Cemetery Crematory }

Folding Chairs, \$ Tarpaulin, \$
 Candelabrum, \$ Candles, \$
 Door Spray, \$ Gloves, \$
 Funeral Car, \$ Ambulance, \$
 Limousines to Cemetery @ \$
 Extra Limousines @ \$
 Autos to R. R. Station @ \$
 Getting Remains from
 Taking Remains to
 Trip to Coroner's Inquest
 Delivering Box to
 Deliver Flowers to
 Removal Charges
 Procuring Burial Permit (State Number and District)
 Certif. Copies of Death Certificates No. (State Physician's or Coroner's)
 Pall Bearer Service, \$ Use of Chapel, \$
 Gross Total for Sales Tax \$
 Outlay for Lot
 Cremation
 Flowers, \$ Palms, \$ Matting, \$
 Rental of Tent, \$ of Temporary Vault, \$
 Opening of Grave or Tomb
 Lining Grave, \$ Lowering Device, \$
 Outlay for Shipping Charges
 Clergyman, \$ Singers, \$ Organist, \$
 Railroad or Motor } Tickets, \$ Aero-plane Service, \$
 Telegr., Phone, Cable or Radio Charges
 Cash Advanced
 Out of town Undertaker's Charges
 Personal Service
 line Death Notices in Papers
 (Names of Newspapers)
 Sales Tax
 Total Footing of Bill \$
 Less \$
 Balance \$
 Entered into Ledger, page or below.

Dale Commissioner Dies Unexpectedly

OZARK (Special) — Pilley O. Woodham, sixty-two, Dale County commissioner of district three, died unexpectedly in a doctor's office at Midland City last midnight.

Death was attributed to a heart attack.

Mr. Woodham was appointed a commissioner by former Gov. Frank Dixon to serve out the unexpired term of the late John Brown and has served continuously since.

He was a steward in the Sylvan Grove Methodist church and an active member of the Woodmen of the World.

He is survived by the widow; eight daughters, Mrs. Cody Marshall, Midland City, Mrs. Murray Dease, Dothan route, Miss Ruth Woodham, Mrs. T. C. Bennett, Marianna, Mrs. A. B. Clark, Newton, Misses Corrie, Canora and Sharon Woodham, Midland City; two sons, P. O. Woodham, Jr., and Michael Woodham of Midland City.

The funeral will be held at Sylvan

Burial will be in the church cemetery, Holman Funeral Home directing.

Witness

Lot No.
 Grave No.
 Section No.
 Block No.
 Owner

Amount Paid	Balance	Date	Amount Paid	Balance
	\$		To Balance Forward	\$
\$	\$		By Payment	\$
\$	\$		" "	\$
\$	\$		" "	\$
\$	\$		" "	\$
\$	\$		" "	\$
\$	\$		" "	\$
\$	\$		" "	\$
\$	\$		" "	\$

Names of Insurance Companies and Lodges

and I hereby represent that I have sufficient resources Legally available to

(Firm Name of Funeral Director)

Signed

Address

No. 90

RECORD OF FUNERAL

Total No. 13 Yearly No. 159 Date of Entry Oct. 31 1926

Name of Deceased Pryor Jennie Woodham CAH.
 Married Single Widowed Divorced (What Race)

Residence Rt. 3 Ozark, Al. Husband Wife Widow } or of } Age of Husband or Wife (If living).....Years

Charge to Jessie Baker

Address P.O. Box 246 Oppewick, Al.

Order given by (or informant)

How Secured

If Veteran, Name of War

Occupation Retired 420-14-1051
(Social Security Number)

Employer and Address

Date of Birth Jan. 19, 1902 Age 24
(Mo.) (Day) (Yr.) (Yrs.) (Mos.) (Days)

Birthplace Dale County, Al.

Date of Death Oct. 31 Sun. 1926
(Mo.) (Day) (Yr.) (Hour)

Place of Death Home

Name of Father Gillum D. Woodham

His Birthplace

Maiden Name of Mother Arnie L. Peacock

Her Birthplace

Date of Funeral Nov. 2 (Tues.) 2:00 P.M.
(Date) (Day of Week) (Hour)

Services at Mt. Carmel United Meth.

Clergyman Rev. James Harbert
(Address)

Religion of the Deceased

Resided in the State (or U.S. or City or County) (Years) (Months)

Cause of Death

Contributory Causes

Certifying Physician N.W. Holman, M.D.
(or Coroner)

His Address

Truck } Remains to
Ship }

Size of Casket P 1/2 (State Color and Number)

Manufactured by Covington

Cemetery } Mt. Carmel
Crematory }

Lot No.

Grave No.

Section No.

Block No.

Owner

Misc.

Complete Funeral (except outlays)	\$	
Casket		
Burial Vault or Box		
Embalming Body	(State Kind)	
Misc.	(Name of Embalmer)	
Dressing Body, \$	Underwear	
Suit or Dress	(State Kind and Color)	
Slippers, \$	Hose, \$	
Folding Chairs, \$	Tarpaulin, \$	
Candelabrum, \$	Candles, \$	
Door Spray, \$	Gloves, \$	
Funeral Car, \$	Ambulance, @ \$	
Limousines to Cemetery	@ \$	
Extra Limousines	@ \$	
Flower Car	@ \$	
Autos to R.R. or Air	@ \$	
Getting Remains from		
Taking Remains to		
Trip to Coroner's Inquest		
Misc.		
Removal Charges		
Procuring Burial Permit	(State Number or State Physician's or Use of Chape)	
..... Certif. Copies of Death Certificates		
Pall Bearer Service, \$		
Gross Total for Sales Tax		
Outlay for Lot		
Cremation		
Flowers, \$	Palms, \$	Matting, \$
Rental of Tent, \$	of Temporary Vault	
Opening of Grave or Tomb		
Lining Grave, \$	Lowering Device,	
Outlay for Shipping Charges		
Clergymen, \$	Singers, \$	Organs,
Railroad } Tickets, \$	Air Service, \$	
or Truck }		
Telegr., Phone, Cable or Radio Charges		
Cash Advanced		
Out of town Funeral Director's Charges		
Personal Service		
..... line Death Notices in	Papers	
(Names of Newspapers)		
Sales Tax		
Totaling Footing of Bill	\$	
Less	\$	
Balance	\$	
Entered into Ledger, page	or below.	



Diagram of Lot or Vault

Misc. average OKR 11/11

RECORD OF FUNERAL

Total No. 176 Yearly No. 113 Date 11/16/31 1931

Name of Deceased Miss M. G. Woodhox White Dale Co.
(What Race) (Where Born)

Husband—
Wife—Widow
Son—Daughter of } M. G. Woodhox

Charge to Severus D. O.
Address Alexandria

Order Given by M. S. Pomeroy

How Secured See

Date of Funeral 11/17/31

Residence York St 4

Place of Death Home

Funeral Services at Home

Time of Funeral Service 10:00 A.M.

Clergyman Ethridge

His Address York

Certifying Physician Prof. Reynolds

His Residence York

Cause of Death Unobscured Hernia
(Primary) Strangulated

Cause of Death (Secondary)

Date of Death 11/16/31 - 12:50 p.m.

Occupation of the Deceased Housewife

Employed

Single or Married Widow Religion

Date of Birth

Age 67 Years Months Days

Name of Father H. C. Daugherty

His Birthplace M.C.

Name of Mother Nellie Woodhox
(Maiden Name)

Her Birthplace Dale Co Ala

Body to be Shipped to

Size and Style of Casket 4/3 XXXXX Steel 4x7 1/2

Manufactured by Burston P. Co.

Interment at City Cen - York Cemetery

Casket	25.00
Metallic Lining	
Outside Box (State Kind)	
Grave Vault (State Kind)	
Suit or Dress, \$3.50 Hose, \$1.00 Slippers, \$	36.00
Embalming Body (with Fluid)	
Dressing Body, \$ Hair Dressing, \$	
Folding Chairs	
Candelabrum, \$ Candles, \$	
Door Badge, \$ Gloves, \$	
Hearse	50.00
Auto Limousines to Cemetery @ \$	
Autos to R. R. Station @ \$	
Aeroplane Service	
Getting Remains from	
Taking Body to Inquest	
Delivering Box to	
Delivering Remains to	
Death Notices in Newspapers	
(Names of Newspapers)	
Flowers	
Rental of Plants, \$ Tent Rental, \$	
Outlay for Lot	
Opening Grave Vault, \$	
Lining Grave, \$ Matting, \$	
Lowering Device, \$ Rental of Vault	
Outlay for Shipping Charges	
Removal Charges, \$ Incineration, \$	
Getting Burial Permit	
Certified Copies of Death Certificate	
Personal Charges, \$ Singers, \$	
Church Charges, \$ Ministers, \$	
Pall Bearer Service	
Telegr., Telephone, Cable or Radio Charges	
Railroad Tickets	
Cash Advanced	

Severus D. O.
Alexandria

Total Footing of Bill \$ 336.00

By (Amount Paid in Advance) \$

Balance \$



Diagram of Lot or Vault

Lot No.
Grave No.
Section No.

To Funeral Charges... Total, \$		By Cash	\$
---------------------------------	--	---------	----

TULLIS DOZIER WOODHAM

RECORD OF FUNERAL

No. 1552 Yearly No. 2 Date Jan 8 1940
 of Deceased S. D. Woodham (Single Married Divorced
 Race of Deceased W (What Race) (Where Born) Wash DC
 Name of Deceased Szark, Alan Husband—Wife—Widow—
 to

Secured by
 (or informant)
 Name of Deceased
 Name of Employer
 Date of Death Jan. 6, 1940 3:00 P.M.
 (Date) (Hour)
 Age of Birth 39 50 9 22
 (Years) (Months) (Days)
 Date of Funeral 1-9-40 Tue. 2:00 P.M.
 (Date) (Day of Week) (Hour)
 Place at Methodist Church
 Undertaker Bickerstaff
 Address Szark,
 Name of the Deceased
 State in which he died
 (U. S., City or County) (Years) (Months)
 Cause of Death at home
 Cause of Death

Contributory Causes
 Attending Physician Dr. A. D. Matthews
 (or Coroner)
 Address Szark, Alan
 Name of Father S. D. Woodham
 Birthplace Wash DC
 Maiden Name of Mother Wendell McSpain
 Birthplace Wash DC
 Where Remains to
 Name and Style of Casket
 (State Color)
 Manufactured by
 Place of Burial City Cemetery { Cemetery
 Crematory

Diagram of Lot or Vault
 Lot No.
 Grave No.
 Section No.
 Owner

Complete Funeral	\$	
Casket <u>Wagon</u>	150.00	
Outside Box	50.00	
Burial Vault	(State Kind)	
Embalming Body	(State Kind)	
Lady Attendant	(Name of Embalmer)	
Barber, \$	Hair Dressing, \$	
Dressing Body, \$	Underwear, \$	
Suit or Dress \$	Slippers \$	Hose \$
Folding Chairs, \$	Tarpaulin, \$	
Candelabrum, \$	Candles, \$	
Door Spray, \$	Gloves, \$	
Funeral Car, \$	Ambulance, \$	
Limousines to Cemetery	@ \$	
Autos to R. R. Station	@ \$	
Getting Remains from		
Taking Remains to		
Trip to Coroner's Inquest		
Delivering Box to		
Deliver Flowers to		
Removal Charges		
Procuring Burial Permit	(State Number and District)	
___ Certif. Copies of Death Certificates No.	(State Physician's or Coroner's)	
Pall Bearer Service, \$	Use of Chapel, \$	
Personal Service		
Gross Total for Sales Tax	\$	
Outlay for Lot		
Cremation		
..... line Death Notices in Papers		
Flowers, \$	(Names of Newspapers)	Palms, \$
Rental of Tent, \$	of Temporary Vault, \$	
Opening of Grave or Tomb		
Lining Grave, \$	Lowering Device, \$	
Outlay for Shipping Charges		
Clergyman, \$	Singers, \$	Organist, \$
Railroad or Motor } Tickets, \$	Aero-plane Service, \$	
Telegr., Phone, Cable or Radio Charges		
Cash Advanced		
Out of town Undertaker's Charges		
Sales Tax		
Total Footing of Bill	\$	
Less	\$	
Balance	\$	
Entered into Ledger, page or below,		

Date	Amount Paid	Balance	Date	Amount Paid	Balance

TULLIS DOZIER WOODHAM

RECORD OF FUNERAL

Total No. 1552 Yearly No. 2 Date Jan 8 1940

Name of Deceased H. D. Woodham (Single Married Divorced (What Race) W (Where Born) Wash DC

Residence of Deceased Ozark, Ala Husband—Wife—Widow—
or of

Charge to
Address

Order given by
(or informant)

How Secured

Occupation of Deceased

Name of Employer

Address

Date of Death Jan. 6 1940 3:00 P.M.
(Date) (Hour)

Date of Birth Jan. 16 1889
Age 50 9 22
(Years) (Months) (Days)

Date of Funeral Jan 9 1940 2:00 P.M.
(Date) (Day of Week) (Hour)

Services at Methodist Church

Clergyman Bickerstaff

His Address Ozark,

Religion of the Deceased

Resided in the State
(or U. S. City or County) (Years) (Months)

Place of Death at home

Cause of Death

Contributory Causes

Certifying Physician Dr. A. D. Matthews
(or Coroner)

His Address Ozark, Ala

Name of Father J. W. Woodham

His Birthplace Wash DC

Maiden Name of Mother Nellie McSpain

Her Birthplace Wash DC

Motor } Remains to
Ship }

Size and Style of Casket
(State Color)

Manufactured by

Interment at City Cemetery { Cemetery
Crematory

Lot No.
Grave No.
Section No.
Owner

Diagram of Lot or Vault

Complete Funeral	\$	
Casket <u>Wigman</u>		150.00
Outside Box	(State Kind)	
Burial Vault	(State Kind)	50.00
Embalming Body	(Name of Embalmer)	
Lady Attendant		
Barber, \$	Hair Dressing, \$	
Dressing Body, \$	Underwear, \$	
Suit or Dress \$	Slippers \$	Hose \$
Folding Chairs, \$	Tarpaulin, \$	
Candelabrum, \$	Candles, \$	
Door Spray, \$	Gloves, \$	
Funeral Car, \$	Ambulance, \$	
Limousines to Cemetery @ \$		
Autos to R. R. Station @ \$		
Getting Remains from		
Taking Remains to		
Trip to Coroner's Inquest		
Delivering Box to		
Deliver Flowers to		
Removal Charges		
Procuring Burial Permit	(State Number and District)	
Certif. Copies of Death Certificates No.	(State Physician's or Coroner's)	
Pall Bearer Service, \$	Use of Chapel, \$	
Personal Service		
Gross Total for Sales Tax	\$	
Outlay for Lot		
Cremation		
line Death Notices in	Papers	
Flowers, \$	Palms, \$	Matting, \$
Rental of Tent, \$	of Temporary Vault, \$	
Opening of Grave or Tomb		
Lining Grave, \$	Lowering Device, \$	
Outlay for Shipping Charges		
Clergyman, \$	Singers, \$	Organist, \$
Railroad } Tickets, \$	Aero- plane Service, \$	
or Motor }		
Telegr., Phone, Cable or Radio Charges		
Cash Advanced		
Out of town Undertaker's Charges		
Sales Tax		
Total Footing of Bill	\$	
Less	\$	
Balance	\$	
Entered into Ledger, page		or below.

Date	Amount Paid	Balance	*Date	Amount Paid	P
		\$		To Balance Forward	\$

RECORD OF FUNERAL

Total No. 1587 Yearly No. 35 Date Feb. 29

Name of Deceased Marie M. Woodburn (Single Married Divorced
 Residence of Deceased Garb Pt 4 Box 4 Husband—Wife—Widow— }
 or Shelley of }

Charge to _____
 Address _____
 Order given by _____ (or informant)
 How Secured _____
 Occupation of Deceased Housewife
 Name of Employer _____
 Address _____
 Date of Death Feb. 29-40 (Date) (Hour)
 Date of Birth Nov. 1 (Date) (Hour)
 Age 43 (Years) (Months) (Days)
 Date of Funeral March 2 (Date) (Day of Week) (Hour) M.
 Services at Ewell
 Clergyman _____
 His Address _____
 Religion of the Deceased _____
 Resided in the State _____ (or U. S. or City or County) (Years) (Months)
 Place of Death at home
 Cause of Death _____
 Contributory Causes _____
 Certifying Physician Dr. M. W. Helman (or Coroner)
 His Address Garb Ala.
 Name of Father V. O. Moore
 His Birthplace Wale
 Maiden Name of Mother Mittie Hill
 Her Birthplace Wale
 Motor } Remains to _____
 Ship }
 Size and Style of Casket _____ (State Color)
 Manufactured by _____
 Interment at Ewell { Cemetery
 Crematory

Diagram of Lot or Vault

Lot No. _____
 Grave No. _____
 Section No. _____
 Owner _____

Complete Funeral	\$
Casket	100
Outside Box	(State Kind)
Burial Vault	(State Kind)
Embalming Body	(Name of Embalmer) 25
Lady Attendant	
Barber, \$	Hair Dressing, \$
Dressing Body, \$	Underwear, \$
Suit or Dress \$	Slippers \$ Hose \$
Folding Chairs, \$	Tarpaulin, \$
Candelabrum, \$	Candles, \$
Door Spray, \$	Gloves, \$
Funeral Car, \$	Ambulance, \$
Limousines to Cemetery	@ \$
Autos to R. R. Station	@ \$
Getting Remains from	
Taking Remains to	
Trip to Coroner's Inquest	
Delivering Box to	
Deliver Flowers to	
Removal Charges	
Procuring Burial Permit	
_____ Certif. Copies of Death Certificates No. _____	
_____ (State Physician's or Coroner's)	
Pall Bearer Service, \$	Use of Chapel, \$
Personal Service	
Gross Total for Sales Tax	\$
Outlay for Lot	
Cremation	
_____ line Death Notices in _____ Papers	
_____ (Names of Newspapers)	
Flowers, \$	Palms, \$ Matting, \$
Rental of Tent, \$	of Temporary Vault, \$
Opening of Grave or Tomb	
Lining Grave, \$	Lowering-Device, \$
Outlay for Shipping Charges	
Clergyman, \$	Singers, \$ Organist, \$
Railroad } Tickets, \$	Aero- plane Service, \$
or Motor }	
Telegr., Phone, Cable or Radio Charges	
Cash Advanced	
Out of town Undertaker's Charges	
Sales Tax	2
Total Footing of Bill	\$
Less	\$
Balance	\$
Entered into Ledger, page _____ or below.	

Date	Amount Paid	Balance	Date	Amount Paid	Bala

RECORD OF FUNERAL

Total No. 1143 Yearly No. 91 Date July 9 194

Name of Deceased Mrs Media H. Woodham
(Single — Married — Divorced) (What Race) (Where Born)

Residence of Deceased Ozark Rd 2 Husband—Wife—Widow—
(or informant) of

Charge to
 Address

Order given by
(or informant)

How Secured

Occupation of Deceased

Name of Employer

Address

Date of Death 9
(Date) (Hour)

Date of Birth March 5

Age 77
(Years) (Months) (Days)

Date of Funeral July 10 4 P M.
(Date) (Day of Week) (Hour)

Services at

Clergyman Jack Marshall

His Address W. Clark Ahala

Complete Funeral	\$
Casket	
Outside Box	<small>(State Kind)</small>
Burial Vault	<small>(State Kind)</small>
Embalming Body	<small>(Name of Embalmer)</small>
Lady Attendant	
Barber, \$	Hair Dressing, \$
Dressing Body, \$	Underwear, \$
Suit or Dress \$	Slippers \$
	Hose \$
	<small>(State Color)</small>
Folding Chairs, \$	Tarpaulin, \$
Candelabrum, \$	Candles, \$
Door Spray, \$	Gloves, \$
Funeral Car, \$	Ambulance, \$
Limousines to Cemetery	@ \$
Autos to R. R. Station	@ \$
Getting Remains from	
Taking Remains to	
Trip to Coroner's Inquest	
Delivering Box to	

Funeral Service

Age
 Date of Funeral *July 10 4 P M*
 Services at
 Clergyman *Jack Marshall*
 His Address *W.*

Religion of the Deceased
 Resided in the State
 Place of Death
 Cause of Death
 Contributory Causes

Certifying Physician *Dr. W. A.*
 His Address
 Name of Father *J. O.*
 His Birthplace

Maiden Name of Mother
 Her Birthplace
 Motor } Remains to
 Ship }
 Size and Style of Casket
 (State Color)

Manufactured by *C*
 Interment at *Chalk Hill* { Cemetery
 Crematory

9.
alex
Henry
Carl
 Lot No. *03*
 Grave No. *woodham*
 Section No.
 Owner

Funeral Car, \$
 Ambulance, \$
 Limousines to Cemetery
 Autos to R. R. Station
 Getting Remains from
 Taking Remains to
 Trip to Coroner's Inquest
 Delivering Box to
 Deliver Flowers to
 Removal Charges
 Procuring Burial Permit
 (State Number and District)
 Certif. Copies of Death Certificates No.
 (State Physician's or Coroner's)
 Pall Bearer Service, \$
 Use of Chapel, \$
 Personal Service

Gross Total for Sales Tax
 Outlay for Lot
 Cremation
 . . . line Death Notices in Papers

(Names of Newspapers)
 Flowers, \$ Palms, \$ Matting, \$
 Rental of Tent, \$ of Temporary Vault, \$
 Opening of Grave or Tomb
 Lining Grave, \$ Lowering Device, \$
 Outlay for Shipping Charges
 Clergyman, \$ Singers, \$ Organist, \$
 Railroad } Tickets, \$ Aero-
 or Motor } plane Service, \$
 Telegr., Phone, Cable or Radio Charges
 Cash Advanced
 Out of town Undertaker's Charges

Sales Tax
 Total Footing of Bill
 Less
 Balance
 Entered into Ledger, page or below.

Date	Names of Lodges	Amount Paid	Balance	Date	Insurance Companies	Amount Paid	Balance
	To Above Balance		\$		To Balance Forward		\$
	By Payment	\$	\$		By Payment	\$	\$
	"	\$	\$		"	\$	\$
	"	\$	\$		"	\$	\$
	"	\$	\$		"	\$	\$
	"	\$	\$		"	\$	\$
	"	\$	\$		"	\$	\$
	"	\$	\$		"	\$	\$
	"	\$	\$		"	\$	\$

Insurance \$
 Names of Lodges
 Insurance Companies

I hereby authorize the above Funeral, and I hereby represent that I have sufficient resources Legally available to
 (Firm Name of Funeral Directors.)
 for the payment of aforesaid sum, and I hereby covenant and agree to pay the same within days from date. Interest to accrue from
 maturity at the rate of % per annum.

Signed
 Address

RECORD OF FUNERAL

Total No. 1143 Yearly No. 91 Date July 9 ~~1941~~ ¹⁹⁴² 1942
 Name of Deceased Mrs. Media H. Woodham (Single — Married — Divorced) (What Race) (Where Born)

Residence of Deceased Ozark, Ark Husband—Wife—Widow— }
 or of }

Charge to
 Address
 Order given by (or informant)

How Secured
 Occupation of Deceased

Name of Employer
 Address

Date of Death July 4
 Date of Birth March 5
 Age 77 (Month) (Year)

Date of Funeral July 10 4:00 M
 (Date) (Day of Week) (Hour)

Deceased at
 Clergyman W. Marshall
 His Address W. Marshall

Religion of the Deceased
 Resided in the State (in City or County) (Years) (Months)

Place of Death
 Cause of Death

Contributory Causes
 Certifying Physician Dr. W. Marshall (in Case of)

His Address
 Name of Father J. O. Woodham
 His Birthplace

Maiden Name of Mother
 Her Birthplace

Motor } Remains to
 Ship }
 Size and Style of Casket (State Color)

Manufactured by
 Interment at Chalk Head { Cemetery
 Crematory

9. Maud, Alvin Lot No. 03
alex 13/Hermon Woodham
Henry Grave No.
Carl Section No.
 Owner

Lillian Powers
Lola Andrews
Mollie Maud

Complete Funeral	\$
Casket	
Outside Box	(State Kind)
Burial Vault	(State Kind)
Embalming Body	(Name of Embalmer)
Lady Attendant	
Barber, \$	Hair Dressing, \$
Pressing, \$	Underwear, \$
Shoes, \$	Hosiery, \$
Collar, \$	Buttons, \$
Bedding, \$	Carpeting, \$
Candelabra, \$	Candles, \$
Floor Spray, \$	Gloves, \$
Funeral Car, \$	Ambulance, \$
Lanterns to Cemetery	60 \$
Auton to R. R. Station	60 \$
Getting Remains from	
Taking Remains to	
Trip to Coroner's Impound	
Delivery Box to	
Delivery Flowers to	
Removal Charges	
Procuring Burial Permit	
Certified Copy of Death Certificate	
Call to Burial Service, \$	Use of Chapel, \$
Personal Expenses	
Graves Total for Sales Tax	
Outlay for Lot	
Cremation	
Use Death Certificate	
Paper	
Flowers, \$	Palms, \$
Matting, \$	
Rental of Tent, \$	of Temporary Vault, \$
Opening of Grave or Tomb	
Lining Grave, \$	Lowering Device, \$
Outlay for Shipping Charges	
Clergyman, \$	Singers, \$
Organist, \$	
Railroad } Tickets, \$	Aero- plane Service, \$
or Motor }	
Telegr., Phone, Cable or Radio Charges	
Cash Advanced	
Out of town Undertaker's Charges	
Sales Tax	
Total Footing of Bill	\$
Less	\$
Balance	\$
Entered into Ledger, page or below.	

	Amount Paid	Balance	Date	Amount Paid	Balance
To Above Balance		\$		To Balance Forward	\$
Payment	\$	\$		By Payment	\$
"	\$	\$		"	\$
"	\$	\$		"	\$
"	\$	\$		"	\$
"	\$	\$		"	\$

RECORD OF FUNERAL

Total No. _____ Yearly No. 133 Date of Entry Sept 8 Wed 1965
 Name of Deceased Mary Claudia Woodham W
 Married Single Widowed Divorced (What Race)

Residence Elpis St, Ozark, Ala. Husband Wife Widow }
 or _____ of } Age of Husband or Wife (if living) _____ Years

Charge to Mary Clemey
 Address Ozark,
 Order given by Mary Clemey
 How Secured _____
 If Veteran, Name of War _____

Occupation Housewife 417-10-9977
 (Social Security Number)
 Employer and Address _____

Date of Death Sept 8 Wed 1965
 (Mo.) (Day) (Yr.) (Hour)

Date of Birth Aug 20 1884 Age 81
 (Mo.) (Day) (Yr.) (Mts.) (Days)

Name of Father John Everett
 His Birthplace _____

Maiden Name of Mother Scimmie Windham
 Her Birthplace _____

Date of Funeral Sept 9 Thurs 3:30 P.M.
 (Date) (Day of Week) (Hour)

Services at Holman Chapel
 Clergyman Mitchell Ford
 (Address)

Religion of the Deceased Methodist
 Birthplace Ala.

Resided in the State Ozark
 (or U.S. or City or County) (Years) (Months)

Place of Death Ozark - State Hosp.
 Cause of Death _____

Contributory Causes _____

Certifying Physician D.R. Smith
 (or Coroner)

His Address Ozark, Ala.

Motor Ship } Remains to _____
 Size of Casket Calhoun Std
 (State Color and Number)

Manufactured by _____
 Cemetery } Westview
 Crematory }

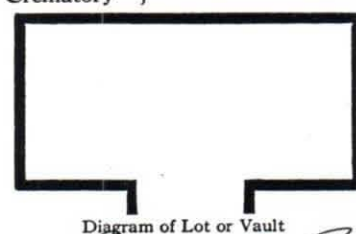
Diagram of Lot or Vault 

Lot No. _____
 Grave No. _____
 Section No. _____
 Block No. _____
 Owner _____

Misc. Augusta Beaves
9-16-65

Complete Funeral (except outlays)	\$	
Casket		
Burial Vault or Box		
Embalming Body <u>(State Kind) V.P.H.D.</u>		
Barber, \$ _____ Hair Dressing, \$ _____		
Dressing Body, \$ _____ Underwear, \$ _____		
Suit or Dress		
Slippers, \$ _____ Hose, \$ _____		
Folding Chairs, \$ _____ Tarpaulin, \$ _____		
Candelabrum, \$ _____ Candles, \$ _____		
Door Spray, \$ _____ Gloves, \$ _____		
Funeral Car, \$ _____ Ambulance, \$ _____		
Limousines to Cemetery @ \$ _____		
Extra Limousines @ \$ _____		
Autos to R. R. Station @ \$ _____		
Getting Remains from _____		
Taking Remains to _____		
Trip to Coroner's Inquest _____		
Delivering Box to _____		
Deliver Flowers to _____		
Removal Charges _____		
Procuring Burial Permit _____		
_____ Certif. Copies of Death Certificates No. _____		
_____ (State Physician's or Coroner's)		
Pall Bearer Service, \$ _____ Use of Chapel, \$ _____		
Gross Total for Sales Tax _____	\$	
Outlay for Lot _____		
Cremation _____		
Flowers, \$ _____ Palms, \$ _____ Matting, \$ _____		
Rental of Tent, \$ _____ of Temporary Vault, \$ _____		
Opening of Grave or Tomb _____		
Lining Grave, \$ _____ Lowering Device, \$ _____		
Outlay for Shipping Charges _____		
Clergymen, \$ _____ Singers, \$ _____ Organist, \$ _____		
Railroad { Tickets, \$ _____ Aero-plane Service, \$ _____		
or Motor { _____		
Telegr., Phone, Cable or Radio Charges _____		
Cash Advanced _____		
Out of town Funeral Director's Charges _____		
Personal Service _____		
_____ line Death Notices in _____ Papers _____		
(Names of Newspapers)		
Sales Tax _____		
Total Footing of Bill _____	\$	
Less _____	\$	
Balance _____	\$	
Entered into Ledger, page _____ or below.		
Misc. _____		

7-11-65

RECORD OF FUNERAL

Total No. _____ Yearly No. 180 Date of Entry 24 Nov. 1964
 Name of Deceased Daisy Y Woodham
 Married Single Widowed Divorced (What Status)
 Husband Wife Widow }
 or _____ of } Age of Husband or Wife (if living)

Residence Rt 3 Ozark, Ala.
 Charge to Mrs. Arvise Outlaw
 Address Rt. 3 - Ozark, Ala.
 Order given by Mrs. Arvise Outlaw
 How Secured _____
 If Veteran, Name of War _____
 Occupation Housewife (Social Security Number) _____
 Employer and Address _____

Date of Death Nov 24, 1964 - 11:05 AM
 Date of Birth Jul 24, 1882 Age 82
 Name of Father John Thompson
 His Birthplace _____
 Maiden Name of Mother Callie Belle Shaw
 Her Birthplace _____

Date of Funeral Nov 26 Thurs 10:30 AM
 Services at Chalk Head Baptist
 Clergyman Snellgrove & Ernest
 Religion of the Deceased Baptist
 Birthplace Pike Co., Ala.
 Resided in the State Ala. Co. 82
 Place of Death Home
 Cause of Death _____
 Contributory Causes _____

Certifying Physician N.W. Hoffman
 His Address Ozark, Ala.
 Motor Ship } Remains to _____
 Size of Casket Blue & white Enamel
 Manufactured by Georgia
 Cemetery } Chalk Head
 Crematory }

Lot No. _____
 Grave No. _____
 Section No. _____
 Block No. _____
 Owner _____

Misc. Filed - 12-17-64

Complete Funeral (except outlays) \$ _____
 Casket _____
 Burial Vault or Box _____
 Embalming Body HD & VTB
 Barber, \$ _____ Hair Dressing, \$ _____
 Dressing Body, \$ _____ Underwear, \$ _____
 Suit or Dress _____
 Slippers, \$ _____ Hose, \$ _____
 Folding Chairs, \$ _____ Tarpaulin, \$ ~~7.00~~
 Candelabrum, \$ _____ Candles, \$ _____
 Door Spray, \$ _____ Gloves, \$ _____
 Funeral Car, \$ _____ Ambulance, \$ _____
 Limousines to Cemetery @ \$ _____
 Extra Limousines @ \$ _____
 Autos to R. R. Station @ \$ _____
 Getting Remains from _____
 Taking Remains to _____
 Trip to Coroner's Inquest _____
 Delivering Box to _____
 Deliver Flowers to _____
 Removal Charges _____
 Procuring Burial Permit _____
 Certif. Copies of Death Certificates No. _____
 Pall Bearer Service, \$ _____ Use of Chapel, \$ _____
 Gross Total for Sales Tax \$ _____
 Outlay for Lot _____
 Cremation _____
 Flowers, \$ _____ Palms, \$ _____ Matting, \$ _____
 Rental of Tent, \$ _____ of Temporary Vault, \$ _____
 Opening of Grave or Tomb _____
 Lining Grave, \$ _____ Lowering Device, \$ _____
 Outlay for Shipping Charges _____
 Clergymen, \$ _____ Singers, \$ _____ Organist, \$ _____
 Railroad or Motor { Tickets, \$ _____ Aero-plane Service, \$ _____
 Telegr., Phone, Cable or Radio Charges _____
 Cash Advanced _____
 Out of town Funeral Director's Charges _____
 Personal Service _____
 _____ line Death Notices in _____ Papers
 (Names of Newspapers) _____
 Sales Tax _____
 Total Footing of Bill \$ _____
 Less \$ _____
 Balance \$ _____
 Entered into Ledger, page _____ or below.

11-25-64



Diagram of Lot or Vault

RECORD OF FUNERAL

No. 945 Yearly No. 79 Date May 24th 1926
 of Deceased Walter L Woodham white Dal. Ga.
(Single — Married — Divorced) (What Race) (Where Born)
 ce of Deceased Midland City AT Husband—Wife—Widow—Lillian
 to From services or..... of

iven by.....
(or informant)
 ured.....
 ion of Deceased Farmer
 f Employer.....
 Death..... 2:00 PM
(Date) (Hour)
 Birth.....
60.....
(Years) (Months) (Days)
 Funeral..... M.
(Date) (Day of Week) (Hour)
 s at.....
 nan.....
 dress.....
 n of the Deceased.....
 l in the State.....
(or U. S. or City or County) (Years) (Months)
 f Death at home
 of Death.....
 utory Causes.....
 ing Physician Dr. Parrish
(or Coroner)
 dress.....
 of Father Daniel Woodham
 rthplace ala
 n Name of Mother Martha Ingler
 irthplace ala
 Remains to wife
 id Style of Casket Warm Springs Casket
(State Color)
 actured by.....
 ent at Corrent { Cemetery
 Crematory
 Lot No.....
 Grave No.....
 Section No.....
 Owner.....

Complete Funeral.....	\$	
Casket.....		
Metallic Lining.....		
<small>(State Kind)</small>		
Outside Box.....		
<small>(State Kind)</small>		
Burial Vault.....		
<small>(State Kind)</small>		
Embalming Body.....		Fluid
with.....		
Barber, \$.....		Hair Dressing, \$.....
Dressing Body.....		
Suit or Dress, \$.....		Hose, \$.....
<small>(State Color)</small>		
Underwear, \$.....		Slippers, \$.....
Folding Chairs, \$.....		Tarpaulin, \$.....
Candelabrum, \$.....		Candles, \$.....
Door Badge, \$.....		Gloves, \$.....
Hearse, \$.....		Ambulance, \$.....
Limousines to Cemetery.....	@ \$	
Autos to R. R. Station.....	@ \$	
Getting Remains from.....		
Taking Remains to.....		
Delivering Box to.....		
Flowers to.....		
Removal Charges.....		
Procuring Burial Permit.....		
<small>(State Number and District)</small>		
Certif. Copies of Death Certificates No.....		
<small>(State Physician's or Coroner's)</small>		
Pall Bearer Service.....		
Personal Service.....		
Use of Chapel.....		
Outlay for Lot.....		
Death Notices in.....		Newspapers.....
<small>(Names of Newspapers)</small>		
Flowers, \$.....		Rental of Palms, \$.....
Rental of Tent, \$.....		of Temporary Tomb, \$.....
Lowering Device, \$.....		Cremation, \$.....
Opening of Grave or Tomb.....		
Lining Grave, \$.....		Matting, \$.....
Outlay for Shipping Charges.....		
Clergyman, \$.....		Singers, \$.....
Organist, \$.....		
Railroad } Tickets, \$.....		Aero-
or Motor } <small>plane</small> Service, \$.....		
Telegr., Phone, Cable or Radio Charges.....		
Cash Advanced.....		
Out of town Undertaker's Charges.....		
Total Footing of Bill.....	\$	
Less.....	\$	
Balance.....	\$	
Entered into Ledger, page.....		or below.....

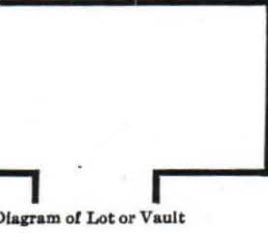

Rv Cash.....\$

RECORD OF FUNERAL

Total No. Yearly No. 139 Date of Entry Oct 21, (Mon) 1957
 Name of Deceased Webster A. Woodham White
 Married Single Widowed Divorced (What Race)
 Residence: Midland City, Rt. 1 Husband Wife Widow }
 or of } Age of Husband or Wife (if living)

Charge to:
 Address:
 Order given by Mrs. Webster Woodham
 (or informant)
 How Secured:
 If Veteran, Name of War:
 Occupation Farmer 421-48-0437
 (Social Security Number)
 Employer and Address:
 Date of Death Oct 21 - Mon 1957
 (Mo.) (Day) (Yr.) (Hour)
 Date of Birth June 2, 1886 Age 71
 (Mo.) (Day) (Yr.) (Mos.) (Days)
 Services at Echo Methodist Church
 Clergyman Roy Thomas - C. D. York
 (Address)
 Religion of the Deceased Methodist
 Birthplace Dale Co. Alabama
 Resided in the State Dale Co 71
 (or U. S. or City or County) (Years) (Months)
 Place of Death Dale Co. Hospital
 Cause of Death:

Contributory Causes:
 Certifying Physician N. W. Halmon
 (or Coroner)
 His Address: Ozark
 Name of Father Woodham Woodham
 His Birthplace:
 Maiden Name of Mother Liza Deal
 Her Birthplace:
 Date of Funeral Oct 23 Wed 2 P. M.
 (Date) (Day of Week) (Hour)
 Motor } Remains to
 Ship }
 Size of Casket Calvin Sealer
 (State Color and Number)
 Manufactured by:

Cemetery } Echo
 Crematory }
 Lot No.
 Grave No.
 Section No.
 Block No.
 Owner:
 Diagram of Lot or Vault
 Miscellaneous: 11-4-57

Complete Funeral (except outlays)	\$
Casket	
Burial Vault or Box	
Embalming Body <u>J. A. A.</u> (State Embalmer) (Name of Embalmer)	
Barber, \$..... Hair Dressing, \$.....	
Dressing Body, \$..... Underwear, \$.....	
Suit or Dress	
(State Kind and Color)	
Slippers, \$..... Hose, \$.....	
Folding Chairs, \$..... Tarpaulin, \$.....	
Candelabrum, \$..... Candles, \$.....	
Door Spray, \$..... Gloves, \$.....	
Funeral Car, \$..... Ambulance, \$.....	
Limousines to Cemetery @ \$.....	
Extra Limousines @ \$.....	
Autos to R. R. Station @ \$.....	
Getting Remains from	
Taking Remains to	
Trip to Coroner's Inquest	
Delivering Box to	
Deliver Flowers to	
Removal Charges	
Procuring Burial Permit	
____ Certif. Copies of Death Certificates No. (State Number and District) (State Physician's or Coroner's)	
Pall Bearer Service, \$..... Use of Chapel, \$.....	
Gross Total for Sales Tax	\$
Outlay for Lot	
Cremation	
Flowers, \$..... Palms, \$..... Matting, \$.....	
Rental of Tent, \$..... of Temporary Vault, \$.....	
Opening of Grave or Tomb	
Lining Grave, \$..... Lowering Device, \$.....	
Outlay for Shipping Charges	
Clergyman, \$..... Singers, \$..... Organist, \$.....	
Railroad } Tickets, \$..... Aero- or Motor } plane Service, \$.....	
Telegr., Phone, Cable or Radio Charges	
Cash Advanced	
Out of town Funeral Director's Charges	
Personal Service	
..... line Death Notices in Papers	
(Names of Newspapers)	
Sales Tax	
Total Footing of Bill	\$
Less	\$
Balance	\$
Entered into Ledger, page..... or below.	
Miscellaneous	

MONTH
 Total No. Yearly No. 104 Date of Entry Mon Aug 6
 Name of Deceased Wesley Alvie Woodham (ALVER) (What Race) W
 Married Single Widowed Divorced
 Husband Wife Widow }
 Residence Newton Rebecca Lane or _____ of _____ Age of Husband or Wife (If living) _____
 Charge to Mrs. Oona P. Woodham
 Address Newton, Ala.
 Order given by Mrs. Oona P. Woodham (or informant)
 How Secured _____
 If Veteran, Name of War _____
 Occupation Farmer (Social Security Number) _____
 Employer and Address _____
 Date of Birth July 27th 1898 Age 76
 (Mos.) (Day) (Yr.) (Mos.) (Days)
 Birthplace Dale County, Alabama
 Date of Death Aug 6 1973
 (Mo.) (Day) (Yr.) (Hour)
 Place of Death Southwest General Hospital, Dothan
 Name of Father John Wesley Woodham
 His Birthplace _____
 Maiden Name of Mother Mear Hobbs
 Her Birthplace _____
 Date of Funeral Aug 7 Tue 4:00 P.M.
 (Date) (Day of Week) (Hour)
 Services at Chalkhead Baptist
 Clergyman Wm. Snellgrove, Fred Williams, Wiley Sherfield
 Religion of the Deceased Baptist
 Resided in the State Dale Co. 76
 (or U.S. or City or County) (Years) (Months)
 Cause of Death Clinical
 Contributory Causes emphysema
 Certifying Physician Sam Jones (or Coroner)
 His Address _____
 Track } Remains to _____
 Ship }
 Size of Casket Colburn (State Color and Number)
 Manufactured by _____
 Cemetery } Chalkhead
 Cemetery }

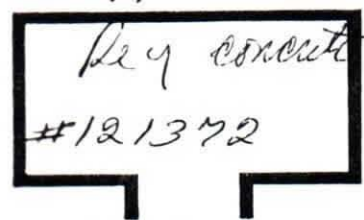

Diagram of Lot or Vault

Misc.
 Lot No.
 Grave No.
 Section No.
 Block No.
 Owner

Complete Funeral (except outlays) \$
 Casket
 Burial Vault or Box
 Embalming Body M. E. B. (State Kind) (Name of Embalmer)
 Misc.
 Dressing Body, \$ Underwear, \$
 Suit or Dress
WESLEY ALVIE WOODHAM
 Slippers, \$
 Folding Chairs NEWTON - Wesley Alvie Woodham, 76, of Rebecca Lane, Newton, died early Monday morning in a Dothan hospital following a lingering illness.
 Candelabrum, \$
 Door Spray, \$
 Funeral Car, \$
 Limousines to Funeral services were held at 4 p.m. Tuesday from Flower Car Chalkhead Baptist Church Autos to R.R. with the Rev. William Snellgrove, Rev. Fred Williams, Getting Remains and Rev. Wiley Sherfield of Taking Remains officiating. Interment followed Trip to Coron in the church cemetery with Misc. Holman Funeral Home direct- Removal Char ing.
 Procuring Buri Mr. Woodham was a native of Dale County, a member of Certif. (Chalkhead Church, and a retired farmer.
 Pall Bearer Ser He is survived by his wife, Gross Total fo Mrs. Oona P. Woodham of \$ Newton; three daughters, Mrs. Loretta Woodham of Newton, Mrs. Lillie Powers of Ozark, Mrs. Mavis Wright of Midland City; five sons, Douglas Woodham of Ozark, James Woodham of Dothan, J. C. Woodham of Enterprise, Tommy Woodham of Dothan, Luther Woodham of Panama City, Fla.; two sisters, Mrs. Malie Maund of Ozark and Mrs. Lillie Powers, also of Ozark; 20 grandchildren and several great grandchildren.
 Cremation
 Flowers, \$
 Rental of Ter Doris Akers of Anniston, Mrs. Mavis Wright of Midland City; five sons, Douglas Woodham of Ozark, James Woodham of Dothan, J. C. Woodham of Enterprise, Tommy Woodham of Dothan, Luther Woodham of Panama City, Fla.; two sisters, Mrs. Malie Maund of Ozark and Mrs. Lillie Powers, also of Ozark; 20 grandchildren and several great grandchildren.
 Opening of G
 Lining Grave
 Outlay for Sl
 Clergymen, \$
 Railroad } Woodham of Dothan, Luther or Truck } Woodham of Panama City, Telegr., Phon Fla.; two sisters, Mrs. Malie Maund of Ozark and Mrs. Lillie Powers, also of Ozark; Cash Advanc
 Out of town
 Personal Serv
 _____ line Death Notices in _____ Papers
 (Names of Newspapers)
 Sales Tax
 Totaling Footing of Bill \$
 Less \$
 Balance \$
 Entered into Ledger, page or below.

Misc.

*Filed
Sept. 28 1954
M.A.A.*

RECORD OF FUNERAL

Total No. Yearly No. 98 Date of Entry September 25, 1954

Name of Deceased William A. Woodham (What Race) White

Residence Midland City, Rt. 1 Husband Wife Widow Divorced } Josie Bennett
or of Age of Husband or Wife (if living) Year

Charge to

Address

Order given by Ben Woodham (or informant)

How Secured

If Veteran, Name of War

Occupation (Social Security Number)

Employer and Address

Date of Death Sept. 25 1954 (Mo.) (Day) (Yr.) (Hour)

Date of Birth 11 22 1876 Age 77 (Mo.) (Day) (Yr.) (Yrs.) (Mos.) (Days)

Services at Mt. Carmel

Clergyman Reverend C. O. York (Address)

Religion of the Deceased

Birthplace Dale Co. Ala.

Resided in the State (or U. S. or City or County) (Years) (Months)

Place of Death Home

Cause of Death

Contributory Causes

7/26 Certifying Physician Dr. Howell Coe (or Coroner)

His Address Midland City, Ala.

Name of Father Thomas Woodham

His Birthplace

Maiden Name of Mother Nellie Efinger

Her Birthplace

Date of Funeral Sept. 26 3:00 P.M. (Date) (Day of Week) (Hour)

Motor } Remains to
Ship }

Size of Casket (State Color and Number)

Manufactured by W. H.

Cemetery } Mt. Carmel
Crematory }

Lot No.

Grave No.

Section No.

Block No.
Owner

Miscellaneous

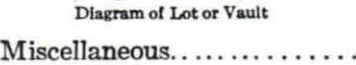

Complete Funeral (except outlays)	\$	
Casket		
Burial Vault or Box		
(State Kind)		
Embalming Body		
(Name of Embalmer)		
Barber, \$		
Hair Dressing, \$		
Dressing Body, \$		
Underwear, \$		
Suit or Dress		
(State Kind and Color)		
Slippers, \$		
Hose, \$		
Folding Chairs, \$		
Tarpaulin, \$		
Candelabrum, \$		
Candles, \$		
Door Spray, \$		
Gloves, \$		
Funeral Car, \$		
Ambulance, \$		
Limousines to Cemetery	@ \$	
Extra Limousines	@ \$	
Autos to R. R. Station	@ \$	
Getting Remains from		
Taking Remains to		
Trip to Coroner's Inquest		
Delivering Box to		
Deliver Flowers to		
Removal Charges		
Procuring Burial Permit		
(State Number and District)		
Certif. Copies of Death Certificates No.		
(State Physician's or Coroner's)		
Pall Bearer Service, \$		
Use of Chapel, \$		
Gross Total for Sales Tax	\$	
Outlay for Lot		
Cremation		
Flowers, \$		
Palms, \$		
Matting, \$		
Rental of Tent, \$		
of Temporary Vault, \$		
Opening of Grave or Tomb		
Lining Grave, \$		
Lowering Device, \$		
Outlay for Shipping Charges		
Clergyman, \$		
Singers, \$		
Organist, \$		
Railroad } Tickets, \$		
or Motor } Aero-plane Service, \$		
Telegr., Phone, Cable or Radio Charges		
Cash Advanced		
Out of town Funeral Director's Charges		
Personal Service		
line Death Notices in		
Papers		
(Name of Newspapers)		
Sales Tax		
Total Footing of Bill	\$	
Less	\$	
Balance	\$	
Entered into Ledger, page		
or below.		

RECORD OF FUNERAL

No. 42

Total No. 11 Yearly No. 95 Date of Entry JULY 16 1980

Name of Deceased WILLIAM DOUGLAS WOODHAM CAU
 Married Single Widowed Divorced (What Race)

Residence Rt. 2, Box 224, Newton, AL Husband Wife Widow of } LILLIAN LUCILLE KUTT
 Age of Husband or Wife (If living).....

Charge to MRS. LILLIAN WOODHAM

Address SAME AS ABOVE

Order given by WIFE
 (or informant)

How Secured

If Veteran, Name of War

Occupation

Employer and Address

Date of Birth NOV. 2, 1930 Age 49
 (Mo.) (Day) (Yr.) (Yrs.) (Mos.) (Days)

Birthplace MICHIGAN

Date of Death JULY 16, 1980
 (Mo.) (Day) (Yr.) (Hour)

Place of Death BROOKS ARMY MED. CTR. SAN ANTONIO, TX

Name of Father JESSE M. WOODHAM

His Birthplace

Maiden Name of Mother GLADYS E. MAXWELL

Her Birthplace

Date of Funeral JULY 19 SAT 3P. M.
 (Date) (Day of Week) (Hour)

Services at CHAPEL OF THE FLAGS

Clergyman CHAPLAIN GEORGE HATTLE
 (Address)

Religion of the Deceased

Resided in the State

Cause of Death

Contributory Causes

Certifying Physician

His Address

Truck } Remains to
 Ship }

Size of Casket SOLID OAK #31280
 (State Color and Number)

Manufactured by TACCOA

Cemetery } WOODLAWN
 Crematory }

WILBERT

Diagram of Lot or Vault

Lot No.
 Grave No.
 Section No.
 Block No.
 Owner

Misc.

Complete Funeral (except outlays)	\$
Casket	
Burial Vault or Box	
Embalming Body <u>INDIAN</u> (State Kind) (Name of Embalmer)	
Misc.	
Dressing Body, \$	Underwear, \$
Suit or Dress <u>FAMILY</u> (State Kind and Color)	
Slippers, \$	Hose, \$
Folding Chairs, \$	Tarpaulin, \$
Candelabrum, \$	Candles, \$
Door Spray, \$	Gloves, \$
Funeral Car, \$	Ambulance, \$
Limousines to Cemetery @ \$	William D. Woodham
Extra Limousines @ \$	NEWTON— William I
Flower Car @ \$	Woodham, 49, of Newto
Autos to R.R. or Air @ \$	died Wednesday mornin
Getting Remains from	in the Brooks Arn
Taking Remains to	Medical Center, San Ant
Trip to Coroner's Inquest	nio, Texas, following a bri
Misc.	illness.
Removal Charges	Funeral services we
Procuring Burial Permit	held at 3 p.m. Saturd.
..... Certif. Copies of Death Cert (State)	from the Chapel of tl
Pall Bearer Service, \$	Flags, Ft. Rucker wi
Gross Total for Sales Tax	Chaplain George Hatt
Outlay for Lot	officiating. Burial follow
Cremation	in the Woodlawn Memo
Flowers, \$	Gardens with full milita
Rental of Tent, \$	rites. Holman Funer
Opening of Grave or Tomb	Home directed.
Lining Grave, \$	Mr. Woodham w.
Outlay for Shipping Charges	retired from the U.S. Arm
Clergymen, \$	He is survived by h
Singers, \$	wife, Mrs. Lillian Loui
Railroad } Tickets, \$	A Woodham, of Newton; tw
or Truck }	daughters, Mrs. Lauri
Telegr., Phone, Cable or Radio Cha	Teeuwissen, Ann Arbo
Cash Advanced	Michigan and Mrs. Gol
Out of town Funeral Director's Ch	Lee Dykty, Newton; or
Personal Service	sister, Miss Mary Ar
..... line Death Notices in	Woodham, Glendale, Ca
(Names of Newspapers)	ifornia; two brothers, Ro
Sales Tax	ert Woodham, Glendal
Totaling Footing of Bill	California and Richa
Less	Woodham, Houston, Tex
Balance	four grandchildren al
Entered into Ledger, page	survive.
Misc.	

Date	Amount Paid	Balance	Date	Amount Paid

RECORD OF FUNERAL

Total No. 1589 Yearly No. 37 Date March 5 1940
 Name of Deceased W. E. Woodham (Single — Married — Divorced) W (What Race) W. Va. Co. (Where Born)
 Residence of Deceased Midland City Rt 1 Box 9 Husband—Wife—Widow—
 Charge to or of }

Address
 Order given by (or informant)
 How Secured
 Occupation of Deceased Farmer
 Name of Employer
 Address
 Date of Death March 12-1940 (Date) (Hour)
 Date of Birth June 15, 1880 (Date) (Hour)
 Age 59 8 17 (Years) (Months) (Days)
 Date of Funeral March 12-40 (Date) (Day of Week) (Hour) M.
 Services at W. Va. Co.
 Clergyman
 His Address
 Religion of the Deceased
 Resided in the State (or U. S. or City or County) (Years) (Months)
 Place of Death at home
 Cause of Death

Contributory Causes
 Certifying Physician Dr. Blynddr (or Coroner)
 His Address Osage, Va.
 Name of Father Wm Woodham
 His Birthplace W. Va. Co.
 Maiden Name of Mother Elin W. W. W.
 Her Birthplace W. Va. Co.
 Motor } Remains to
 Ship }
 Size and Style of Casket (State Color)
 Manufactured by
 Interment at W. Va. Co. { Cemetery
 Crematory



Lot No.
 Grave No.
 Section No.
 Owner

Complete Funeral	\$
Casket	
Outside Box	
Burial Vault	(State Kind)
Embalming Body	(State Kind)
Lady Attendant	(Name of Embalmer) <u>Sever</u>
Barber, \$ <u>2.00</u> Hair Dressing, \$	
Dressing Body, \$ Underwear, \$	
Suit or Dress \$ Slippers \$ Hose \$	
Folding Chairs, \$ Tarpaulin, \$	
Candelabrum, \$ Candles, \$	
Door Spray, \$ Gloves, \$	
Funeral Car, \$ Ambulance, \$	
Limousines to Cemetery @ \$	
Autos to R. R. Station @ \$	
Getting Remains from	
Taking Remains to	
Trip to Coroner's Inquest	
Delivering Box to	
Deliver Flowers to	
Removal Charges	
Procuring Burial Permit	
_____ Certif. Copies of Death Certificates No. _____	(State Number and District)
Pall Bearer Service, \$ Use of Chapel, \$	(State Physician's or Coroner's)
Personal Service	
Gross Total for Sales Tax	\$
Outlay for Lot	
Cremation	
..... line Death Notices in Papers	
Flowers, \$ Palms, \$ Matting, \$	(Names of Newspapers)
Rental of Tent, \$ of Temporary Vault, \$	
Opening of Grave or Tomb	
Lining Grave, \$ Lowering Device, \$	
Outlay for Shipping Charges	
Clergyman, \$ Singers, \$ Organist, \$	
Railroad } Tickets, \$ Aero- or Motor } plane Service, \$	
Telegr., Phone, Cable or Radio Charges	
Cash Advanced	
Out of town Undertaker's Charges	
Sales Tax	
Total Footing of Bill	\$
Less	\$
Balance	\$
Entered into Ledger, page or below.	

Date	Amount Paid	Balance	Date	Amount Paid	Balance

RECORD OF FUNERAL

Total No. _____ Yearly No. 165

Date of Entry Nov 3 Fri 1967

Name of Deceased Willie Lee

Woodham

(What Race)

Married Single Widowed Divorced

Husband Wife Widow }
or _____ of } Age of Husband or Wife (if living) _____ Years

Residence Rt 3 Ozark, Ala.

Charge to Syble D. Woodham

Address Rt 3 Ozark, Ala.

Order given by Syble D. Woodham
(or informant)

How secured _____

Veteran, Name of War WW2 + Korea

Occupation Ret Soldier 416-24-8613
(Social Security Number)

Employer and Address U.S. Army

Date of Death Nov. 3 Fri 1967
(Mo.) (Day) (Yr.) (Hour)

Date of Birth Jan 30 1923 Age 44
(Mo.) (Day) (Yr.) (Mos.) (Days)

Name of Father Burley Woodham

His Birthplace _____

Maternal Name of Mother Alma Skinner

Her Birthplace _____

Date of Funeral Nov. 5 Sun. 3 P. M.
(Date) (Day of Week) (Hour)

Services at Chalk Head Baptist Church

Clergyman Fred Williams & Wm Snellgrove
(Address)

Religion of the Deceased Baptist

Birthplace Dale Co. Ala.

Resided in the State Dale Co.
(or U.S. or City or County) (Years) (Months)

Place of Death Lyster Army Hospital

Cause of Death Myocardial infarction - 8da.

Contributory Causes arteriosclerosis

Certifying Physician _____
(or Coroner)

His Address _____

Motor Vehicle { Remains to _____
License {
Color of Casket 8750 Sil 1/2c
(State Color and Number)

Manufactured by _____

Cemetery { Chalk Head
Lot No. _____
Grave No. _____
Section No. _____
Block No. _____
Owner _____

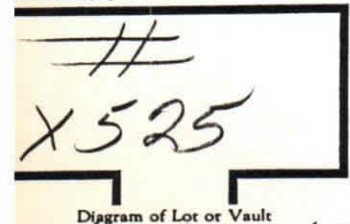

Filed 11-7-67 by Mrs Wells
Registers Div. Lyster Army Hospital
Ft Rucker, Ala.

Complete Funeral (except outlays)	\$	
Casket		
Burial Vault of Box		
Embalming Body <u>VCS</u> (State Kind) (Name of Embalmer)		
Barber, \$	Hair Dressing, \$	
Dressing Body, \$	Underwear,	
Suit or Dress		
Slippers, \$	Hose, \$	
Folding Chairs, \$	Tarpaulin,	
Candelabrum, \$	Candles,	
Door Spray, \$	Gloves, \$	
Funeral Car, \$	Ambulance,	
Limousines to Cemetery @ \$		
Extra Limousines @ \$		
Autos to R. R. Station @ \$		
Getting Remains from		
Taking Remains to		
Trip to Coroner's Inquest		
Delivering Box to		
Deliver Flowers to		
Removal Charges		
Procuring Burial Permit		
Certif. Copies of Death Ce (State Ph Use o		
Pall Bearer Service, \$		
Gross Total for Sales Tax		
Outlay for Lot		
Cremation		
Flowers, \$ Palms, \$ Mr		
Rental of Tent, \$ of Temp		
Opening of Grave or Tomb		
Lining Grave, \$ Lower		
Outlay for Shipping Charges		
Clergymen, \$ Singers, \$ Organist, \$		
Railroad or Motor { Tickets, \$ Aero-plane Service, \$		
Telegr., Phone, Cable or Radio Charges		
Cash Advanced		
Out of town Funeral Director's Charges		
Personal Service		
_____ line Death Notices in _____ Papers		
(Names of Newspapers) <u>Flag form given, P.O. & flag received</u>		
Sales Tax		
Total Footing of Bill	\$	
Less	\$	
Balance	\$	
Entered into Ledger, page _____ or below.		
Misc. <u>United Security Burial Ins. Co.</u>		

WILLIE LEE WOODHAM
 OZARK — Willie Lee Woodham, 44, died in Lyster Army Hospital at Ft. Rucker Friday night following a short illness. Mr. Woodham, a native of Dale County was a member of Chalk Head Baptist Church and was retired from the Army. Funeral services were held at 3:00 Sunday afternoon at Chalk Head Baptist Church with Rev. Fred Williams and Rev. William Snellgrove officiating. Interment in the church cemetery with military honors at the grave, Holman Funeral Home directing. Survivors are his wife, Mrs. Syble Deese Woodham, Ozark, Rt. 3; one daughter, Mrs. Judy Bowman, Ozark; one son, Floyd Lee Woodham, Ozark Rt. 3; his mother, Mrs. Alma Watkins, Dothan; two sisters, Mrs. Frances Shea, Detroit, Mich., Mrs. Flowers Riley, Dothan; two brothers, John T. Woodham, Phenix City, Robert Woodham, Wicksburg.

RECORD OF FUNERAL

Total No. Yearly No. 187 Date of Entry Oct. 31 1977

Name of Deceased William R. Woodham (What Race) W

Married Single Widowed Divorced
Residence Midland City Husband Wife Widow }
or of } Age of Husband or Wife (if living)

Charge to Annie Woodham wife

Address same

Order given by wife (or informant)

How secured

If Veteran, Name of War W.W.I

Occupation 417-70-819501 (Social Security Number)

Employer and Address

Date of Death Oct 31 1977 (Mo.) (Day) (Yr.) (Hour)

Date of Birth 11-19-1894 Age 76 (Mo.) (Day) (Yr.) (Yrs.) (Mos.) (Days)

Name of Father Lancel Woodham

His Birthplace

Maiden Name of Mother Martha Enginger

Her Birthplace

Date of Funeral Nov 2 (Date) (Day of Week) (Hour) 2 M.

Services at Corinth Baptist Church

Clergyman W.H. Waters (Address)

Religion of the Deceased

Birthplace Dale Co. Ala

Resided in the State Ala (or U.S. or City or County) (Years) (Months)

Place of Death VA Hosp - Tuskegee, Ala

Cause of Death

Contributory Causes

Certifying Physician

His Address

Motor } Remains to

Ship } Size of Casket 75x17 (State Color and Number)

Manufactured by

Cemetery } Corinth

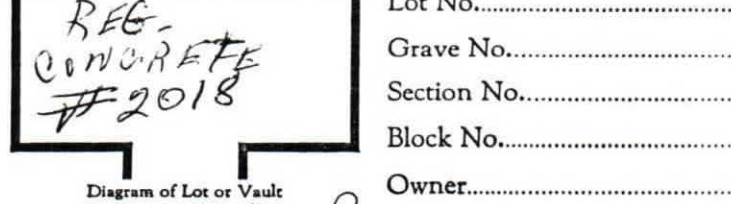

Misc. Angela Reeves

11-8-71

Complete Funeral (except outlays).....	\$
Casket.....	
Burial Vault or Box.....	
Embalming Body..... (State Kind) (Name of Embalmer)	
Barber, \$..... Hair Dressing, \$.....	
Dressing Body, \$..... Underwear, \$.....	
Suit or Dress..... (State Kind and Color)	
Slippers, \$..... Hose, \$.....	
Folding Chairs, \$..... Tarpaulin, \$.....	
Candelabrum, \$..... Candles, \$.....	
Door Spray, \$..... Gloves, \$.....	
Funeral Car, \$..... Ambulance, \$.....	
Limousines to Cemetery..... @ \$.....	
Extra Limousines..... @ \$.....	
Autos to R. R. Station..... @ \$.....	
Getting Remains from.....	
Taking Remains to.....	
Trip to Coroner's Inquest.....	
Delivering Box to.....	
Deliver Flowers to.....	
Removal Charges.....	
Procuring Burial Permit.....	
..... Certif	District) No. oroner's)
Pall Bearer WILL R. WOODHAM	
Gross Tot MIDLAND CITY - Will R. Woodham, 76, died early Sunday morning in the Veterans Hospital at Tuskegee following a long illness.	\$
Outlay for Funeral services were held at 2 p.m. Tuesday from the Corinth Baptist Church with Rev. W. H. Waters officiating. Interment followed in the church cemetery with Holman Funeral Home of Ozark directing.	
Flowers, \$ Mr. Woodham was a veteran of World War II.	
Rental of He is survived by his wife, Mrs. Annie W. Woodham of Midland City.	
Opening c line Death Notices in..... Papers.	
Lining Gr: (Names of Newspapers)	
Outlay for Sales Tax.....	
Clergymer Total Footing of Bill..... \$	
Railroad } Less..... \$	
or Motor } Balance..... \$	
Telegr., Pl Entered into Ledger, page..... or below.	
Cash Adv Misc.....	
Out of tow 	
Personal \$ 	

Subd

RECORD OF FUNERAL



Total No. 5781 Yearly No. 43 Date of Entry March 22 1944
 Name of Deceased Zina Cain Woodham
 Married Single Widowed Divorced
 Residence: Ozark, Pa. 4 Husband Wife Widow C.M. Woodham (What Race) W.
 or of } Age of Husband or Wife (if living) 65 Year

Charge to:
 Address:
 Order given by C.M. Woodham
 (or informant)
 How Secured:
 If Veteran, State War
 Occupation Housewife (Social Security Number)
 Employer and Address
 Date of Death March 22, 1946 9:30 P.M.
 (Date) (Hour)
 Date of Birth Sept 8, 1883
 (Years) (Months) (Days)
 Age 63
 Date of Funeral March 24, 1946 3:00 P.M.
 (Date) (Day of Week) (Hour)
 Services at: Emell M.E. Church
 Clergyman: (Address)
 Religion of the Deceased
 Birthplace Dale County, Ala.
 Resided in the State Ala.
 (or U. S. or City or County) (Years) (Months)
 Place of Death Moody Hospital, Latham, Ala.
 Cause of Death Leukemia
 Contributory Causes
 Certifying Physician Dr. Moody
 (or Coroner)
 His Address Dallas, Ala.
 Name of Father D.S. Cain
 His Birthplace Dale County, Ala.
 Maiden Name of Mother Armonda Smell
 Her Birthplace Dale County, Ala.
 Motor } Remains to
 Ship }

Complete Funeral (except outlays).....	\$
Casket.....	
Burial Vault or Box.....	(State Kind)
Embalming Body.....	(Name of Embalmer)
Barber, \$.....	Hair Dressing, \$.....
Dressing Body, \$.....	Underwear, \$.....
Suit or Dress.....	(State Kind and Color)
Slippers, \$.....	Hose, \$.....
Folding Chairs, \$.....	Tarpaulin, \$.....
Candelabrum, \$.....	Candles, \$.....
Door Spray, \$.....	Gloves, \$.....
Funeral Car, \$.....	Ambulance, \$.....
Limousines to Cemetery.....	@ \$.....
Extra Limousines.....	@ \$.....
Autos to R. R. Station.....	@ \$.....
Getting Remains from.....	
Taking Remains to.....	
Trip to Coroner's Inquest.....	
Delivering Box to.....	
Deliver Flowers to.....	
Removal Charges.....	
Procuring Burial Permit.....	(State Number and District)
Certif. Copies of Death Certificates No.....	(State Physician's or Coroner's)
Pall Bearer Service, \$.....	Use of Chapel, \$.....
Gross Total for Sales Tax.....	\$
Outlay for Lot.....	
Cremation.....	
Flowers, \$.....	Palms, \$.....
Matting, \$.....	Rental of Tent, \$.....
of Temporary Vault, \$.....	Opening of Grave or Tomb.....
Lining Grave, \$.....	Lowering Device, \$.....
Outlay for Shipping Charges.....	Clergyman, \$.....
Singers, \$.....	Organist, \$.....
Railroad } Tickets, \$.....	Aero-plane Service, \$.....
or Motor }	
Telegr., Phone, Cable or Radio Charges.....	
Cash Advanced.....	
Out of town Undertaker's Charges.....	
Personal Service.....	
..... line Death Notices in.....	Papers.....
(Names of Newspapers)	
Sales Tax.....	
Total Footing of Bill.....	\$
Less.....	\$
Balance.....	\$
Entered into Ledger, page.....	or below.

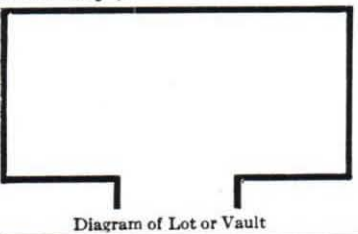

Lot No.
 Grave No.
 Section No.
 Block No.
 Owner

Date	Amount Paid	Balance	Date	Amount Paid	Balance

RECORD OF FUNERAL

Total No. Yearly No. 157 Date of Entry Nov. 17, (Sun.) 1957
 Name of Deceased Zimmerman & Woodham White
 Married Single Widowed Divorced (What Race)
 Residence Midland City, Ala. Rt. 1 Husband Wife Widow }
 or of Age of Husband or Wife (if living)

Charge to
 Address
 Order given by Mrs. Fletcher Sewell
 (or informant)
 How Secured
 If Veteran, Name of War no
 Occupation Farmer no
 (Social Security Number)
 Employer and Address Self
 Date of Death Nov 17, Sun. 1957
 (Mo.) (Day) (Yr.) (Hour)
 Date of Birth May 20, 1884 Age 73
 (Mo.) (Day) (Yr.) (Mos.) (Days)
 Services at Echo Methodist Church
 Clergyman Rev. Roy Thomas
 (Address)
 Religion of the Deceased Methodist
 Birthplace Dale Co. Alabama
 Resided in the State Dale Co. 73
 (or U. S. or City or County) (Years) (Months)
 Place of Death Midland City, Ala. Rt. 1
 Cause of Death

Contributory Causes
 Certifying Physician M. J. E. Morris
 (or Coroner)
 His Address Headland, Alabama
 Name of Father Woodham
 His Birthplace
 Maiden Name of Mother Liza Deal
 Her Birthplace
 Date of Funeral Nov. 19, TUE 2 P. M.
 (Date) (Day of Week) (Hour)
 Motor } Remains to
 Ship }
 Size of Casket Wallace Sealr Bronze & Copper
 (State Color and Number)

Manufactured by
 Cemetery } Echo
 Crematory }

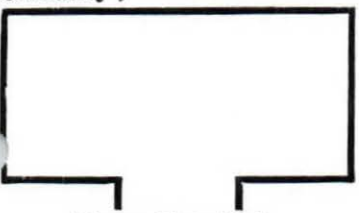

Lot No.
 Grave No.
 Section No.
 Block No.
 Owner

Miscellaneous 14 above Carney 17-3-27

Complete Funeral (except outlays)	\$
Casket	
Burial Vault or Box	
Embalming Body	
(State Kind)	
(Name of Embalmer)	
Barber, \$	
Hair Dressing, \$	
Dressing Body, \$	
Underwear, \$	
Suit or Dress	
(State Kind and Color)	
Slippers, \$	
Hose, \$	
Folding Chairs, \$	
Tarpaulin, \$	
Candelabrum, \$	
Candles, \$	
Door Spray, \$	
Gloves, \$	
Funeral Car, \$	
Ambulance, \$	
Limousines to Cemetery	@ \$
Extra Limousines	@ \$
Autos to R. R. Station	@ \$
Getting Remains from	
Taking Remains to	
Trip to Coroner's Inquest	
Delivering Box to	
Deliver Flowers to	
Removal Charges	
Procuring Burial Permit	
(State Number and District)	
— Certif. Copies of Death Certificates No.	
(State Physician's or Coroner's)	
Pall Bearer Service, \$	
Use of Chapel, \$	
Gross Total for Sales Tax	\$
Outlay for Lot	
Cremation	
Flowers, \$	
Palms, \$	
Matting, \$	
Rental of Tent, \$	
of Temporary Vault, \$	
Opening of Grave or Tomb	
Lining Grave, \$	
Lowering Device, \$	
Outlay for Shipping Charges	
Clergyman, \$	
Singers, \$	
Organist, \$	
Railroad } Tickets, \$	
or Motor } Aero-	
plane Service, \$	
Telegr., Phone, Cable or Radio Charges	
Cash Advanced	
Out of town Funeral Director's Charges	
Personal Service	
..... line Death Notices in	
Papers	
(Name of Newspapers)	
Sales Tax	
Total Footing of Bill	\$
Less	\$
Balance	\$
Entered into Ledger, page	or below.
Miscellaneous	

RECORD OF FUNERAL

Total No. 1 Yearly No. _____ Date June 13 1930

Name of Deceased Auzillie Ward (What Race) White (Where Born) Henry

Widow } Thomas Ward
 Daughter of }

Charge to W. R. Wiggins

Address Newnesee

Order Given by same

How Secured _____

Date of Funeral 6/13/30

Residence Newnesee

Place of Death Home

Funeral Services at Echo Cemetery

Time of Funeral Service 10 A.M.

Clergyman Josh Lescuyer + W. O. Jones

His Address Ozark + Newnesee

Certifying Physician H. L. Holman

His Residence Ozark

Cause of Death _____
 (Primary)

Cause of Death _____
 (Secondary)

Date of Death _____

Occupation of the Deceased Retired

Employed _____

Single or Married Married Religion _____

Date of Birth _____

Age 80 Years _____ Months _____ Days _____

Name of Father Jim Galloway

His Birthplace A. O.

Name of Mother Betsie Workton
 (Maiden Name)

Her Birthplace A. O.

Body to be Shipped to _____

Size and Style of Casket _____

Manufactured by _____

Interment at _____ Cemetery

Lot No. _____

Grave No. _____

Section No. _____

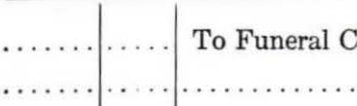

Diagram of Lot or Vault

Casket.....	16.0
Metallic Lining.....	
Outside Box.....	(State Kind)
Grave Vault.....	(State Kind) <u>Marley</u> 6.5
Suit or Dress, \$.....	Hose, \$..... Slippers, \$.....
Embalming Body (with <u>Chomp</u> Fluid)	2.5
Dressing Body, \$.....	Hair Dressing, \$.....
Folding Chairs.....	
Candelabrum, \$.....	Candles, \$.....
Door Badge, \$.....	Gloves, \$.....
Hearse.....	
Auto Limousines to Cemetery @ \$.....	
Autos to R. R. Station..... @ \$.....	
Aeroplane Service.....	
Getting Remains from.....	
Taking Body to Inquest.....	
Delivering Box to.....	
Delivering Remains to.....	
Death Notices in.....	Newspapers
	(Names of Newspapers)
Flowers.....	
Rental of Plants, \$.....	Tent Rental, \$.....
Outlay for Lot.....	
Opening Grave Vault, \$.....	
Lining Grave, \$.....	Matting, \$.....
Lowering Device, \$.....	Rental of Vault.....
Outlay for Shipping Charges.....	
Removal Charges, \$.....	Incineration, \$.....
Getting Burial Permit.....	
Certified Copies of Death Certificate.....	
Personal Charges, \$.....	Singers, \$.....
Church Charges, \$.....	Ministers, \$.....
Pall Bearer Service.....	
Telegr., Telephone, Cable or Radio Charges.....	
Railroad Tickets.....	
Cash Advanced.....	

Total Footing of Bill.....	\$ 250
By Amount Paid in Advance.....	\$
Balance.....	\$
Entered into Ledger, page.....	or below

To Funeral Charges..... Total, \$	By Cash..... \$
<u>250</u>	

Cobb Funeral Home

Burial Records

Ozark, Alabama

Cobb Funeral Home was later absorbed by Holman Funeral Home of Ozark. The Cobb Funeral Home records are now owned by Holman Funeral Home.

WOODHAM,

Sam E. born Dec 1839, died 16 Aug 1928
Husband of Media Powers. Burial: Sylvan Grove

WOODHAM,

Plensy born 31 Oct 1909, died 26 Mar 1929
Son of Gilliam & Anne Peacock Woodham. Burial: Mt. Carmel

WOODHAM,

Inf. of Herman born 29 Jan 1930, died 1 Feb 1930
Infant child of Herman Woodham. Burial Chalkhead

WOODHAM,

Gillman D. born 7 Apr 1856, died 17 Apr 1931
Husband of Annie Peacock. Burial: Mt. Carmel

WOODHAM,

Mary Grantham born 29 July 1881, died 16 Nov 1931
Wife of Walt Woodham. Burial: Corinth

Woodham Funeral Records

Ward-Wilson Funeral Home

Dothan, Alabama

Compiled by

Robert Earl Woodham

Woodham Family Historian

Founder & President,

Woodham Family Association

FUNERAL RECORDS

Ward - Wilson FUNERAL Home

FUNERAL

DOTHAN, ALABAMA

Woodham

Addie B. Andrews	age 90	23 Jan 1985	(85025)
Alice GARY	Midland City	10 Apr 1961	-
Clma Clements	72 Dothan	25 Sept 1974	-
Mrs. B. M.		14 Sept 1941	-
(Mrs. Beady Morgan Woodham; Lillie Mae Warwick)			
B M	56	20 Jan 1944	1944
Dothan City Cemetery born 10-10- 18 Dale Co.			
fa E. H. SEVIVE Woodham			
informant: Betty Jean Woodham			
Barney LEE	80	8 Oct 1986	86283
Billy Ray	37	19 Mar 1987	87099
Quincy Fla			
Billy Ray and Nellie Fay		29 July 1944	1944
Pilgrim Rest Church			
Bruce Allen	15	25 Nov. 1980	
C. Bill Clark	64	12 Nov. 1971	

C C 60 2 Jan 1944 104

Ashford Ga
born 7 Aug 1883 Dale Co
Fa W. A. Woodham
Mo. MARY Newton (Chatham Cramer)
bur Hartford Cemetery

C L 67 25 June 1944

Dathan, Rt 1
born 26 June 1877 Dale Co
Moses Woodham
Elizabeth Peacock (Charles Lafayette)
bur Bay Springs Church

Mrs Cassie Donnie 55 15 Jan 1960

Dathan RT 3
born 15 July 1904 Dale Co
Henry Galloway
Lucy Riley
bur Mt. Ararat
[MRS. Robert ("Bob") Woodham]

Charity Ward 86 4 Oct 1984 84250
Cottonwood

Charles Edward 40 28 May 1974
Mid City

WARD - WILSON FUNERAL HOME
DOTHAN, ALA

Charley Joe 16 May 1954
116 Bayley St, Dothan
[Joseph Charles]

MRS. D. E 22 Jan 1949
Rt 5 Dothan

Mrs. Effie J. 22 Mar 1949
Chipley Fla
[Mrs. Walter Young Woodham]

Mrs. Eliza Jane 78 30 May 1965
Rt 1 Dothan
[

Euel 6 Aug. 1947
Dothan Rt 1

Eva Mae 26 Nov. 1962
Dothan, Enterprise Rd
[Mrs. William Terrell Woodham]

Fannie Merle 77 2 Sept 1985 85246
Dothan
[Mrs. William Manure (Woodham)]

Mrs Flora Mae #2 @ 9 Jan 1960

Rt 3 Dathan

-

boin Geneva Co

Joy Newsome

Zella McCrone

bor. Mt. AIRA + ^{paper} Cemt

Ferd John 60

7 Feb 1969

Dathan Rt 5

GASTON LEE

29 June 1955

Dathan Rt 4

Hazel Vines

67

8 Nov. 1975

Dathan

[MRS. BARNEY LEE WOODHAM]

Hiram Dillon

403 E. Selma St

31 Dec. 1954

Haze (infant)

8 Dec 1961

Dathan Rt 5

Irby Crawford

61

6 Dec. 1974

Slacomb

Ward - Wilson FUNERAL HOME

DOTHAN, ALA

Woodham

Mrs. J. E 90 6 June 1944
309 1/2 S. Oates
home of son born 11 Apr 1854 Dale Co
fr Ewin White - ?
Francis Ward - ?
Mem Kinsey Baptist Church

James Davis 58 9 Oct 1975
Dothan

Mrs. James E 6 May 1952
Dothan

James Myzell 73 19 Oct 1985 85306
Dothan

James Reynolds 52 20 Feb 1974
Doth

~~John~~

JOAN Shelley 42
Dathan

12 Sept 1979

John Edward 86
Dathan Rt 4

20 Jan 1938
at home

1938

born: 11 June 1852 Dale Co
fa Rodney Woodham - Ala.
mo Covis Woodham - Ala

informant W. T. Woodham
bur Kinsey (~~Baptist Church~~) Cemetery
21 Jan 38

John Franklin
Midland City Rt 1

7 Apr 1964

J. Glenn 42

26 Sept 1960
at home

Rt 4 Dathan

born
died ~~born~~ 26 Sept 1960 Geneva Co

Charlie Woodham

Jane Hall

informant: Mrs. Margaret Woodham (widow)

bur Bay Springs Bapt Cemt.

27 Sept

WARD - WILSON FUNERAL HOME

DOTHAN, ALA

John Henry 61 23 Dec 1974
Dathan

John Thomas 82 17 May 1981
Rt 1 Webb

Johnathan Gregory 14 Apr 1956
410 POGNER ST Dathan

Karry LEE 16 Nov 1957
302 2nd Ave. Dathan

LILLIE MAE Holloway 52 18 Apr 1968
Dathan
[Mrs. Chester Wesley Woodham]

Mrs Lucy E 21 Aug 1947
Dathan Rt 9
[Mrs. Johnathan Frederick Woodham]

Mrs. Maggie 46 21 Apr 1940
Rt 1 Dathan
born 16 Mar 1894 Ala
W. W. Woodham Husband
fa Noah Hall Ala
Liza Hinson Ala
Bva Bethlehem Baptist Church Cemt

Mark Anthony age 0 21 Apr 1960
409 Popper St

Born 21 Aug. 1960 Houston Co
fr S. J. Woodham
LAURALENE Hodges
Memory Hill Cemetery

Mrs. Mary 16 Nov. 1932 DTR Record
Dothan Book
(Mrs. Thomas J.)

Mrs. Mattie Murdock 80 26 Aug 1969
Houston Co.
born Houston Co

Mattie W. 78 11 Nov. 1973
Midland City Rt 2
[Mrs. William Harvey Woodham]

N. J. "Jake" 60 25 May 1970
Dothan

Nora Fuller 98 22 Apr 1979
Dothan

Oleg L. 63 16 May 1981
Ashford Rt 3

WARD - WILSON FUNERAL HOME

DOTHAN, ALA

Mrs Pearl 14 Aug 1950
Ashford Rt 2

Mrs Penetta B 74 23 Feb 1960

Rt 3 Dothan

born 17 May 1885 Dale Co

Eliza Bolton

MARY MERCER

inf. Mrs C. M. VARNUM (Dau)

bur Memphis Baptist Cemetery

Randall E. 28 May 1955
Spring Hill, Ala

Mrs. Ruby 28 May 1955
Spring Hill, Ala

Sallie Mae Roney 74 19 Feb. 1981
Dothan

Samantha Vann 71 22 June 1979
Dothan

Samuel Bassett
Cottonwood

18 Mar 1955

Shirley Ann
Dathan Rt 5

6 Feb 1954

Walter Young
Bonifay, Fla, Rt 3

21 Jan 1950

Wiley E
Headland Rt 1

24 Nov. 1946

William ANDER 72
Dathan Rt 3

14 Aug 1982

William HARVEY
Headland Rt 1

31 Oct 1964

William Henry
Dathan

69

26 Oct 1976

William Terrill 77
Cennelon Dr. Dathan

4 June 1960
at home

Born 1 June 1883 Henry Co

John Woodham

par. Kinsley Cemetery

Sarah Ann White

ind Mrs B. H. Clark (Daughter)

WARD - WILSON FUNERAL HOME

DOTHAN, ALA

William Washington
ret / Dothan

9 Sept 1965

Willie Mae Marshall 85 19 Oct. 1985 \$53.67
Midland City ret 1

Condolence cards sent by Arthur Joe Hooten and Farmer Hooten, Jr.,
sons of Mollie Woodham and Farmer Hooten Sr.

to

Mrs. Clara Woodham, wife of Lon Woodham

upon the death in 1980 of

Lon Woodham

In Loving Memory

Arthur Joe & Farmer Jr.

In Loving Memory

Arthur Joe & Farmer Jr.
Melister, Fl.

RJD

Hester

COLUMBUS, GEORGIA
RIVERDALE CEMETERY

BURIAL PER NO. 1282

Name Woodham, Flora T. Sex F
Date of Interment 8-10-1973 Lot 29 Sec. 42
Cause of Death Terminal broncho pneumonia Place of Death Col. Ga
Place of Birth Ala. Date of Birth 10-24-1895
Age 77 Vault _____ Undertaker ~~Striffler Hamby~~ Vance
Mother ^D_K Father _____
Remarks: Died 8-9-1973 Sexton Brookins

COLUMBUS, GEORGIA
RIVERDALE CEMETERY

BURIAL PER NO. 4881

Name Woodham, Joan Y. Sex _____
Date of Interment 4-23-1984 Lot W-1 Sec. 9
Cause of Death _____ Place of Death Cobb Hosp.
Place of Birth _____ Date of Birth _____
Age 56 Vault L+L Undertaker Vance
Mother _____ Father _____
Remarks: died 4-21-1984 Sexton Brantley